

11,871 SF

Industrial Space For Lease



Prologis Schiller Park



9817 W. Foster Avenue
Schiller Park, IL 60176 USA

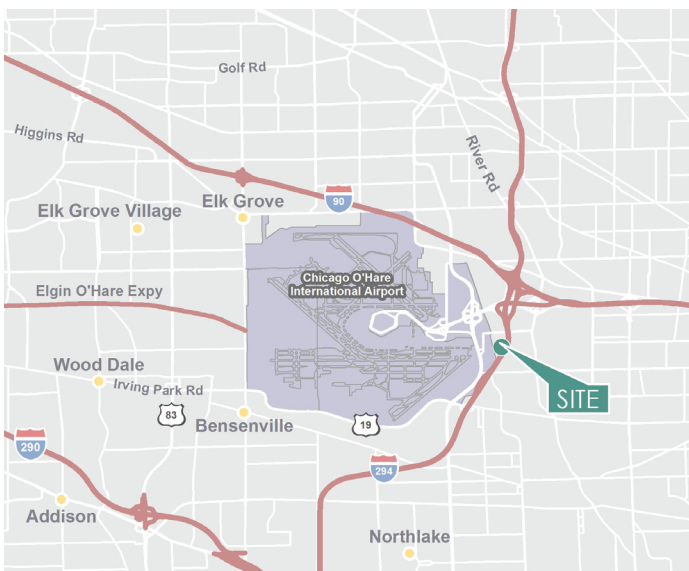

LOCATION

- 5 minutes to O'Hare International Airport
- Excellent access to I-294, I-90, I-290 and I-390
- Next to new northbound 294 Balmoral exit & southbound entrance

FACILITY

- 23,688 sf building
- 11,871 sf available
- 3,775 sf office area (can be reduced)
- 31' x 41' bay size
- 1 interior dock with leveler
- 1 drive-in door
- 18' clear height
- 24 car parking stalls
- 400 amp service

ADVANTAGES AND AMENITIES

- New T5 lighting
- Walking distance to hotels and entertainment

Your single-source service for efficient move-in and operations: prologisessentials.com

11,871 SF

Industrial Space For Lease



Prologis Schiller Park

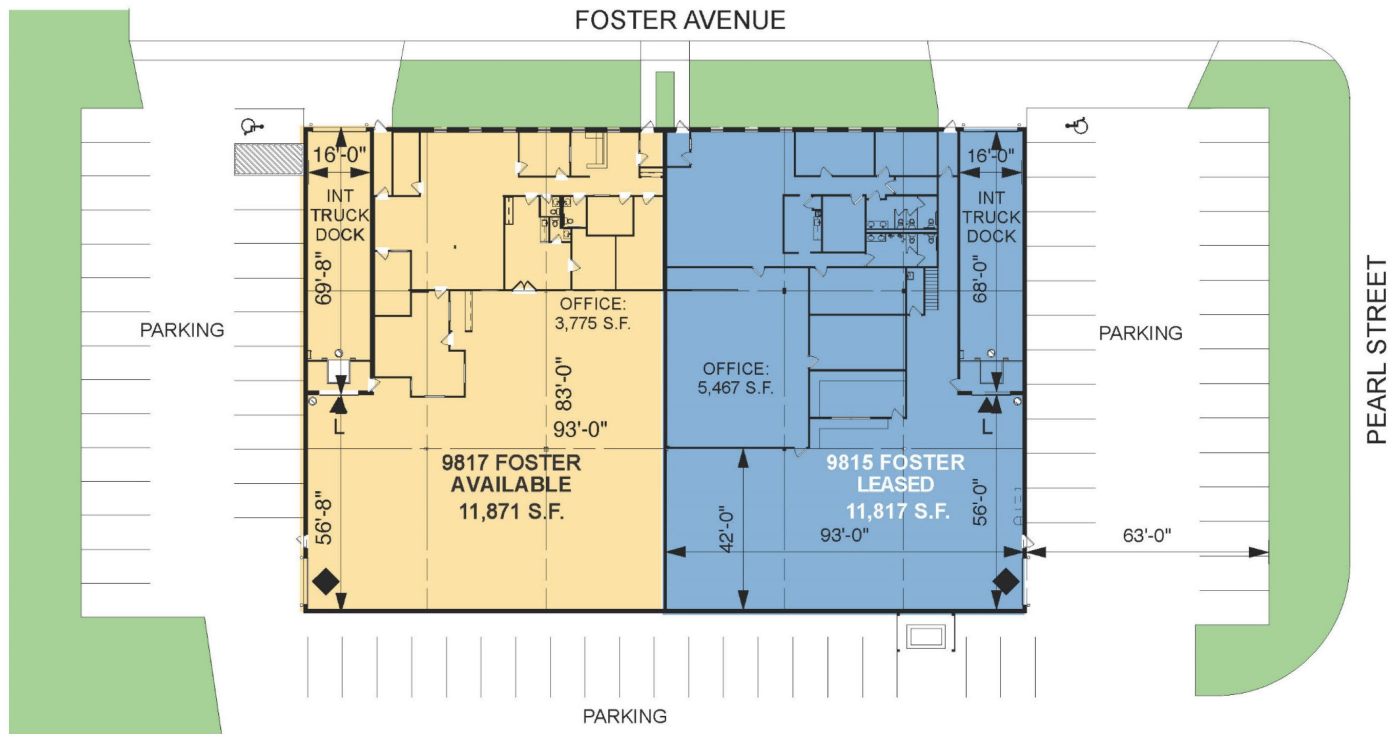

NEWMARK

Newmark

Tom Gath
thomas.gath@nmrk.com
ph +1 773 957 1415
cell +1 847 942 9438
8750 W. Bryn Mawr
Suite 350
Chicago, IL 60631 USA

Prologis

Ana Rovito
arovito@prologis.com
ph +1 847 292 3850
cell +1 312 420 4426
6250 North River Road
Suite 1100
Rosemont, IL 60018 USA