

# 38,184 SF

Industrial Space For Lease



## Prologis Pecos Distribution Center



5330 Pecos Street  
Denver, CO 80221 USA



### LOCATION

- Strategic Central Denver location
- Excellent access to I-25, I-70, I-76, I-270 and US 36
- Denver address with Unincorporated Adams County location provides low 4.75% sales tax and significant savings

### ADVANTAGES AND AMENITIES

- Access to the Prologis Essentials Platform, which includes:
  - [Operations Essentials](#)
  - [Energy & Sustainability Essentials](#)
  - [Mobility Essentials](#)
  - [Workforce Essentials](#)

**Your single-source service for efficient move-in and operations: [prologisessentials.com](https://www.prologisessentials.com)**

# 38,184 SF



Industrial Space For Lease

## Prologis Pecos Distribution Center

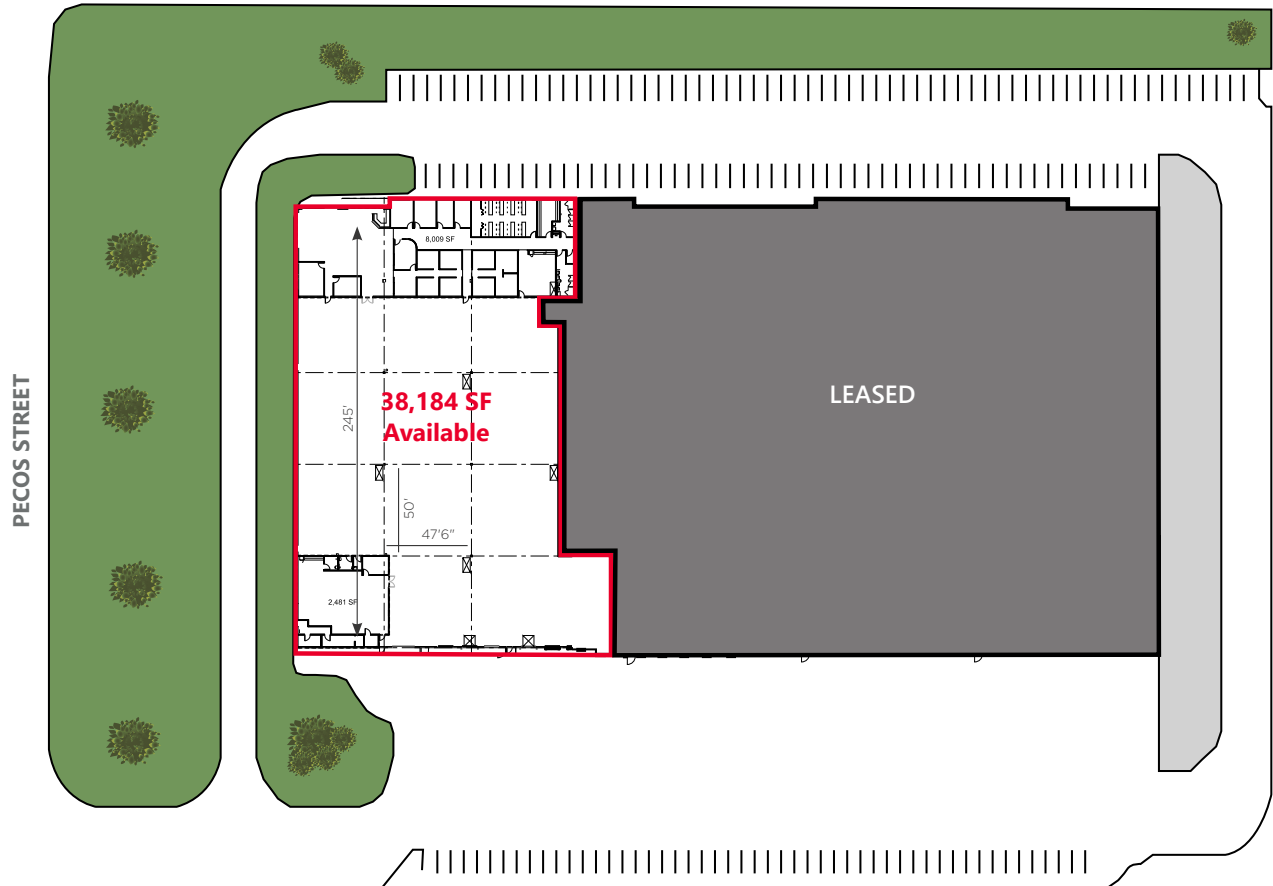

### FACILITY

- Available ±38,184 SF
- ±10,490 SF Total office finish (8,009 SF front entrance and 2,481 SF in loading area)
- Front-park/rear-load configuration
- Seven (7) Dock high doors (3 with levelers)
- One (1) 12' x 14' Drive-in door
- 24' Clear height
- ESFR Sprinklers
- 47'6" x 50' Column spacing
- Parking Ratio 1.07 : 1,000
- Prologis Clear Lease 2024 OpEx \$5.46/SF
- Contact brokers for lease rate



**Steve Hager**  
Executive Director  
steve.hager@cushwake.com  
ph +1 303 813 6446  
1401 Lawrence Street  
Suite 1100  
Denver, CO 80202

**Matt Trone, SIOR**  
Executive Director  
matt.trone@cushwake.com  
ph +1 303 619 9487  
1401 Lawrence Street  
Suite 1100  
Denver, CO 80202

**Joey Trinkle**  
Director  
joey.trinkle@cushwake.com  
ph +1 303 312 4249  
1401 Lawrence Street  
Suite 1100  
Denver, CO 80202

**Keiffer Garton**  
VP, Market Officer  
kgarton@prologis.com  
ph +1 303 567 5193  
1800 Wazee Street  
Suite 500  
Denver, CO 80202 USA