

25,767 SF

Industrial Space For Lease



Prologis Park Sumner 25



13630 52nd Street E, Ste 200
Sumner, WA 98390 USA

LOCATION

- Easy access to I-5, SR 167 and SR 18

FACILITY

- 25,767 SF total
- 2,516 SF office
- 4 dock high doors
- 1 drive in door
- 33 auto parking
- 26' clear height
- New LED lighting

ADVANTAGES AND AMENITIES

- Access to the Prologis Essentials platform, which includes:
 - [Operations Essentials](#)
 - [Energy Essentials](#)
 - [Workforce Essentials](#)
 - [Mobility Essentials](#)
 - [Digital Essentials](#)

Your single-source service for efficient move-in and operations: [prologisessentials.com](https://www.prologisessentials.com)

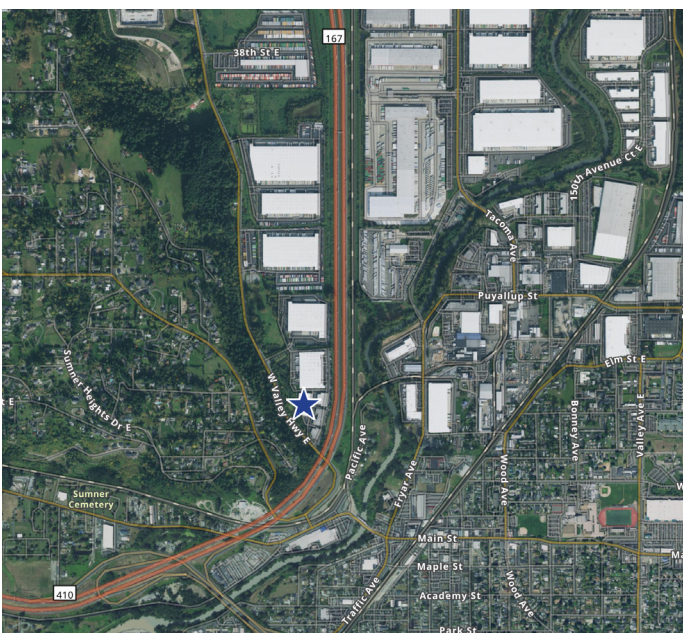

25,767 SF

Industrial Space For Lease



Prologis Park Sumner 25

Floor Plan

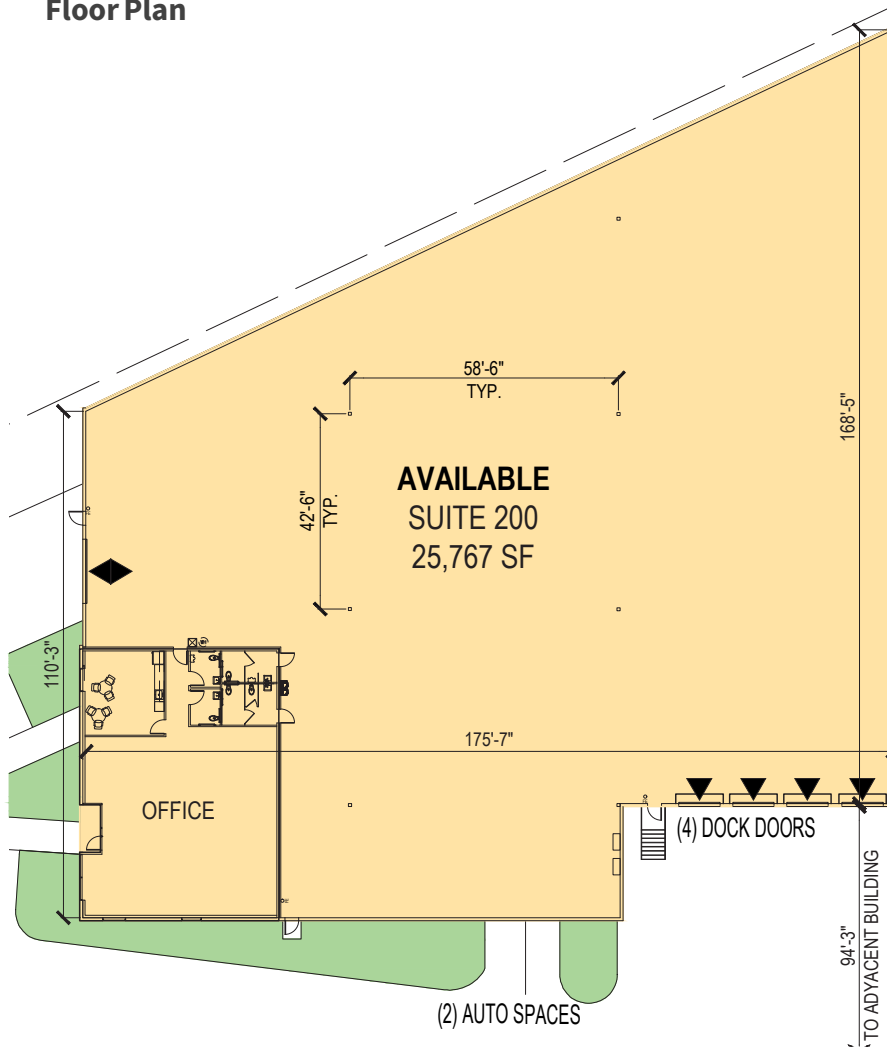

Office Plan

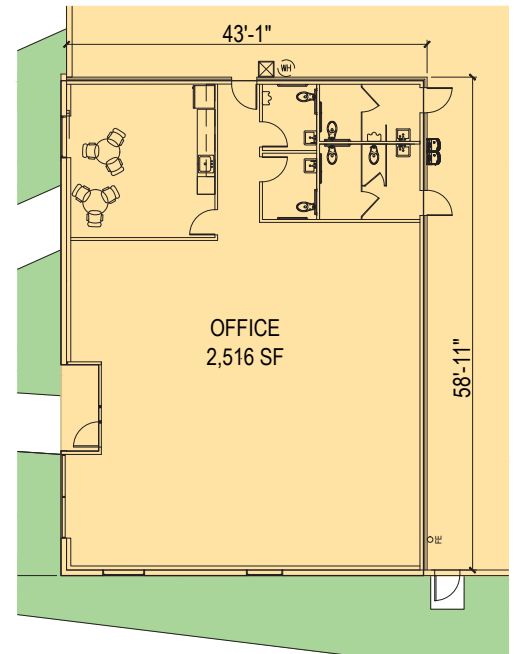

Colliers

Matt McGregor

Matt.McGregor@Colliers.com
ph +1 206 624 7401
601 Union Street
Suite 5300
Seattle, WA 98101 USA

Bill Condon

Bill.Condon@Colliers.com
ph +1 206 235 9732
601 Union Street
Suite 5300
Seattle, WA 98101 USA

Prologis

Mark Roddy

MRoddy@prologis.com
ph +1 206 414 7617
cell +1 253 514 0299
33930 Weyerhaeuser Way S,
Ste. 100
Federal Way, WA 98001 USA