

# 10,229 - 21,128 SF

Industrial Space For Lease

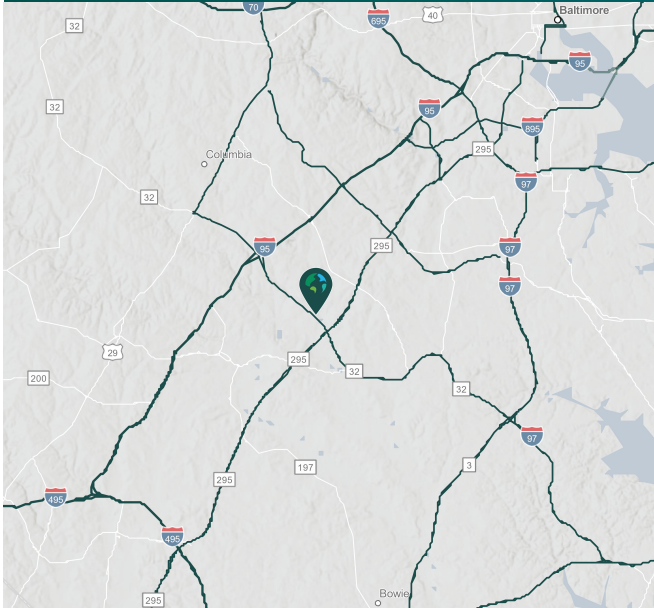

## Prologis Corridor Park 17



12011 Guilford Road  
Annapolis-Junction, MD 21076 USA



### LOCATION

- Immediate access to I-95 and 295, via Route 32
- Adjacent to National Business Park and The National Security Administration
- Ease of multi-market accessibility, 12011 Guilford is equidistant between Washington D.C. and Baltimore
- Heart of the Baltimore/Washington Corridor with efficient travel times to BWI Thurgood Marshall Airport

### FACILITY: SUITE 101

- 10,899 SF available
- 3,376 SF office space
- 1 dock doors; 1 drive-in door
- 22' clear height
- 30' x 39' column spacing
- 277-480v electric service

### FACILITY: SUITE 110

- 10,229 SF available
- 1,505 SF office space
- 1 dock door; 1 drive-in door
- 22' clear height
- 30' x 39' column spacing
- 277-480v electric service

Your single-source service for efficient move-in and operations: [prologisessentials.com](https://www.prologisessentials.com)

# 10,229 - 21,128 SF

## Industrial Space For Lease



### Prologis Corridor Park 17

#### Lee & Associates

Kate Jordan, SIOR  
kjordan@lee-associates.com  
ph +1 443 741 4041  
8840 Stanford Boulevard  
Suite 4300  
Columbia, MD 21045 USA

#### Lee & Associates

Tom Whelan  
twhelan@lee-associates.com  
ph +1 443 741 4042  
8840 Stanford Boulevard  
Suite 4300  
Columbia, MD 21045 USA

#### Lee & Associates

Marley Welsh, SIOR  
mwelsh@lee-associates.com  
ph +1 443 741 4050  
8840 Stanford Boulevard  
Suite 4300  
Columbia, MD 21045 USA



#### Prologis

Karen Cherry  
kcherry@prologis.com  
ph +1 410 872 4560  
6721 Columbia Gateway Drive  
Suite 150  
Columbia, MD 21046 USA

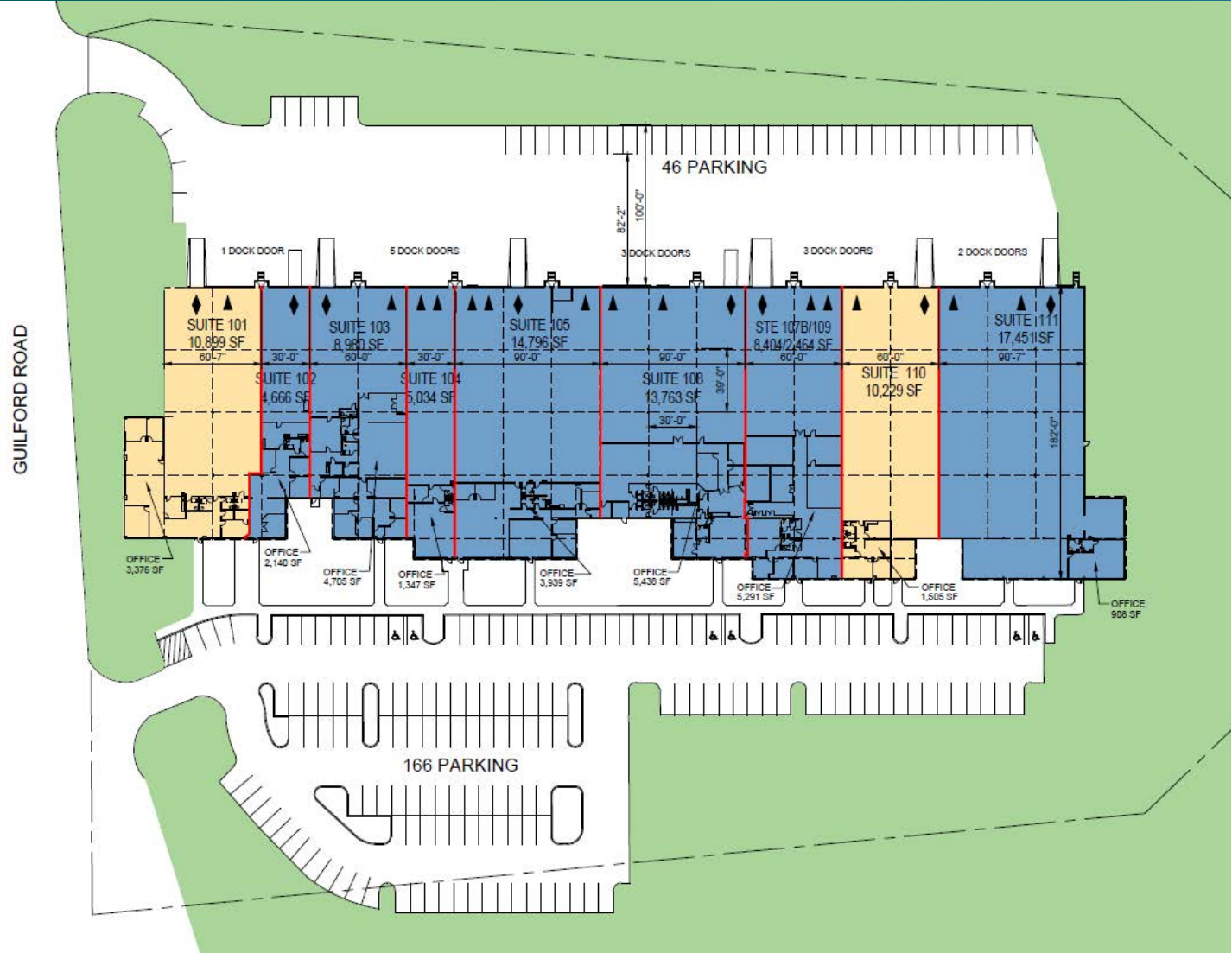

No warranty or representation, expressed or implied, is made as to the accuracy of the information contained herein, and same is submitted subject to error and omissions.