

PROLOGIS PARK SHARONVILLE

12111-12151 Best Place
Sharonville, OH

BUILDING 4

OVERALL BUILDING INFORMATION:

TOTAL BUILDING FOOTPRINT:	201,600 SF
AUTO PARKING SPACES:	138
TRAILER PARKING SPACES:	19
DOCK DOORS W/ LEVELERS:	33
DOCK DOORS:	0
DRIVE-INS:	1
OFFICE A:	1,559 SF
OFFICE B:	1,650 SF
OFFICE C:	3,418 SF
OFFICE D:	405 SF
OFFICE E:	7,066 SF
OFFICE F:	2,079 SF
OFFICE G:	113 SF
TOTAL OFFICE:	16,290 SF

LEGEND:

- ▲ DOCK POSITION
- ▲ DOCK POSITION W/ LEVELER
- △ FUTURE DOCK POSITION
- ◆ DRIVE-IN DOOR
- LAND
- LEASED AREA
- AVAILABLE AREA

BEST PLACE

128 AUTO PARKING

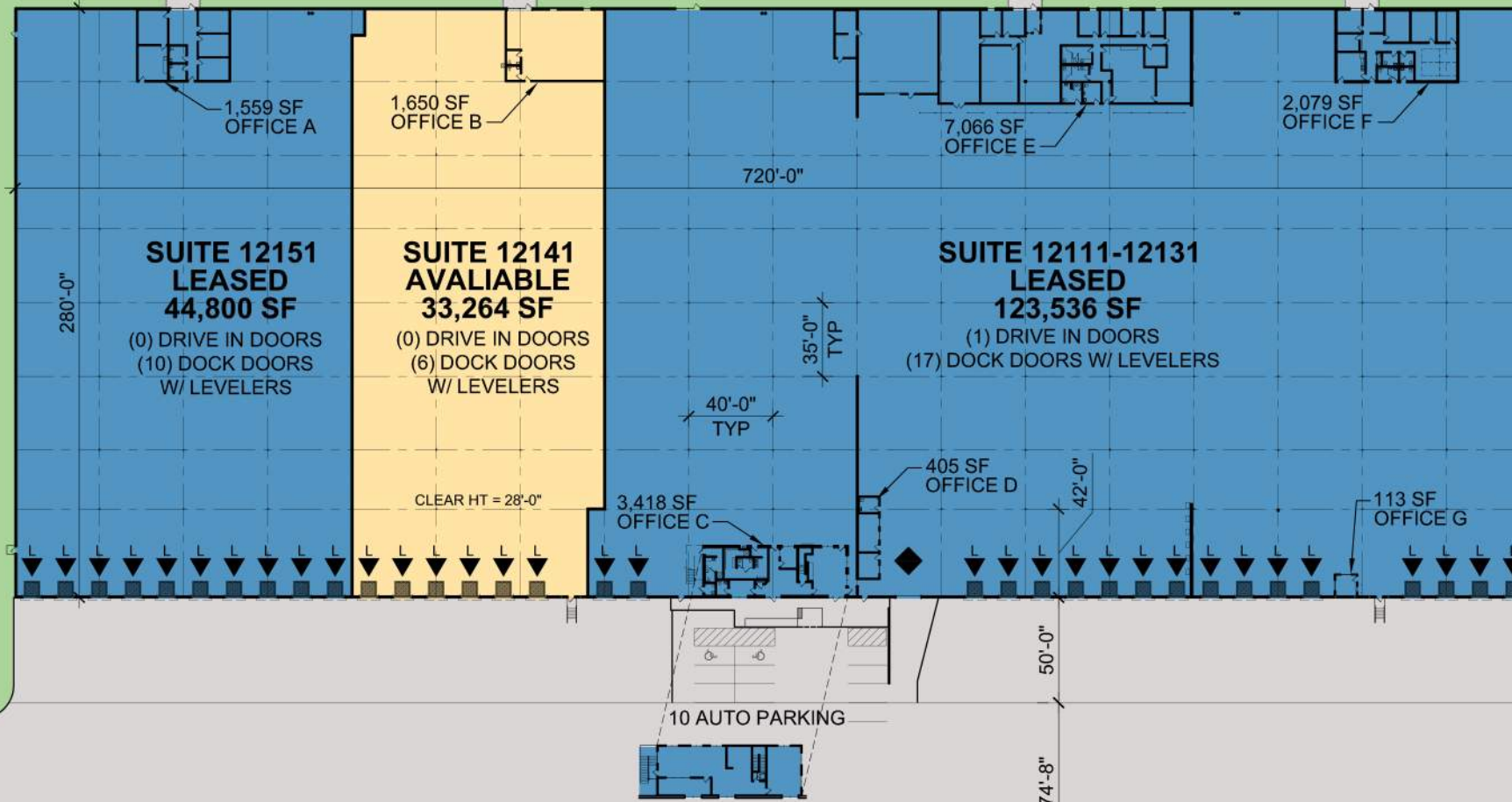

**SUITE 12151
LEASED
44,800 SF**
(0) DRIVE IN DOORS
(10) DOCK DOORS
W/ LEVELERS

**SUITE 12141
AVAILABLE
33,264 SF**
(0) DRIVE IN DOORS
(6) DOCK DOORS
W/ LEVELERS

**SUITE 12111-12131
LEASED
123,536 SF**
(1) DRIVE IN DOORS
(17) DOCK DOORS W/ LEVELERS

NOTE: THIS CONCEPTUAL PLAN IS FOR MARKETING PURPOSES ONLY AND HAS BEEN PREPARED BASED ON PRELIMINARY AVAILABLE SITE INFORMATION DEEMED RELIABLE. ALL DIMENSION AREA CALCULATIONS ARE SUBJECT TO VERIFICATION BY A PROFESSIONAL ENGINEER FOR COMPLIANCE WITH ALL FEDERAL, STATE, AND LOCAL REGULATIONS.

SITE PLAN

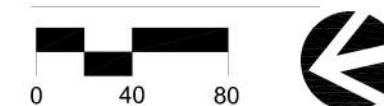

8760 Global Way West Chester, OH 45069
Telephone (513) 346-6300



SEPTEMBER 21, 2023 PROJECT #: 23003