

PROLOGIS PARK DOLWICK

1600-1650 Dolwick Drive
Erlanger, Kentucky 41018

BUILDING 1

OVERALL BUILDING INFORMATION:

TOTAL BUILDING FOOTPRINT: 112,000 SF
CLEAR HEIGHT: 24'-0"
AUTO PARKING SPACES: 113

SUITE A:
TOTAL OFFICE AREA: 706 SF
DOCK DOORS W/ LEVELERS: 1
DRIVE-INS: 1
FUTURE DOCK DOORS: 3

SUITE B:
TOTAL OFFICE AREA: 6,125 SF
DOCK DOORS W/ LEVELERS: 1
DOCK DOORS: 1
DRIVE-INS: 1

SUITE C:
TOTAL OFFICE AREA: 120 SF
DOCK DOORS W/ LEVELERS: 1
DOCK DOORS W/ EDGE LEVELERS: 1
DOCK DOORS: 1
FUTURE DOCK DOORS: 2

SUITE D:
OFFICE A AREA: 5,153 SF
OFFICE B AREA: 1,712 SF
TOTAL OFFICE AREA: 6,865 SF
DOCK DOORS W/ LEVELERS: 14
DRIVE-INS: 1
FUTURE DOCK DOORS: 6

LEGEND:

- ▲ DOCK POSITION
- ▲
L DOCK POSITION W/ LEVELER
- ▲
EL DOCK POSITION W/ EDGE LEVELER
- △ FUTURE DOCK POSITION
- ◆ DRIVE-IN DOOR



8760 Global Way West Chester, OH 45069
Telephone (513) 346-6300



1063 Central Avenue Cincinnati, Ohio 45202
p: 513.241.4422 f: 513.241.5560 www.ata-b.com

JANUARY 22, 2019 PROJECT #: 19003

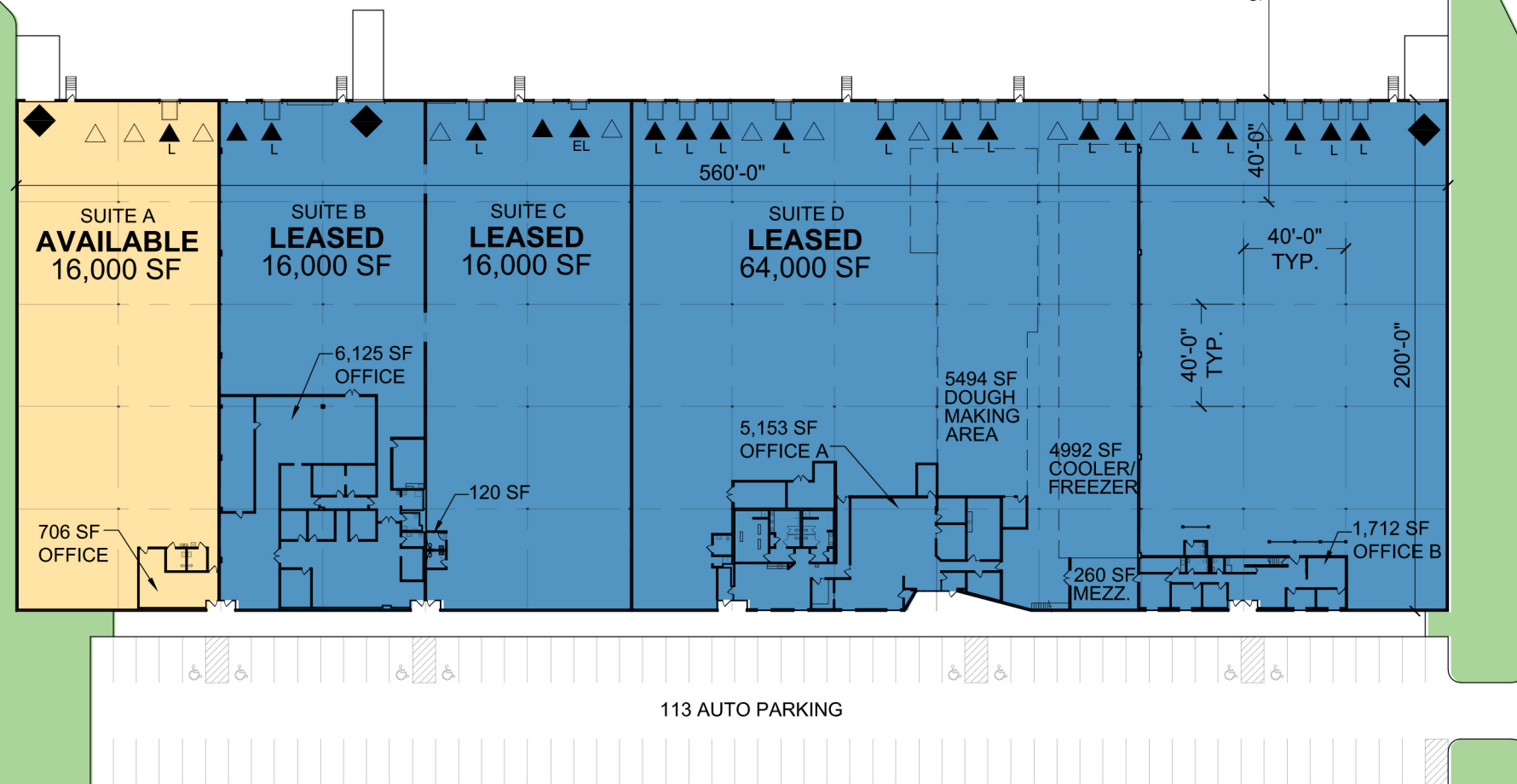

NOTE: THIS CONCEPTUAL PLAN IS FOR MARKETING PURPOSES ONLY AND HAS BEEN PREPARED BASED ON PRELIMINARY AVAILABLE SITE INFORMATION DEEMED RELIABLE. ALL DIMENSION AREA CALCULATIONS ARE SUBJECT TO VERIFICATION BY A PROFESSIONAL ENGINEER FOR COMPLIANCE WITH ALL FEDERAL, STATE, AND LOCAL REGULATIONS.

SITE PLAN

