

# 38,576 SF

## Industrial Space For Lease



## Prologis Meadowlands

55 Madison Circle Drive  
East Rutherford, NJ 07073 USA



### LOCATION

- Immediate access to NJ Turnpike Exit 16W, Interstate 80, Route 3, and Route 46
- ± 10 miles to New York City via Lincoln and Holland Tunnels
- ± 15 miles from Newark Liberty International Airport and Port Newark-Elizabeth

### FACILITY

- 150,446 SF total building size
- 38,576 SF available space
- 6,978 SF office
- 20' clear height
- 40' x 31'9" column spacing
- 5 dock doors
- 1 drive-in door
- Power: 400 amps, 277/480 volts

### ADVANTAGES AND AMENITIES

- Prologis Clear Lease® – Know your lease expenses and capital costs with greater certainty before you sign
- Fast, cost-effective forklift and racking sourcing through Prologis Essentials

# 38,576 SF

## Industrial Space For Lease

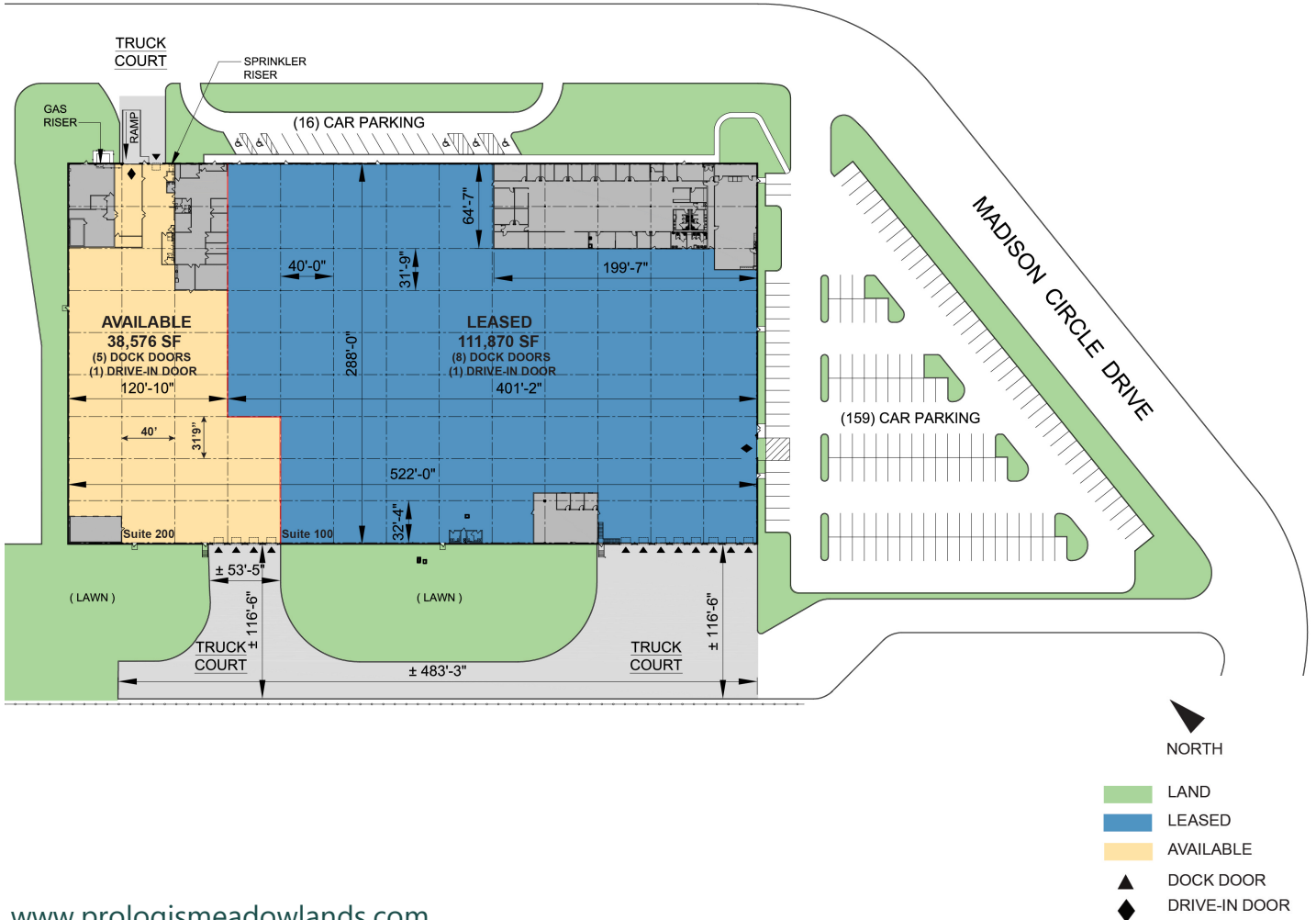

[www.prologismeadowlands.com](http://www.prologismeadowlands.com)



**CBRE, Inc.**

**Thomas F. Monahan**  
thomas.monahan@cbre.com  
ph +1 201 712 5610  
cell +1 973 568 6614  
Park 80 West  
Plaza Two  
Saddle Brook, NJ 07663 USA

**CBRE, Inc.**

**Stephen D'Amato**  
stephen.damato@cbre.com  
ph +1 201 712 5616  
cell +1 201 306 3788  
Park 80 West  
Plaza Two  
Saddle Brook, NJ 07663 USA

**CBRE, Inc.**

**Larry Schiffenhaus**  
larry.schiffenhaus@cbre.com  
ph +1 201 712 5809  
cell +1 201 532 5092  
Park 80 West  
Plaza Two  
Saddle Brook, NJ 07663 USA

**Prologis**

**Sarah Rutherford**  
srutherford@prologis.com  
ph +1 201 528 9576  
cell +1 551 206 6985  
One Meadowlands Plaza  
Suite 100  
East Rutherford, NJ 07073 USA