

**PROLOGIS
EDISON**

35 NATIONAL ROAD
EDISON, NEW JERSEY 08817

TOTAL FOOTPRINT:	49,714 S.F.
OFFICE:	2,896 S.F.
WAREHOUSE:	46,818 S.F.
PERCENTAGE OFFICE:	5.8%
CLEAR HEIGHT:	20'-0"
PARKING:	11 STALLS
DOCK-HIGH DOORS:	10
DRIVE-IN DOORS:	1
TYPICAL BAY:	33'-7" x 34'-3"

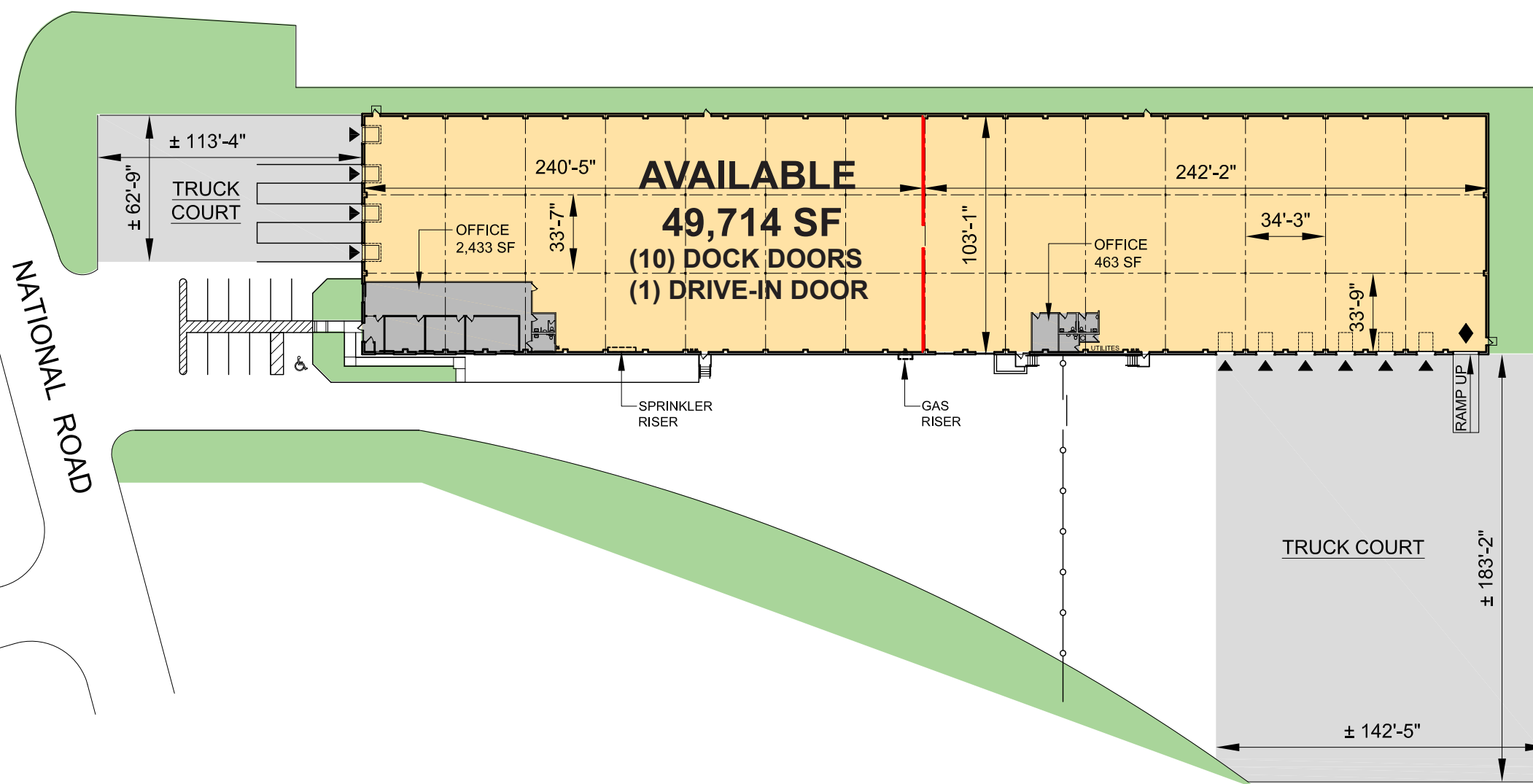

- LAND
- AVAILABLE
- DOCK DOOR
- DRIVE-IN DOOR

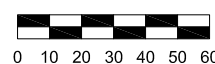

The above information/drawing is for reference only and is subject to verification, and/or revision. No liability for omissions shall be assumed. Area calculations are approximate and subject to change without notice.