

35,840 SF

**701 District Drive
Itasca, IL 60143**

Prologis Itasca

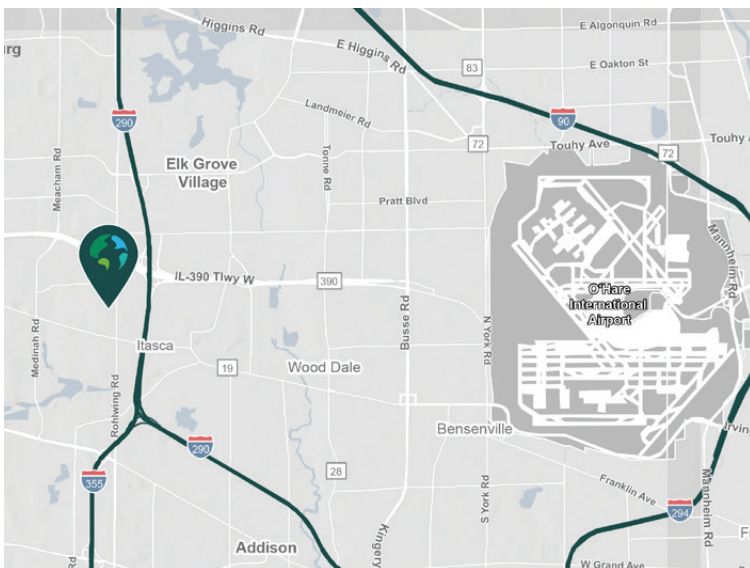

- Easy access to I-290, I-355 and I-390
- Close proximity to O'Hare International Airport
- Low DuPage County taxes
- Institutionally owned & managed

Property Features

Available Space	35,840 SF
Office SF	3,330 SF
Clear Height	18'
Column Spacing	33' x 32'
Dock Doors	2 interior
Drive-in Doors	1
Car Parking Spaces	26 car stalls
Electrical Service	800 amps @ 480 volts
Sprinkler	Class IV
Warehouse A/C	25-ton unit (portion of warehouse)



Unlock the full potential of your warehouse with one strategic, single-source partner.

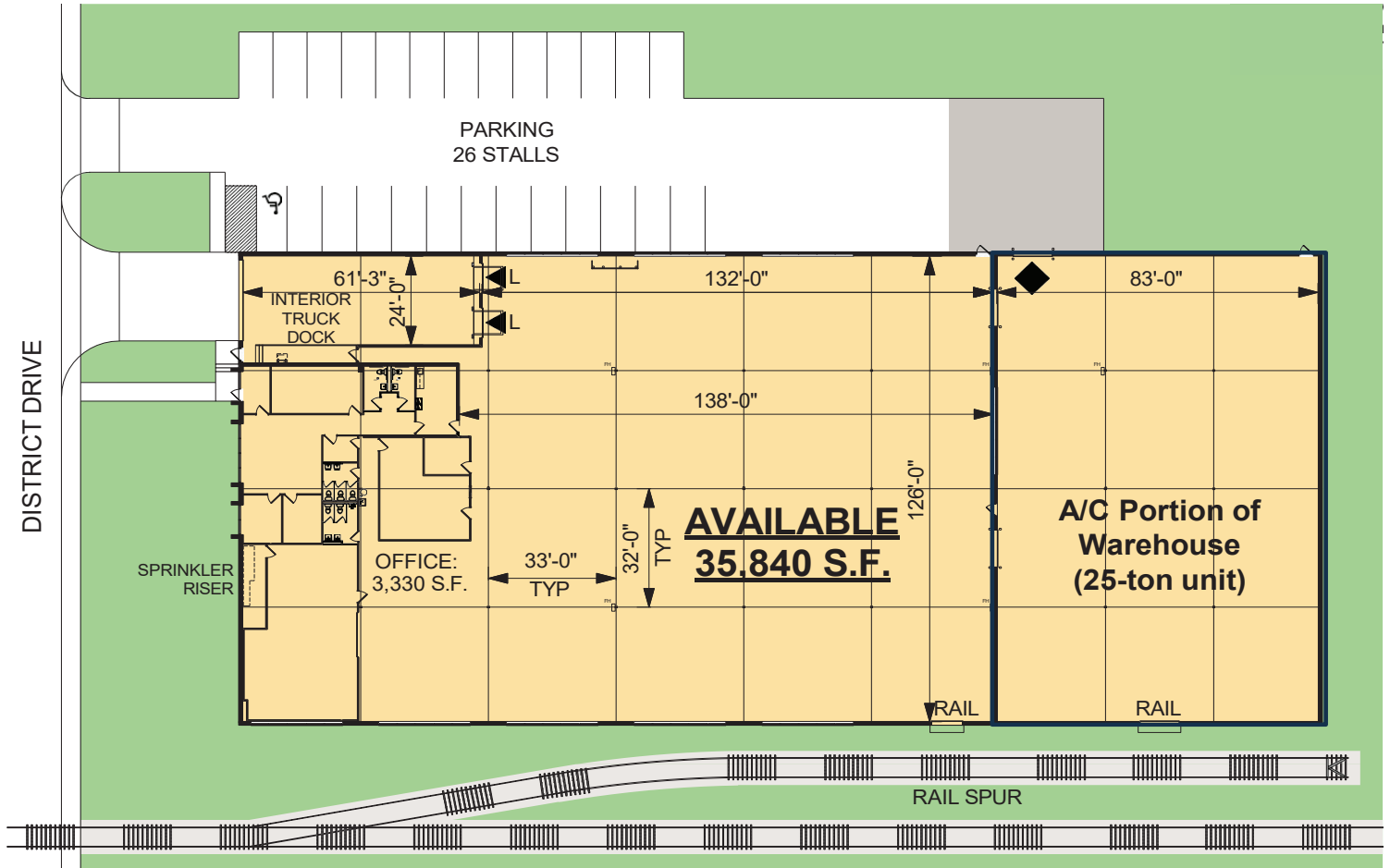

Lee & Associates of Illinois
Jeff Janda, SIOR
 jjanda@address.com
 ph +1 773 355 3015
 9450 W. Bryn Mawr Avenue
 Suite 550
 Rosemont, IL 60018

Lee & Associates of Illinois
Michael Plumb
 mplumb@address.com
 ph +1 773 355 3019
 9450 W. Bryn Mawr Avenue
 Suite 550
 Rosemont, IL 60018

Prologis
Sam Evans
 sevans@prologis.com
 ph +1 847 292 3860
 6250 N. River Road
 Suite 1100
 Rosemont, IL 60018
 prologis.com