

121,344 SF

Industrial Space For Lease



Prologis Franklin Park

10800 - 10900 Belmont Avenue, Suite 300
Franklin Park, IL 60608 USA

LOCATION

- Easy access to O'Hare International Airport
- Close proximity to the City of Chicago
- Excellent tollway visibility (I-294) with signage availability

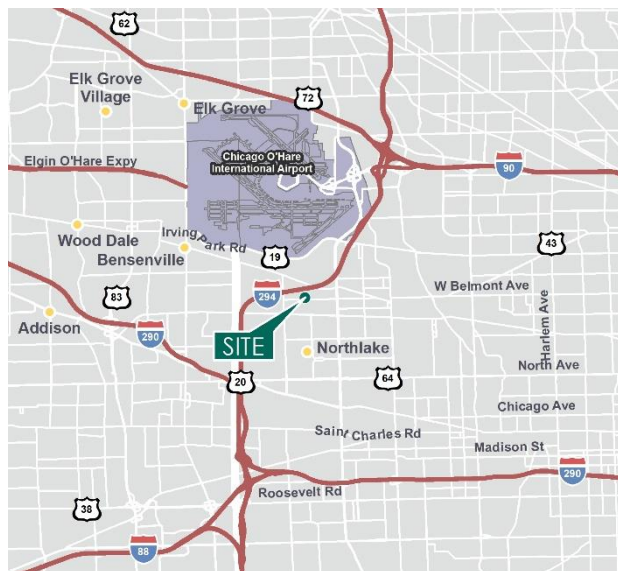

FACILITY

- 121,344 SF available
- Mezzanine – 38,043 SF (not included in total SF)
- 6,130 SF main office
- 2,956 SF warehouse office
- 21' clear height
- 7 interior docks
- Freight elevator for mezzanine
- 43 car parking stalls
- 4 trailer parking stalls

ADVANTAGES AND AMENITIES

- Approved 6B tax status in place

121,344 SF

Industrial Space For Lease



Cushman & Wakefield

Larry Goldwasser, SIOR
Larry.goldwasser@cushwake.com
ph +1 312 470 2323
cell +1 312 953 5744
225 W Wacker Drive
Suite 3000
Chicago, IL 60606 USA

Cushman & Wakefield

Colin Green
Colin.green@cushwake.com
ph +1 312 470 2322
cell +1 630 272 9968
225 W Wacker Drive
Suite 3000
Chicago, IL 60606 USA

Cushman & Wakefield

Matt Cowie
Matt.cowie@cushwake.com
ph +1 312 470 1872
cell +1 312 735 6510
225 W Wacker Drive
Suite 3000
Chicago, IL 60606 USA

Prologis

Maggie Tullier
mtullier@prologis.com
ph +1 847 292 3943
cell +1 847 420 4145
6250 N River Road
Suite 1100
Rosemont, IL 60018 USA

121,344 SF

Industrial Space For Lease

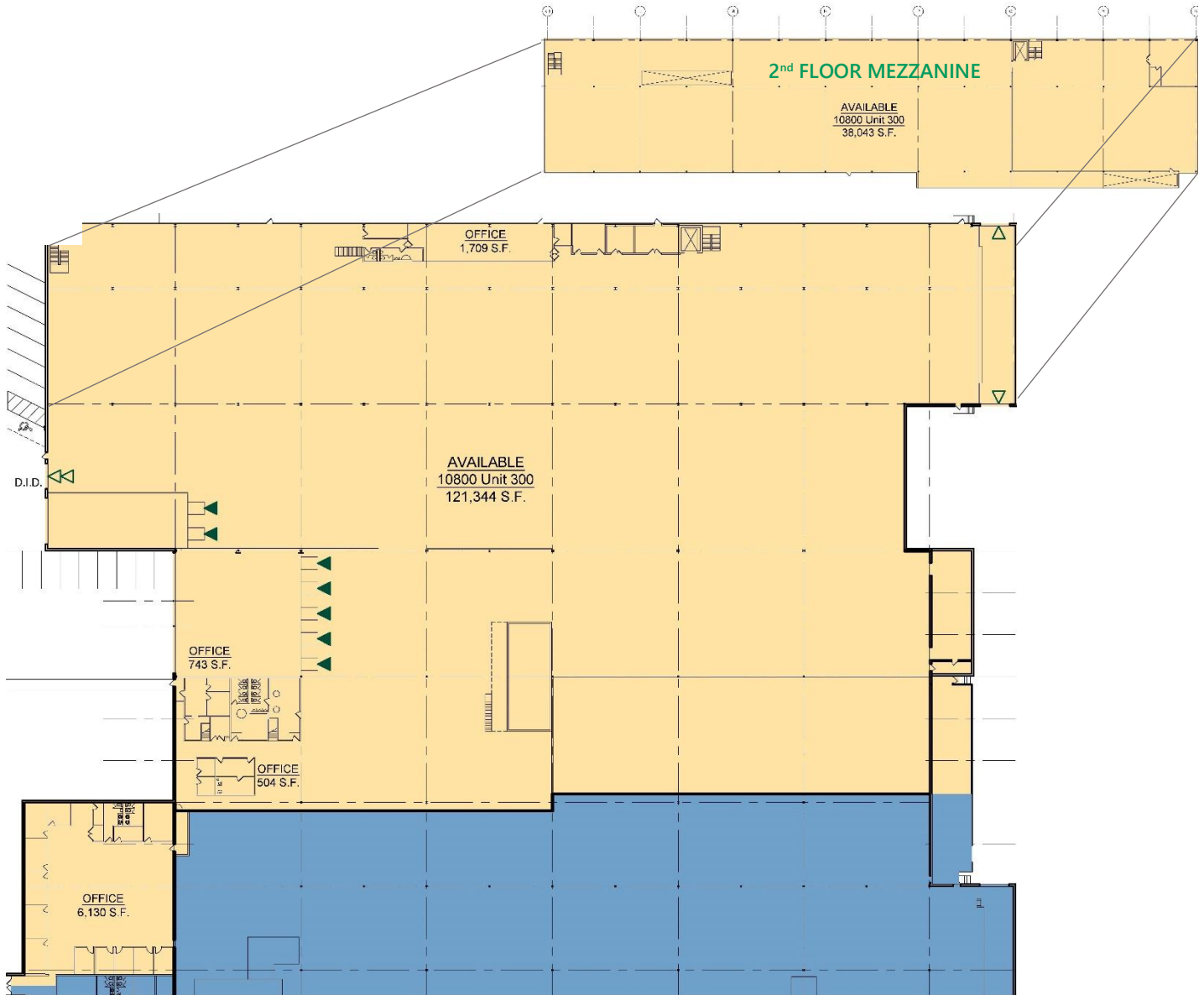

Cushman & Wakefield

Larry Goldwasser, SIOR

Larry.goldwasser@cushwake.com

ph +1 312 470 2323

cell +1 312 953 5744

225 W Wacker Drive

Suite 3000

Chicago, IL 60606 USA

Cushman & Wakefield

Colin Green

Colin.green@cushwake.com

ph +1 312 470 2322

cell +1 630 272 9968

225 W Wacker Drive

Suite 3000

Chicago, IL 60606 USA

Cushman & Wakefield

Matt Cowie

Matt.cowie@cushwake.com

ph +1 312 470 1872

cell +1 312 735 6510

225 W Wacker Drive

Suite 3000

Chicago, IL 60606 USA

Prologis

Maggie Tullier

mtullier@prologis.com

ph +1 847 292 3943

cell +1 847 420 4145

6250 N River Road

Suite 1100

Rosemont, IL 60018 USA