

19,200 SF

Industrial Space For Lease



Prologis Atlanta Airport



575 Forest Parkway, Suite G
Atlanta, GA 30349 USA

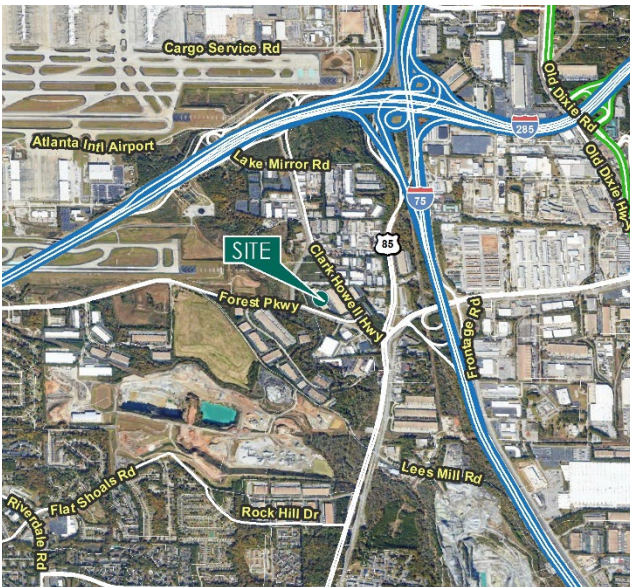

LOCATION

- ± 1.5 miles from I-75 S, ± 2.4 miles from I-285, and ± 5.5 miles from I-85
- ± 3.7 miles from Hartsfield Jackson International Airport, the nation's busiest airport
- ± 9.9 miles from East Point Marta Station, convenient access to public transportation

FACILITY

- 99,200 SF building
- 19,200 SF available
 - 4,331 SF office
- Six (6) dock doors with levelers
- One (1) drive-in door
- LED office and warehouse lighting
- 24' clear height
- 40' x 40' column spacing
- Twenty-seven (27) auto parking spaces
- Two (2) trailer parking spaces

ADVANTAGES AND AMENITIES

- Fast, cost-effective forklift and racking sourcing through Prologis Essentials
- Prologis Clear Lease[®] - know your lease expenses and capital costs with greater certainty before you sign

Prologis Essentials: your single-source service for efficient move-in and operations at [prologisessentials.com](https://www.prologisessentials.com)

19,200 SF

Industrial Space For Lease



Prologis Atlanta Airport

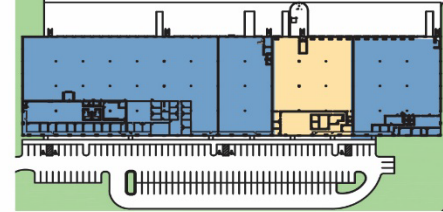
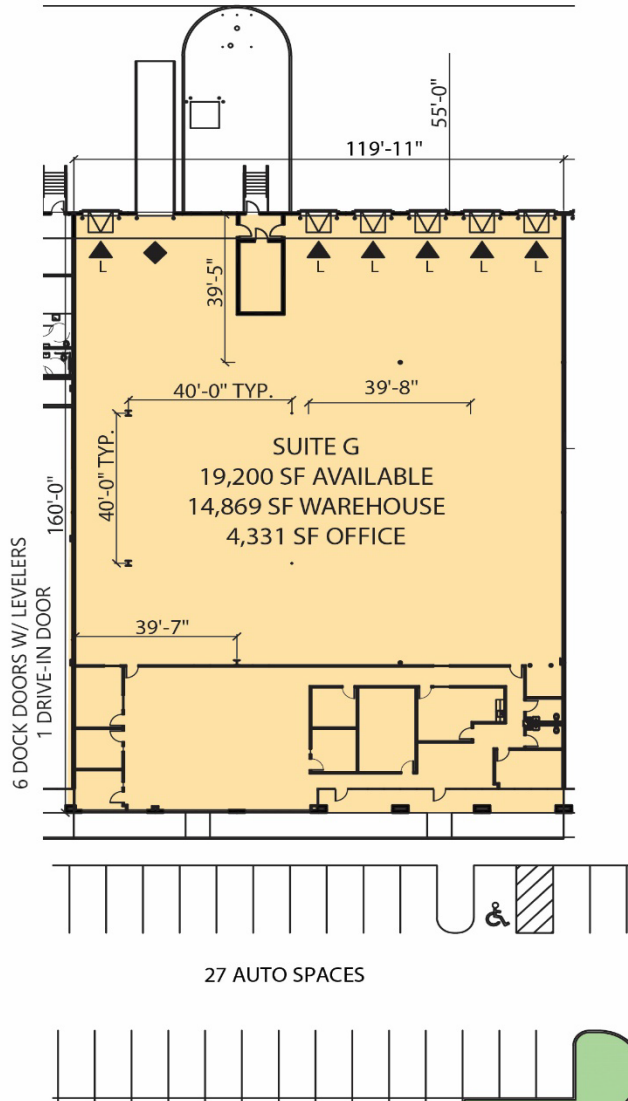

KEY PLAN

LEGEND:

- DOCK DOOR
- DOCK DOOR W/LEVELER
- DRIVE-IN DOOR
- ON-GRADE DOOR
- EDGE OF DOCK LEVELER
- PIT LEVELER
- LAND
- LEASED AREA
- VACANT AREA



Reliant

Alex McArthur

amcarthur@reliant-re.com
ph +1 404 760 7420
cell +1 404 405 0290
3490 Piedmont Road NE
Suite 1025
Atlanta, GA 30305 USA

Reliant

Mike Weinberger

mweinberger@reliant-re.com
ph +1 404 760 7183
cell +1 770 891 7235
3490 Piedmont Road NE
Suite 1025
Atlanta, GA 30305 USA

Reliant

Drew Venable

dvenable@reliant-re.com
ph +1 404 760 7186
cell +1 229 392 8745
3490 Piedmont Road NE
Suite 1025
Atlanta, GA 30305 USA

Prologis

Sarah Stafford

sstafford@prologis.com
ph +1 404 760 7214
cell +1 404 561 8378
3475 Piedmont Road NE
Suite 650
Atlanta, GA 30305 USA

Prologis Essentials: your single-source service for efficient move-in and operations at prologisessentials.com

No warranty or representation, expressed or implied, is made as to the accuracy of the information contained herein, and same is submitted subject to error and omissions.