

26,849 SF

Industrial Space For Lease



Prologis Lake Forest Business Center



20191 Windrow Drive, Suite 200
Lake Forest, CA 92630

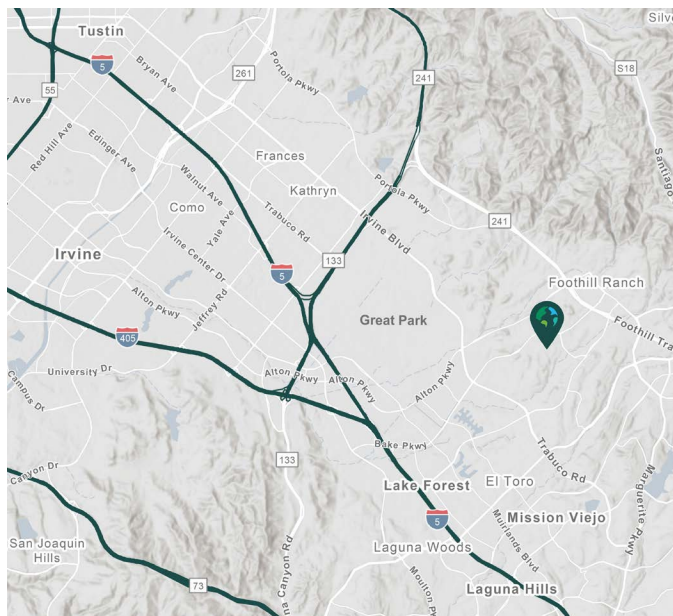

LOCATION

- Close proximity to the Foothill Towne Centre which has numerous retail amenities and restaurants
- Immediate access to the Foothill 241 Transportation Corridor

FACILITY

- High image, drive around building
- ±26,849 sf with ±2,400 sf of single-story office area
- One (1) ground level door
- Two (2) dock high doors
- ±26' minimum warehouse clearance
- 400 amps, 277/480 volt, 3-phase power panel
- .60/gpm/3,000 s.f. calculated sprinkler system
- ±1.70:1,000 parking ratio (45 spaces)

ADVANTAGES AND AMENITIES

- Access to the Prologis Essentials platform, which includes:
 - [Operations Essentials](#)
 - [Energy Essentials](#)
 - [Workforce Essentials](#)
 - [Mobility Essentials](#)
 - [Digital Essentials](#)

Your single-source service for efficient move-in and operations: [prologisessentials.com](https://www.prologisessentials.com)

26,849 SF

Industrial Space For Lease



Prologis Lake Forest Business Center

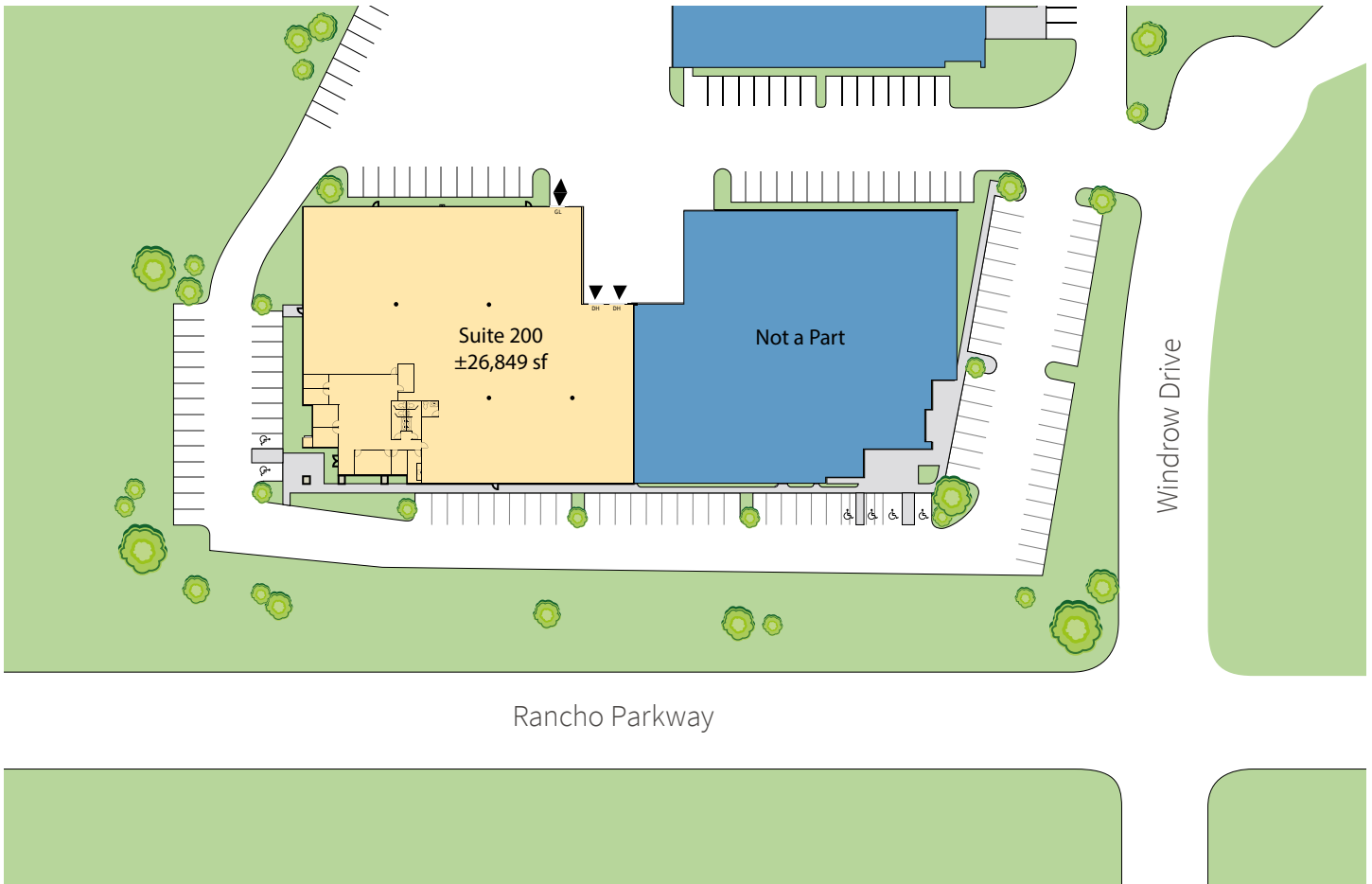

Byron Foss
Managing Director
bfoss@jll.com
ph +1 949 296 3615
Lic. 01754625
17877 Von Karman Avenue
Suite 500
Irvine, CA 92614

Wade Tift
Managing Director
wade.tift@jll.com
ph +1 949 296 3605
Lic. 01274371
17877 Von Karman Avenue
Suite 500
Irvine, CA 92614

Prologis
Parker Hutchison
phutchison@prologis.com
ph +1 562 345 9209
Lic. 01875578
17777 Center Court Drive North
Suite 100
Cerritos, CA 90703