

56,845 SF

Industrial Space For Lease



Prologis Simi Valley Distribution Center 1



3990 Heritage Oak Ct., Unit B
Simi Valley, CA 93063 USA

LOCATION

- Ideal location on corner of Tapo Canyon Rd. and Heritage Oak Ct.
- Easy access to 118 Freeway
- East Simi Valley location - central to North Los Angeles region

FACILITY

- Part of a 144,848 SF building
- 30-foot clear height
- 6 dock high positions and 1 ground level loading door - additional dock high positions possible
- 7,165 SF freshly remodeled, high image ground floor office space - includes large lunchroom, updated restrooms and shipping office
- .45 gpm/3,000 sf calculated sprinkler system
- Heavy power: 2000 Amps at 277/480 Volts
- Drive around truck access
- Concrete yard
- 127 parking stalls (2.23/1,000)

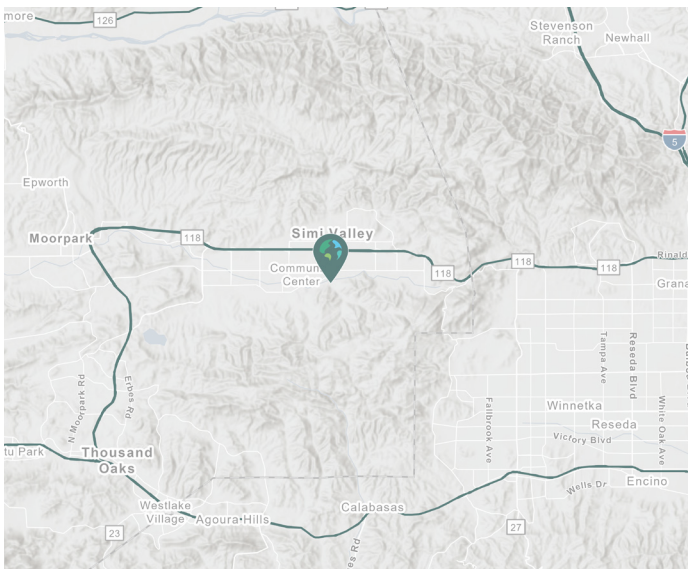

Prologis Essentials: your single-source service for efficient move-in and operations at [prologisessentials.com](https://www.prologisessentials.com)

56,845 SF

Industrial Space For Lease



Prologis Simi Valley Distribution Center 1

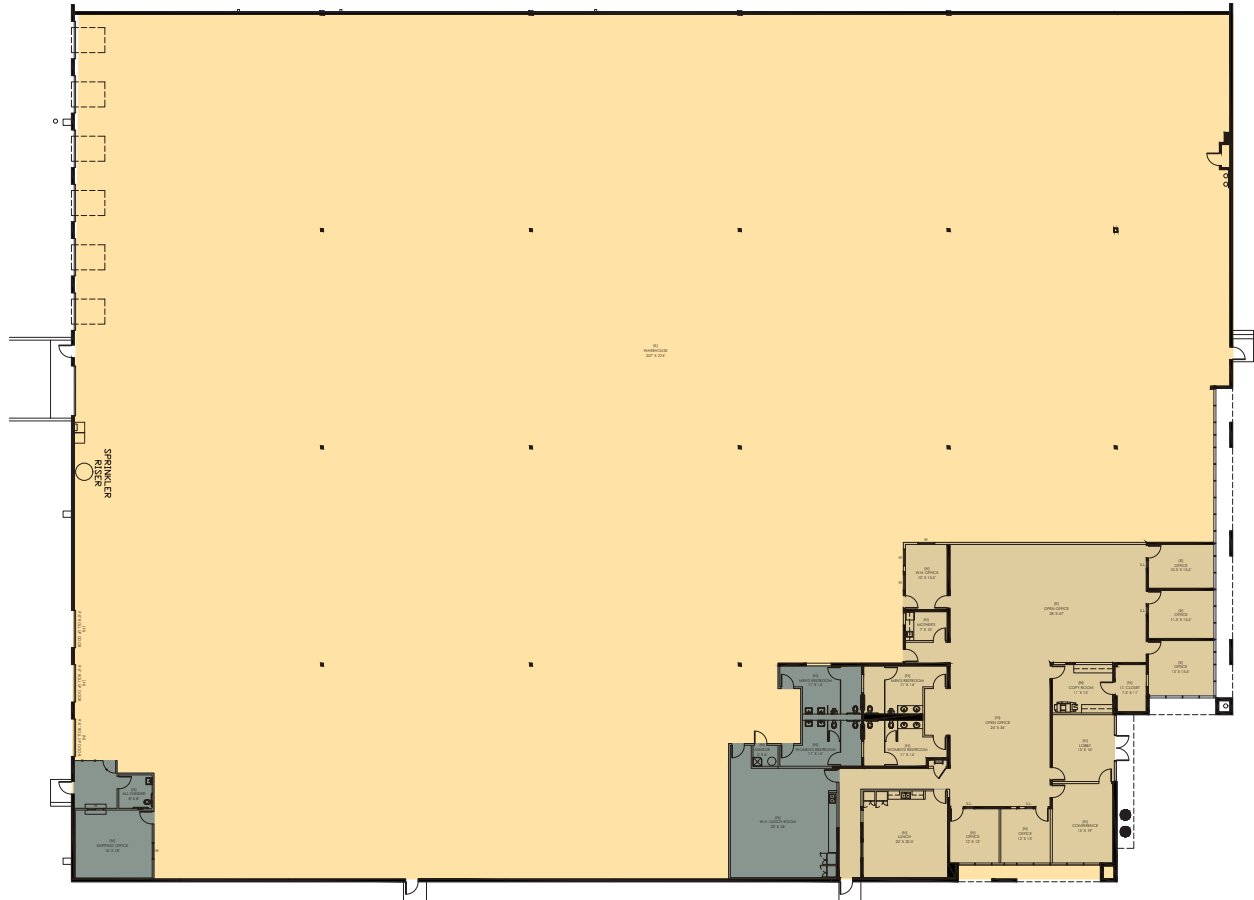

NEWMARK

John DeGrinis, SIOR

Lic. 00918958
john.degrinis@nrmk.com
ph +1 818 921 8529
cell +1 818 618 6955
24025 Park Sorrento
Suite 480
Calabasas, CA 91302 USA

Patrick DuRoss, SIOR

Lic. 01461031
patrick.duross@nrmk.com
ph +1 818 921 8530
cell +1 818 219 8903
24025 Park Sorrento
Suite 480
Calabasas, CA 91302 USA

Jeff Abraham, SIOR

Lic. 01830909
jeff.abraham@nrmk.com
ph +1 818 921 8528
cell +1 310 880 7403
24025 Park Sorrento
Suite 480
Calabasas, CA 91302 USA

Prologis

Lisa Reddy
Lic. 01327922
lreddy@prologis.com
ph +1 562 345 9206
cell +1 310 343 5347
2141 Rosecrans Ave.
Suite 1151
El Segundo, CA 90245 USA

Prologis Essentials: your single-source service for efficient move-in and operations at prologisessentials.com

No warranty or representation, expressed or implied, is made as to the accuracy of the information contained herein, and same is submitted subject to error and omissions.