

# PROLOGIS AIRPARK

1135-1147 Aviation Blvd.  
Hebron, Kentucky

## BUILDING 4

TOTAL BUILDING FOOTPRINT: 136,000 SF

AUTO PARKING SPACES: 123  
 FUTURE AUTO PARKING SPACES: 0  
 TRAILER PARKING SPACES: 0  
 FUTURE TRAILER PARKING SPACES: 0

DOCK DOORS W/ LEVELERS 12  
 DOCK DOORS 16  
 DOCK DOORS W/EDGE LEVELERS 2  
 DRIVE-INS 2

### LEGEND:

- ▲ DOCK POSITION
- ▲ DOCK POSITION W/ LEVELER
- ▲ DOCK POSITION W/EDGE LEVELER
- △ FUTURE DOCK POSITION
- ◆ DRIVE-IN DOOR
- LAND
- LEASED AREA
- AVAILABLE AREA

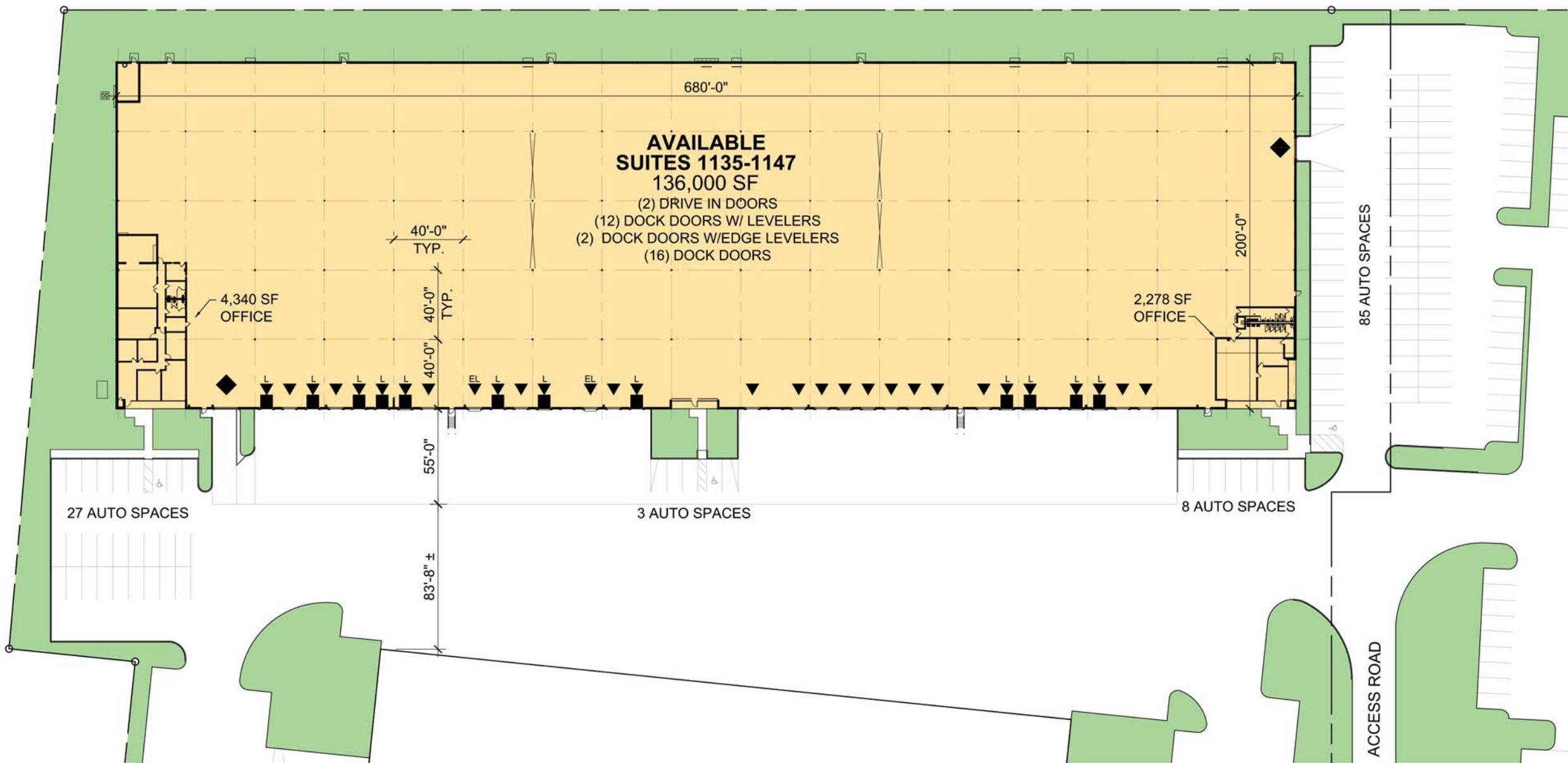

### SITE PLAN

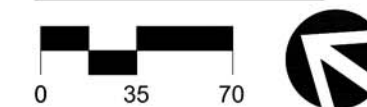

NOTE: THIS CONCEPTUAL PLAN IS FOR MARKETING PURPOSES ONLY AND HAS BEEN PREPARED BASED ON PRELIMINARY AVAILABLE SITE INFORMATION DEEMED RELIABLE. ALL DIMENSION AREA CALCULATIONS ARE SUBJECT TO VERIFICATION BY A PROFESSIONAL ENGINEER FOR COMPLIANCE WITH ALL FEDERAL, STATE, AND LOCAL REGULATIONS.



7048 Fairfield Business Dr. Fairfield, OH 45014  
Telephone (513) 346-6300

ATA | BEILHARZ ARCHITECTS  
 1063 Central Avenue Cincinnati, Ohio 45202  
 p: 513.241.4422 f: 513.241.5560 www.ata-b.com

JANUARY 15, 2020 PROJECT #: 20003