

# 118,897 SF

Industrial Space For Lease



## Prologis Beacon Centre 5



2000 NW 84<sup>th</sup> Avenue  
Doral, FL 33122 USA

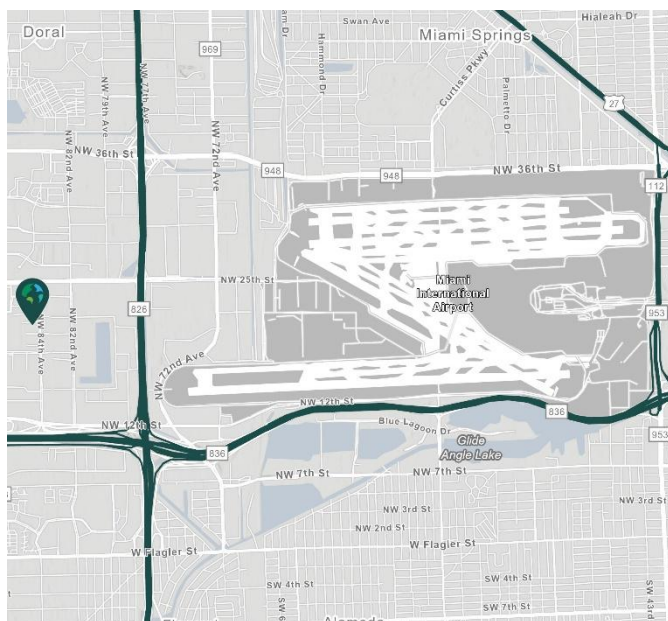

### LOCATION

- Easy access to Miami International Airport and PortMiami
- Direct access to 836 (Dolphin Expressway), with easy access to 826 (Palmetto Expressway), and Florida's Turnpike

### FACILITY

- ±118,897 SF available; inclusive of ±38,211 SF of office
- **Free standing building**
- 24' Clear height
- 21 Dock high doors; inclusive of 2 concrete ramps
- **Cross dock loading**
- Column spacing 51'-6" X 36'-0"
- Parking ratio 1:1,000
- Shared truck court
- Available May 2026

### ADVANTAGES AND AMENITIES

- Beacon Centre is a 205 acre secured master-planned business park located in the heart of the Airport West /Doral submarket.
- Nearby amenities include numerous restaurants, hotels, banks and shopping centers.
- **Prologis Clear Lease®** – Know your lease expenses and capital cost with greater certainty before your sign.

**Your single-source service for efficient move-in and operations: [prologisessentials.com](https://www.prologisessentials.com)**



Scan the QR code for more info!

# 118,897 SF

Industrial Space For Lease



## Prologis Beacon Centre 5

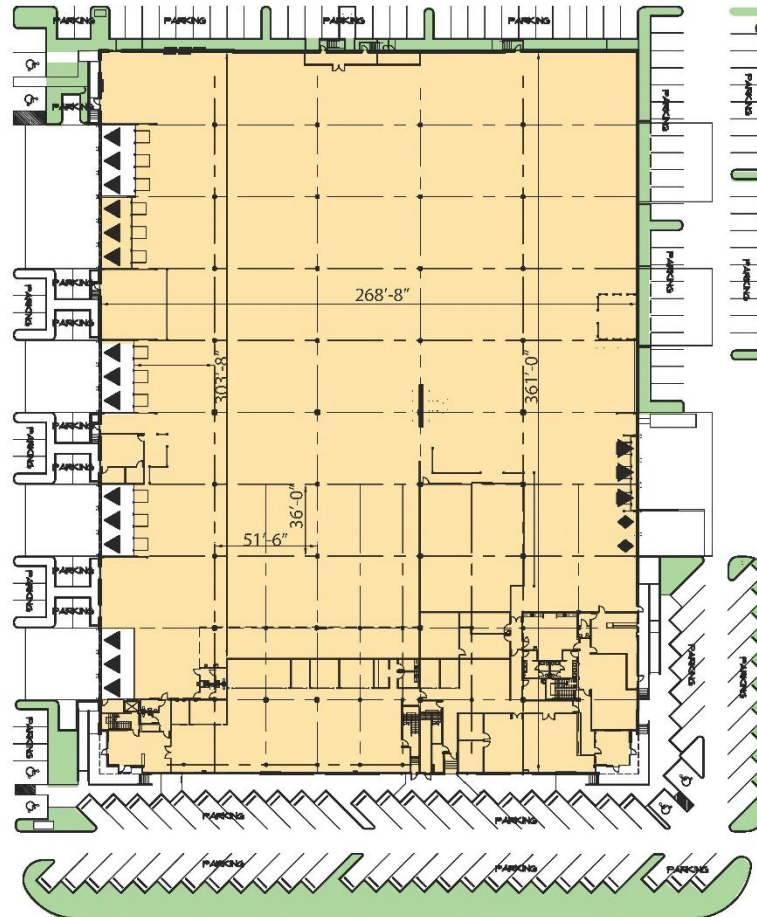

- AVAILABLE AREA
- LEASED AREA
- BACKGROUND LAND

- DRIVE-IN DOOR
- DOCK DOOR



### State Street Realty

George Pino, SIOR  
gpino@statestreetre.com  
ph +1 305 447 3390  
cell +1 786 402 7387  
8319 NW 12 Street  
Doral, FL 33126 USA

### State Street Realty

Brian Cabielles, SIOR  
bcabielles@statestreetre.com  
ph +1 305 447 3390  
cell +1 305 606 7109  
8319 NW 12 Street  
Doral, FL 33126 USA

### Prologis

Diana T. Escobar  
descobar@prologis.com  
ph +1 305 599 6221  
8355 NW 12 Street  
Doral, FL 33126 USA