

41,470 SF

Industrial Space For Lease



Prologis Woodridge



10351 Rising Court
Woodridge, IL 60517 USA

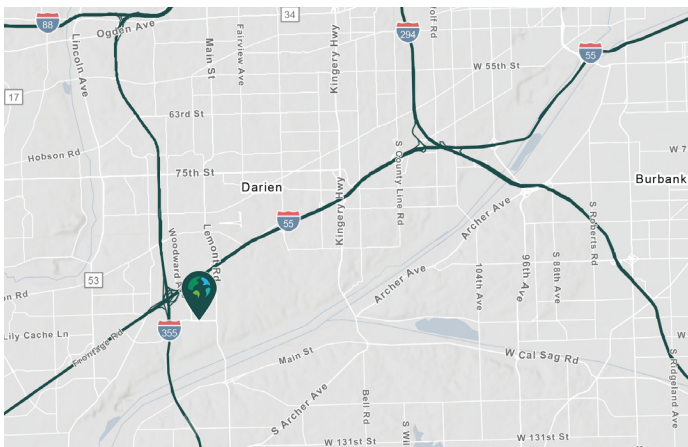

LOCATION

- Located in Chicago's premier Prologis Internationale Centre
- Immediate expressway access to I-55 and I-355 via 4-way interchanges at Joliet and Lemont Roads

FACILITY

- 41,470 sf available
- 8,603 sf mezzanine area
- 13,122 sf office
- 24' clear height
- 2 exterior docks
- 1 drive-in door
- 88 car parking
- 40' x 40' typical bay size
- 1200 amps, 277/480 volts
- ESFR sprinkler system

ADVANTAGES AND AMENITIES

- Area amenities include fuel, food and lodging
- Low DuPage County taxes

Prologis Essentials: your single-source service for efficient move-in and operations at prologisessentials.com

www.prologis.com

41,470 SF

Industrial Space For Lease



Prologis Woodridge

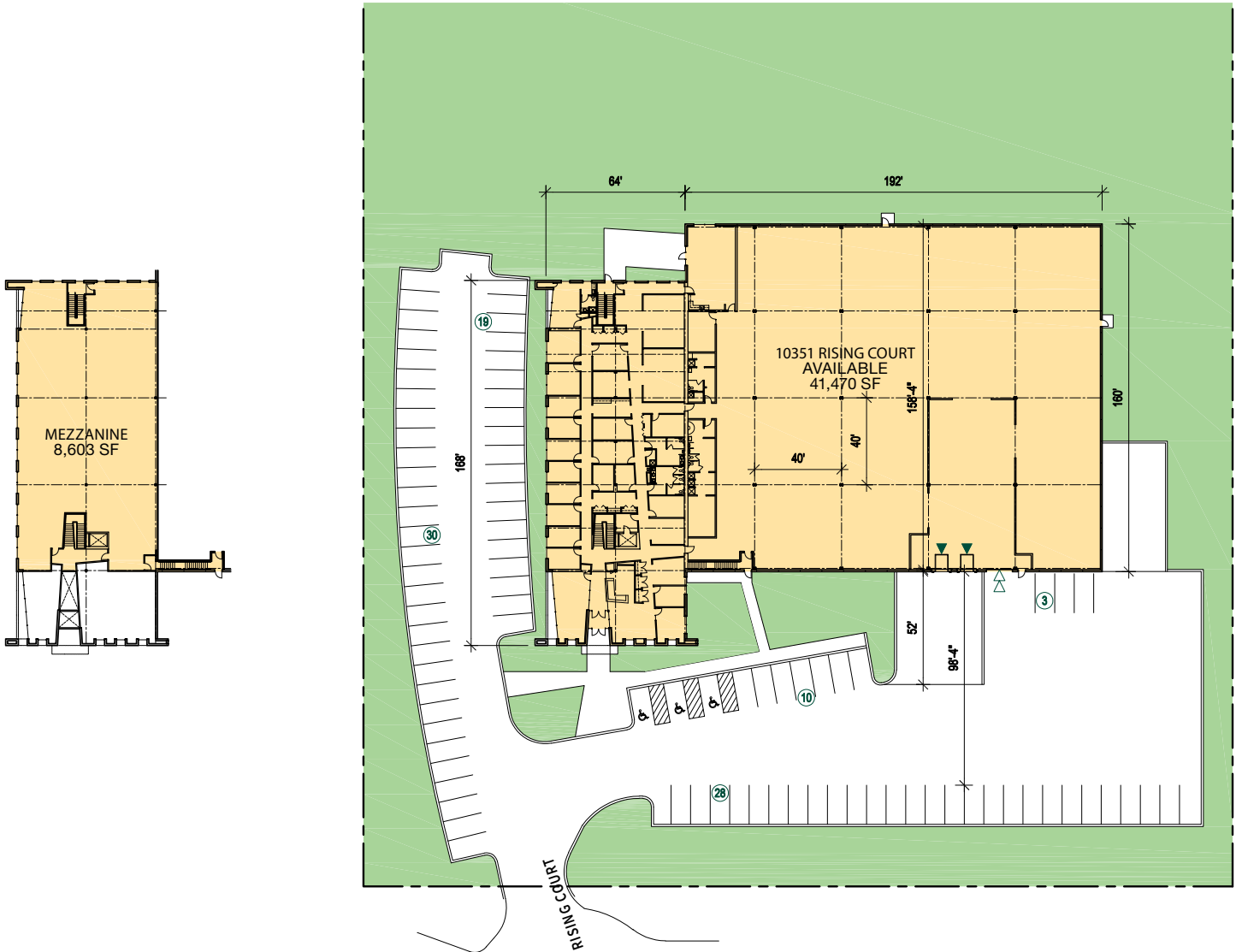

NAI Hiffman

Packy Doyle
pdoyle@hiffman.com
ph +1 630 691 0601
One Oakbrook Terrace
Suite 400
Oakbrook Terrace, IL 60181 USA

NAI Hiffman

Dan Leahy
dleahy@hiffman.com
ph +1 630 691 0604
One Oakbrook Terrace
Suite 400
Oakbrook Terrace, IL 60181 USA

NAI Hiffman

Adam Roth, CCIM, SIOR
aroth@hiffman.com
ph +1 630 691 0607
One Oakbrook Terrace
Suite 400
Oakbrook Terrace, IL 60181 USA

Prologis

Trevor Jeske
tjeske@prologis.com
ph +1 847 292 3866
6250 North River Road
Suite 1100
Rosemont, IL 60018 USA

Prologis Essentials: your single-source service for efficient move-in and operations at prologisessentials.com

No warranty or representation, expressed or implied, is made as to the accuracy of the information contained herein, and same is submitted subject to error and omissions.