

# ±246,470 Available

State-of-the Art Facility Available



## Prologis NEI 21



Corner of E. Grant Line Rd. and Paradise Ave.  
Tracy, CA 95304 USA



### LOCATION

- Easy access to I-205, I-5, I-580 and Highways 120 and 99
- Located only 65 miles east of San Francisco and 54 miles east of the Port of Oakland

### FACILITY

- ±246,470 SF available
- 12.6 acres land area
- Office to suit
- Designed and built to LEED standards
- 36' clear height
- 56' x 60' speed bay
- 38 dock doors
- 60 trailer parking positions
- 206 auto parking spaces

### ADVANTAGES AND AMENITIES

- Access to the Prologis Essentials platform, which includes:

[Operations Essentials](#)

[Energy Essentials](#)

[Workforce Essentials](#)

[Mobility Essentials](#)

[Digital Essentials](#)

**Your single-source service for efficient move-in and operations: [prologisessentials.com](https://www.prologisessentials.com)**

QR CODE  
0.8" SQUARE  
1.3" CLEAR

Scan the QR code for more info!

QR code clearance

# ±246,470 Available

State-of-the Art Facility Available



## Prologis NEI 21

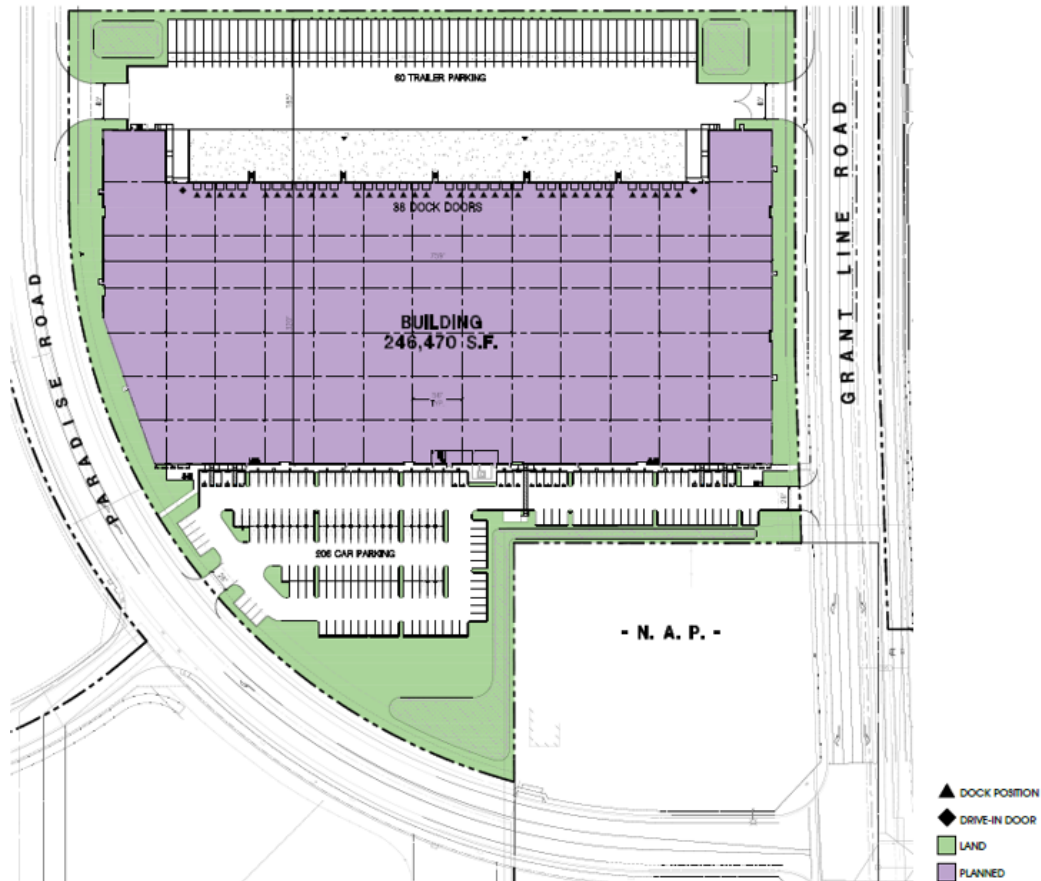

Planned East Elevation

### Prologis

Matt Drury  
mdrury@prologis.com  
ph +1 209 833 5389  
cell +1 415 418 4485  
615 International Parkway  
Tracy, CA 95304 USA

### Prologis

Bobby Gray  
rgray@prologis.com  
ph +1 415 733 9445  
cell +1 415 637 0153  
Pier 1, Bay 1  
San Francisco, CA 94111 USA

### Prologis

Claire Wilson  
cwilson2@prologis.com  
ph +1 209 833 5395  
cell +1 925 813 8623  
615 International Parkway  
Tracy, CA 95304 USA