

# 6,317 SF

Industrial Space For Lease



## Prologis Park Schiller Park



5130 Pearl Street  
Schiller Park, IL 60176 USA

### LOCATION

- Conveniently located next to O'Hare International Airport
- Excellent access to I-294, I-90, I-290 and I-390

### FACILITY

- 6,317 sf available
- 2,879 sf of warehouse
- 3,438 sf of office area (can be reduced)
- 400 amp service
- 58 auto stalls (entire building)
- 14' clear height
- 1 loading dock and double door access for loading
- 34'6" x 37' typical bay size

### ADVANTAGES AND AMENITIES

- Excellent Landlord and well-maintained space
- Walking distance to Rosemont's Entertainment District

**Your single-source service for efficient move-in and operations: [prologisessentials.com](https://www.prologisessentials.com)**



# 6,317 SF

Industrial Space For Lease



## Prologis Park Schiller Park

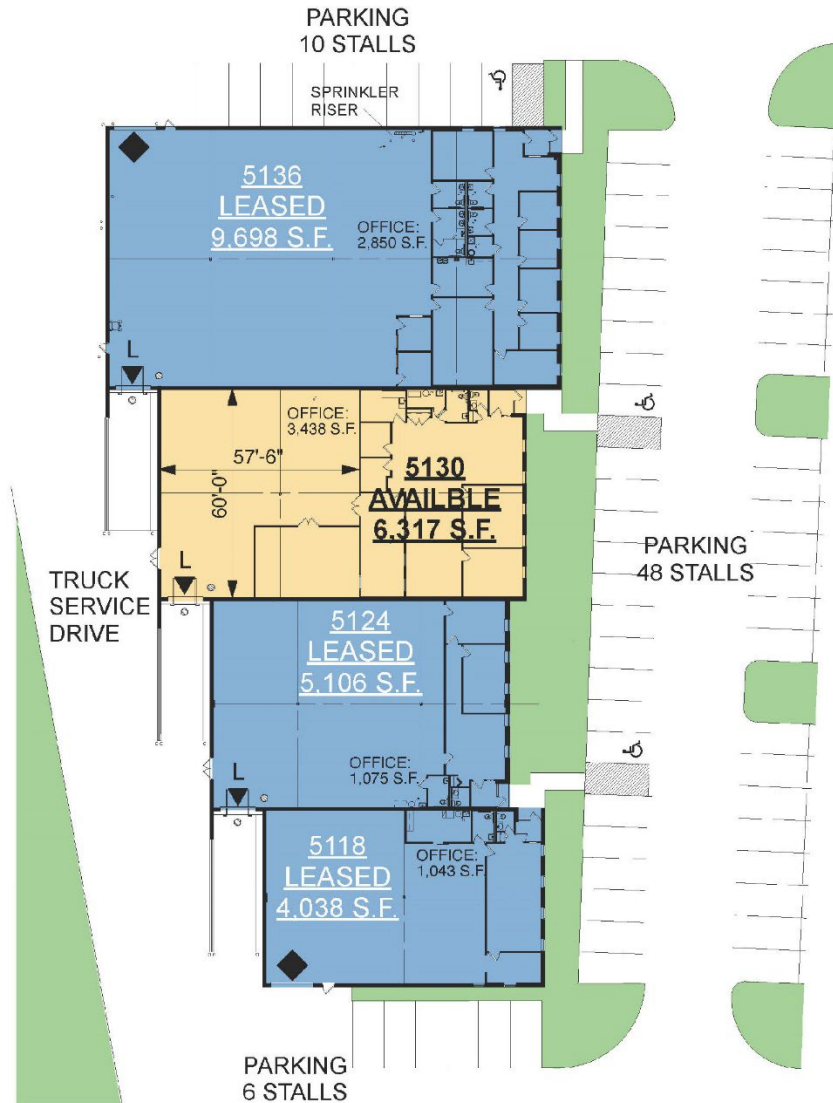

### NEWMARK

**Broker Name**

Tom Gath  
thomas.gath@nrmk.com  
ph +1 773 957 1415  
cell +1 847 942 9438  
8750 W. Bryn Mawr  
Suite 350  
Chicago, IL 60631 USA

**Prologis**

Brian Czarnecki  
bczarnecki@prologis.com  
ph +1 847 292 3852  
cell +1 203 979 1233  
6250 North River Road  
Suite 1100  
Rosemont, IL 60018 USA