

# 82,740 SF

## Industrial Space For Lease



## Prologis Park 100

1901 Park 100 Drive  
Glen Burnie, MD 21061

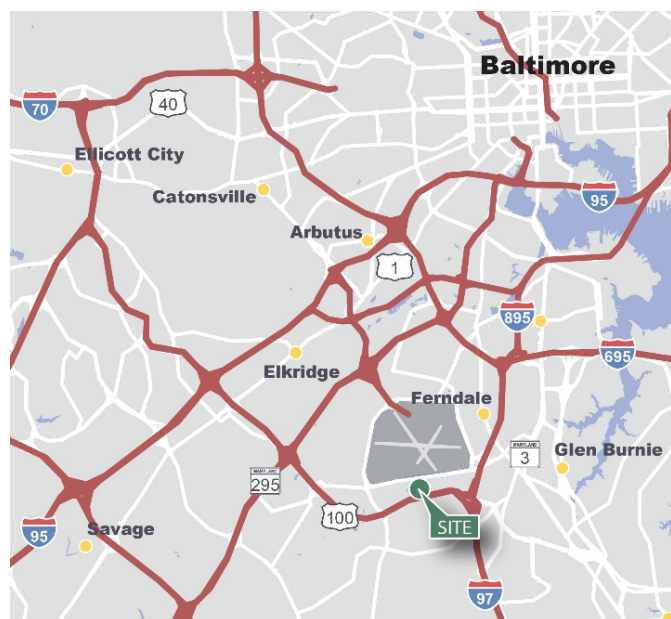

### LOCATION

- Easy access to Baltimore-Washington International Airport & Port of Baltimore
- Strategic Howard County location with convenient access to the Baltimore Washington Corridor, including BWI Airport

### FACILITY

- 82,740 SF available 12/1/21
- 12,487 SF existing office
- 26 dock doors
- 2 drive-ins
- 24' clear height
- 36' x 40' column spacing
- 115' Truck Court
- Wet sprinkler system
- LED lighting in warehouse & office

### ADVANTAGES & AMENITIES

- Fast, cost-effective forklift, racking, and other warehouse services sourced through Prologis Essentials. Prologis leverages it's global scale to provide your operations with high quality products and services from vetted vendors.

# 82,740 SF

## Industrial Space For Lease

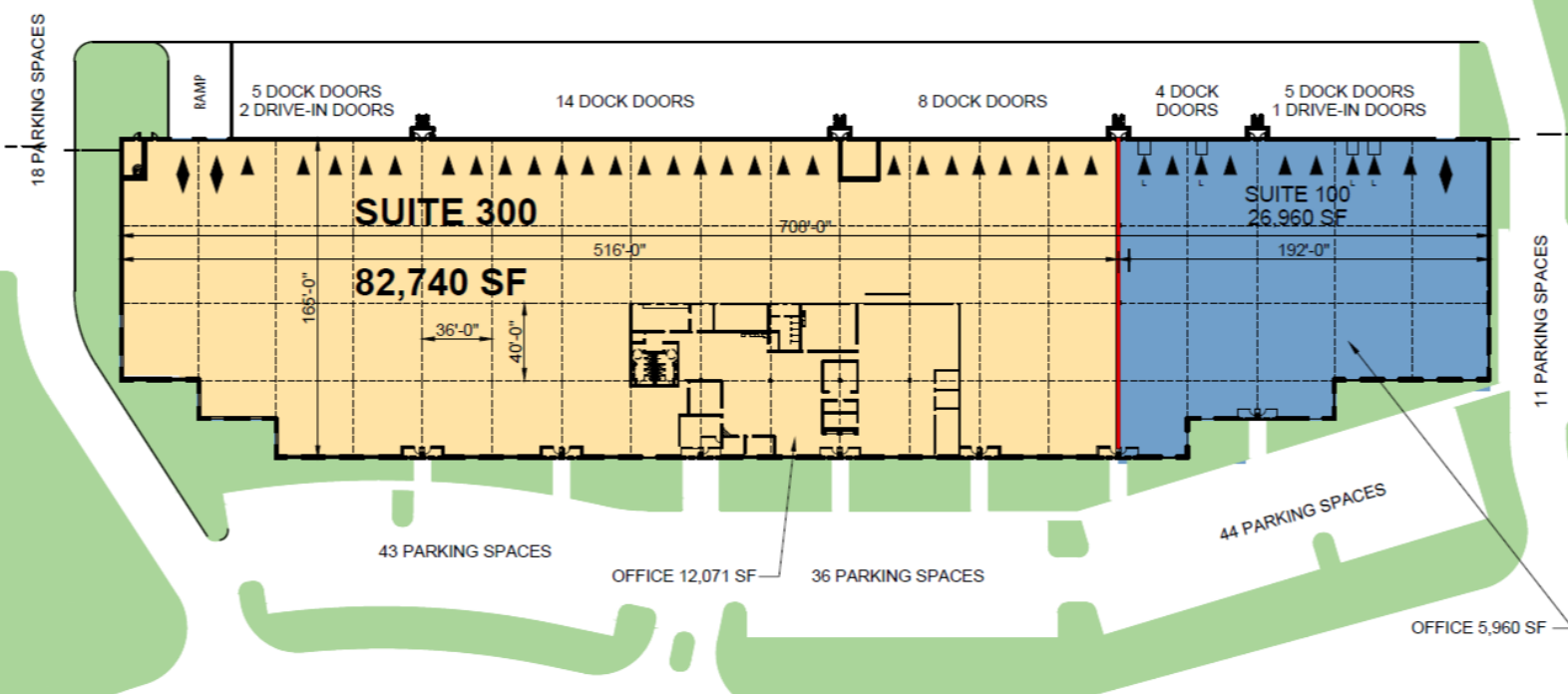

### LEGEND:

- ▲ DOCK POSITION
- ▲ DOCK POSITION W/LEVELER
- △ FUTURE DOCK POSITION
- ◆ DRIVE-IN DOOR
- LAND
- LEASED AREA
- AVAILABLE AREA



### Cushman & Wakefield

Jarred Testa

[Jarred.testa@cushwake.com](mailto:Jarred.testa@cushwake.com)

ph +1 410 953 6683

One East Pratt Street

Suite 700

Baltimore, MD 21202 USA

### Cushman & Wakefield

John Boote

[john.boote@cushwake.com](mailto:john.boote@cushwake.com)

ph +1 410 347 7567

One East Pratt Street

Suite 700

Baltimore, MD 21202 USA

### Prologis

Danielle Schline

[dschline@prologis.com](mailto:dschline@prologis.com)

ph +1 410 872 4570

6711 Columbia Gateway Drive

Suite 130

Columbia, MD 21046 USA