

# 140,400 SF

Industrial Space For Lease



## Prologis Hartsfield East



4380 International Parkway, Suite E-F  
Atlanta, GA 30354 USA

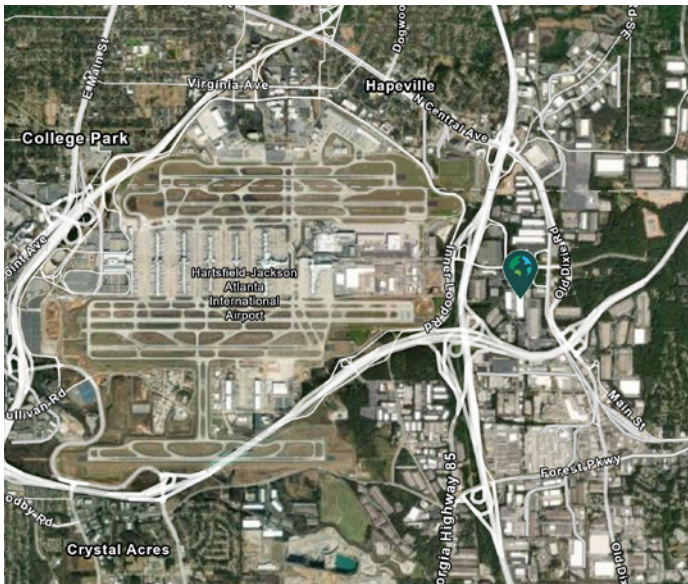

### LOCATION

- Immediate access to Hartsfield-Jackson Atlanta International Airport
- <1 mile from I-75
- ±1.9 miles from I-285
- ±9.8 miles from I-85
- Clayton County Tier 1 Tax Incentives

### FACILITY

- 140,400 SF available
  - 9,832 SF office
- 24' minimum clear height
- Twenty-eight (28) dock doors
  - Thirteen (13) with pit levelers
  - Seven (7) with edge of dock levelers
- One (1) drive-in door
- Sixty-eight (68) auto parking spaces
- 300' building depth
- 40' x 40' column spacing
- Power: 277/480V, 400A
- ESFR Sprinkler System

### ADVANTAGES AND AMENITIES

- Prologis Clear Lease® – Know your lease expenses and capital costs with greater certainty before you sign

**Your single-source service for efficient move-in and operations: [prologisessentials.com](https://www.prologisessentials.com)**



Scan the QR code for more info!

# 140,400 SF

Industrial Space For Lease



## Prologis Hartsfield East

28 DOCK DOORS; 13 W/ PIT LEVELERS & 7 W/ EOD  
1 DRIVE-IN DOOR

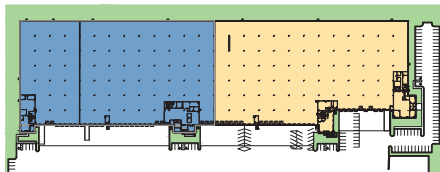
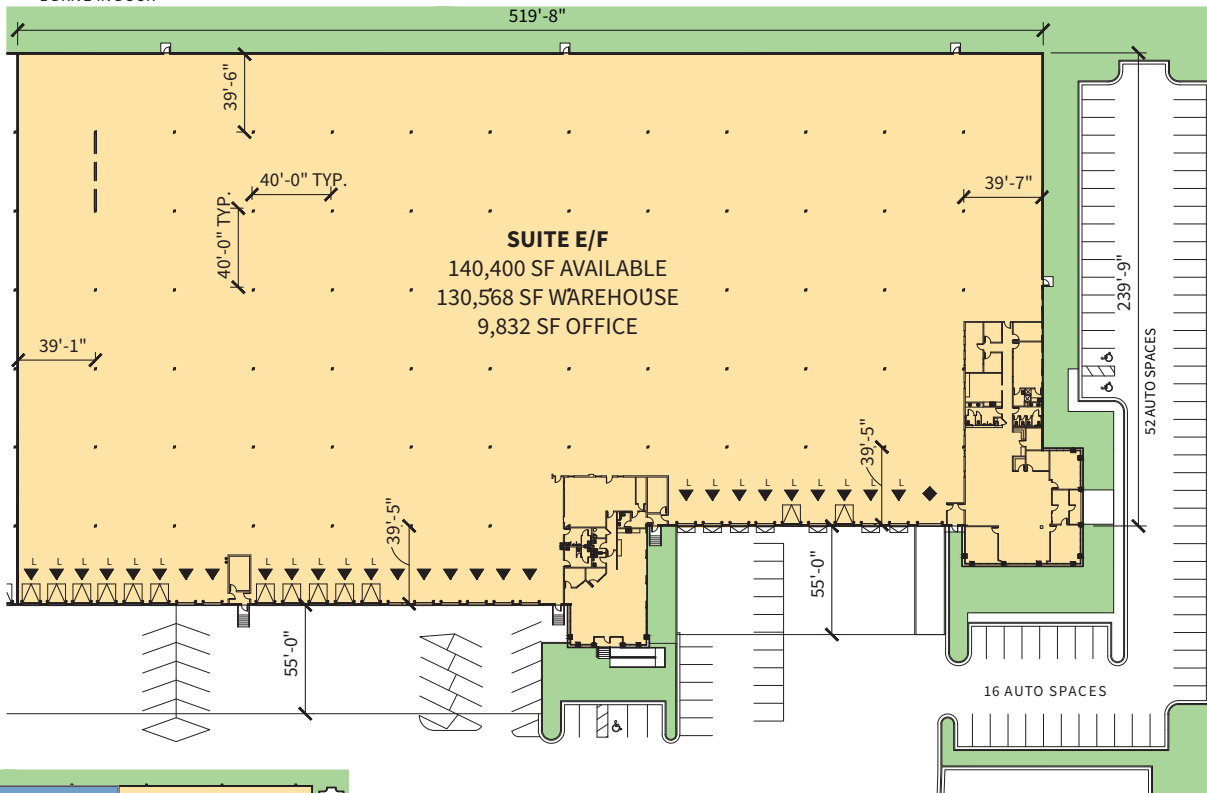

KEY PLAN

**LEGEND:**

- ▲ DOCK DOOR
- ▲ ON-GRADE DOOR
- LAND
- ▲ DOCK DOOR W/LEVELER
- ▨ EDGE OF DOCK LEVELER
- LEASED AREA
- ◆ DRIVE-IN DOOR
- ▨ PIT LEVELER
- VACANT AREA



**Seefried Industrial**

Joseph Kriss  
josephk@seefriedproperties.com  
ph +1 404 233 0204  
cell +1 678 362 4641  
3333 Riverwood Parkway SE  
Suite 200  
Atlanta, GA 30339 USA

**Seefried Industrial**

Tripp Ausband  
tausband@seefriedproperties.com  
ph +1 404 233 0204  
cell +1 770 825 3391  
3333 Riverwood Parkway SE  
Suite 200  
Atlanta, GA 30339 USA

**Prologis**

Cassie Hanavich  
chanavich@prologis.com  
ph +1 404 760 7256  
cell +1 404 449 5356  
3350 Peachtree Road  
Suite 850  
Atlanta, Georgia 30326 USA