

# ±90,986 SF



## Warehouse/Office Space For Lease



## Prologis SFO 6

245 Spruce Avenue, Suite 200  
South San Francisco, CA 94080



### LOCATION

- 4.9 Miles (9 Minutes) to San Francisco International Airport
- 11.7 Miles (18 Minutes) to Port of San Francisco
- 11 Miles (17 Minutes) to Downtown San Francisco
- 1.7 Miles (5 Minutes) to CalTrain
- 4 Miles (8 Minutes) to BART Station

### BUILDING HIGHLIGHTS

- ±87,940 SF Total Warehouse Available
- ±3,046 SF Office Available
- Four (4) Dock-High Doors
- 18' Clear Height
- Sprinklers

# ±90,986 SF



## Warehouse/Office Space For Lease

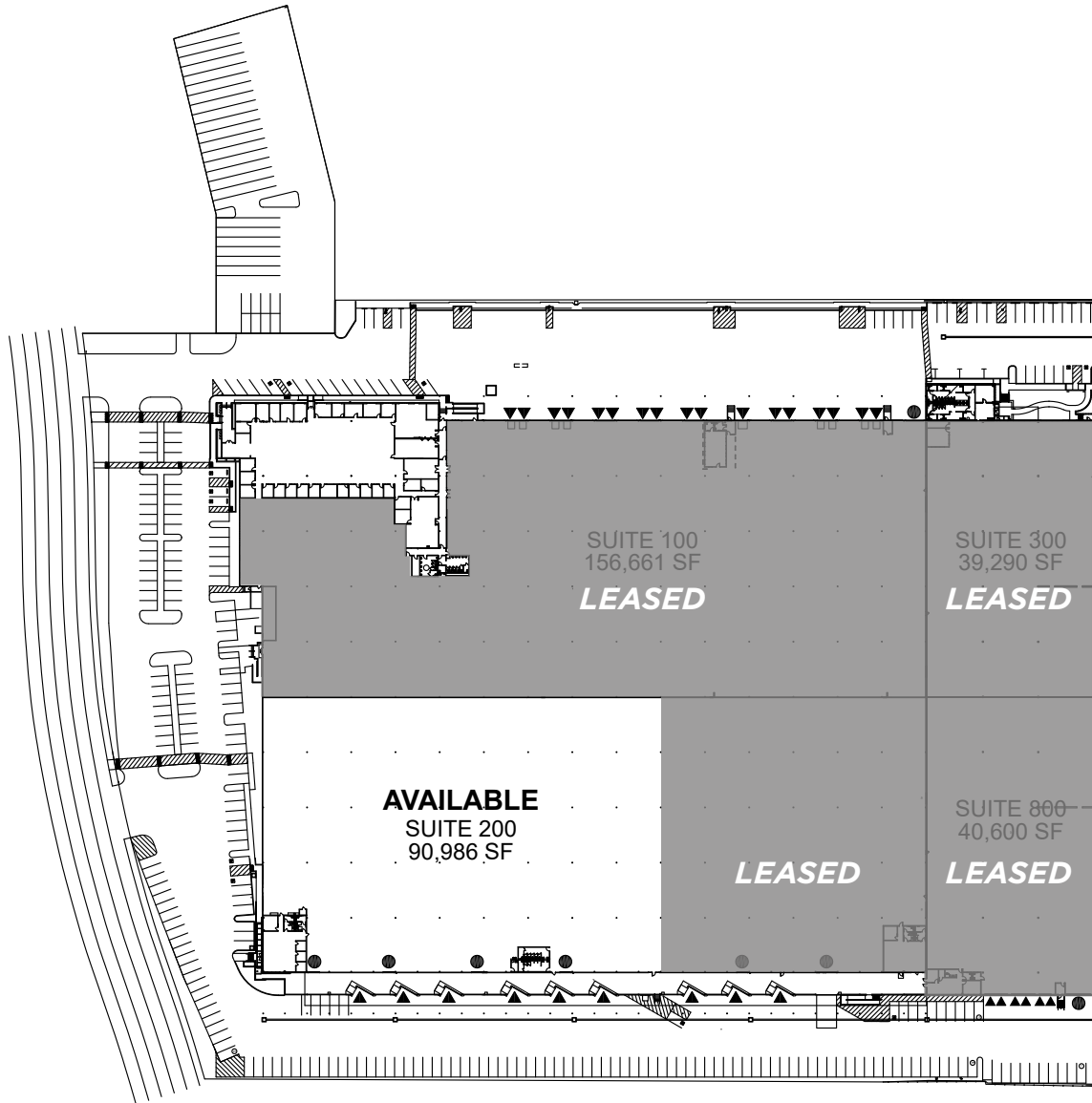

OFFICE APPROX: 3,046 SF  
WAREHOUSE: 87,940 SF  
TOTAL AVAILABLE: 90,986 SF

**LEGEND**  
▲ DOCK DOOR  
● DRIVE-IN DOOR



**Matt Squires**  
Cushman & Wakefield  
matt.squires@cushwake.com  
ph +1 650 401 2136  
RE Lic: 01248804



**Randy Keller**  
Principal - Managing Director  
randy.keller@cushwake.com  
ph +1 650 425 6425  
RE Lic: 00841897



**Amy Pallas**  
Prologis  
APallas@prologis.com  
ph +1 510 661 4087  
RE Lic: 00935272

# ± 90,986 SF



## Warehouse/Office Space For Lease

### Transportation

245 Spruce Ave is conveniently located right off Hwy 101. It can easily be reached via car, however there a number of public transportation as well.

The San Bruno BART Station and the Tanforan SamsTran Station are both just minutes away.

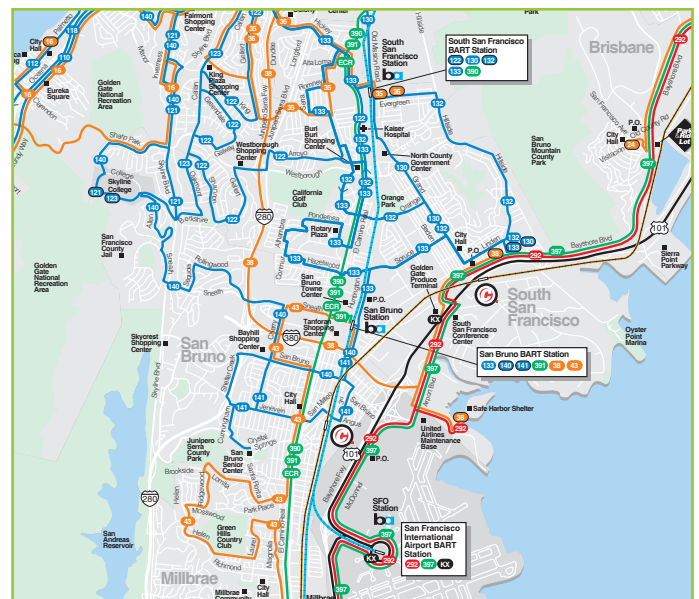
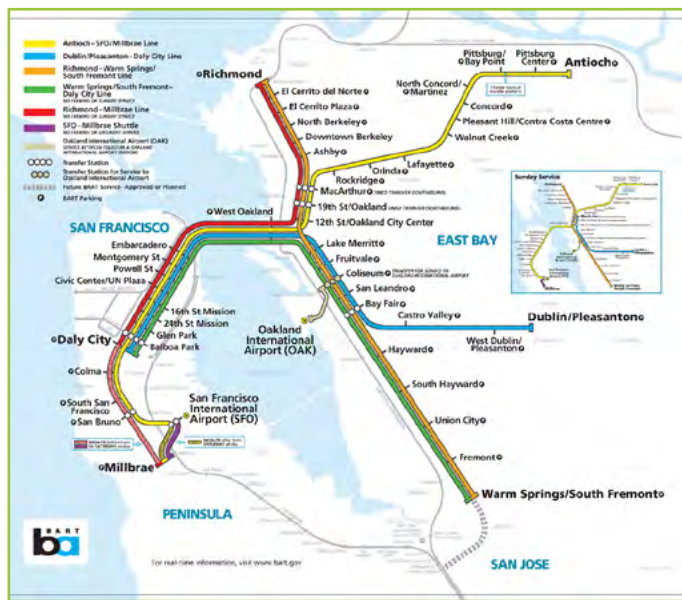

**Matt Squires**  
Cushman & Wakefield  
matt.squires@cushwake.com  
ph +1 650 401 2136  
RE Lic: 01248804



**Randy Keller**  
Principal - Managing Director  
randy.keller@cushwake.com  
ph +1 650 425 6425  
RE Lic: 00841897



**Amy Pallas**  
Prologis  
APallas@prologis.com  
ph +1 510 661 4087  
RE Lic: 00935272

# GO BEYOND THE BUILDING

**Prologis Essentials** is the single source for warehouse solutions to keep facilities running at a high level of efficiency. Our offerings are easy and convenient to procure and implement, providing support for move-in, moving forward, and growing any business.

## MATERIAL HANDLING

- A. Racking & Shelving
  - I. Layout and Design
  - II. New and Used Material
  - III. Permitting Services
  - IV. Buybacks and Liquidations
- B. Forklifts
  - I. Electric and Propane
  - II. New, Used, and Refurbished
  - III. Rentals
  - IV. Service



## ENERGY

- A. Solar
- B. LED Lighting
- C. EV Charging
- D. Generators



## AUTOMATION/ ADVANCED SOLUTIONS

- A. Conveyor and Sortation
- B. Locus Robotics
- C. VLMs, Shuttles, Carousels, AS/RS
- D. Pick Modules/Mezzanine



## SMART BUILDING

- A. Fiber Backbone
- B. Network and Cabling
- C. Internet Service
- D. Access Points
- E. Security Cameras and Monitoring Services
- F. Badge Access and Control
- G. Barcode Scanning



## PRODUCTS AND SERVICES

- A. Moving and Relocation Services
- B. HVLS Fans
- C. Office Furniture
- D. In-Plant Modular Offices
- E. Yard Ramps
- F. Janitorial Service
- G. Pest Control



**John Kenley**  
Essentials Solutions Manager  
jkenley@prologis.com  
415-733-9402

 **PROLOGIS**<sup>®</sup>  
ESSENTIALS  
[www.prologisessentials.com](http://www.prologisessentials.com)