

# 128,278 SF

## Industrial Space For Lease



### Prologis Monroe | 2 South Middlesex Avenue



2 South Middlesex Avenue  
Monroe, NJ 08831 USA

#### LOCATION

- Immediate access to Route 130 and NJ Turnpike Exit 8A
- ± 30 miles from Newark Liberty International Airport and Port-Newark Elizabeth
- ± 50 miles from New York City and Philadelphia

#### FACILITY

- 218,088 SF total building size
- 128,278 SF space available
- 1,970 SF office
- 24' clear height
- 50' x 40' column spacing
- 14 dock positions
- 1 drive-in door
- 6 rail doors
- 32 car parking spaces
- 11 trailer parking spaces
- 400 amps, 480/277v, 3-phase electrical service

#### ADVANTAGES AND AMENITIES

- Fast, cost-effective forklift and racking sourcing through Prologis Essentials
- Prologis Clear Lease® – Know your lease expenses and capital costs with greater certainty before you sign

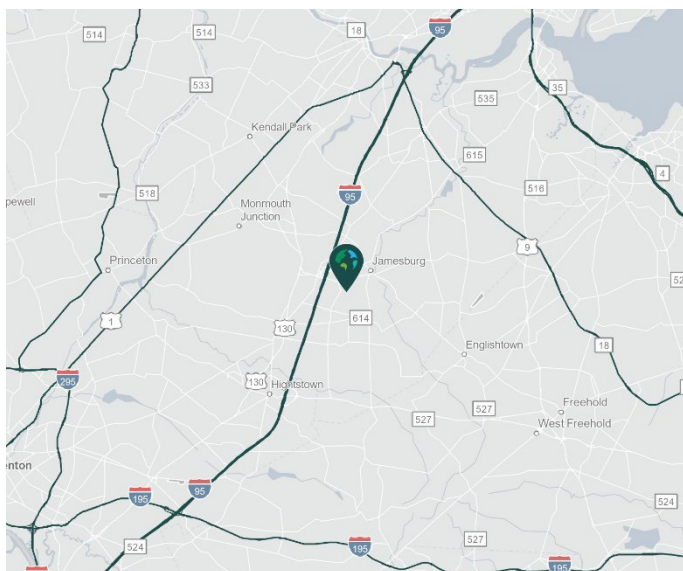

**Your single-source service for efficient move-in  
and operations: [prologisessentials.com](https://www.prologisessentials.com)**

[www.prologis.com](https://www.prologis.com)

# 128,278 SF

## Industrial Space For Lease



### Prologis Monroe | 2 South Middlesex Avenue

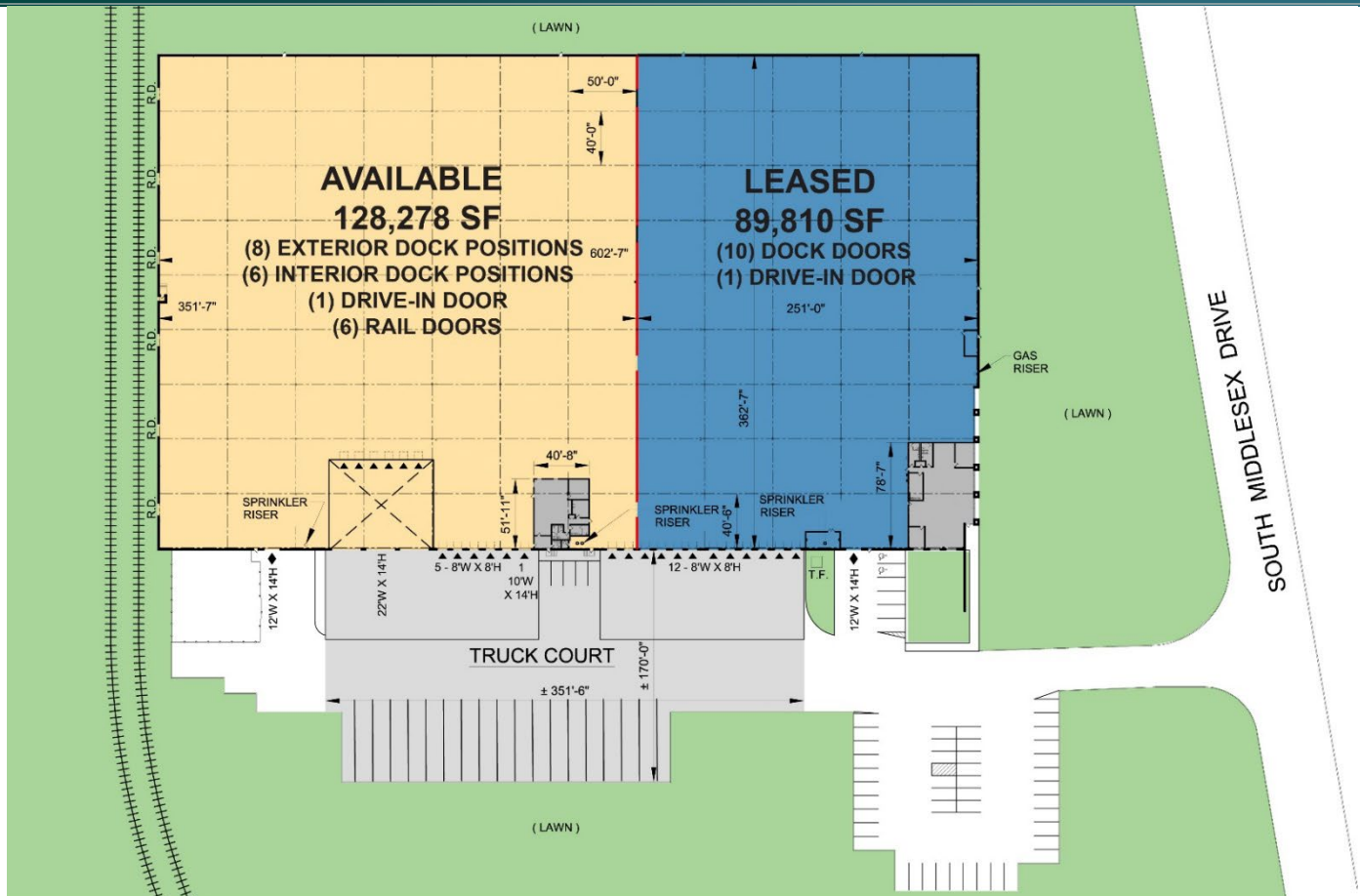

- LAND
- LEASED
- AVAILABLE
- ▲ DOCK DOOR
- ◆ DRIVE-IN DOOR

## CBRE

### CBRE, Inc.

Thomas F. Monahan  
thomas.monahan@cbre.com  
ph +1 201 712 5610  
cell +1 973 568 6614  
Park 80 West  
Plaza Two  
Saddle Brook, NJ 07663 USA

### CBRE, Inc.

Brian Golden  
brian.golden@cbre.com  
ph +1 201 712 5607  
cell +1 732 283 8451  
Park 80 West  
Plaza Two  
Saddle Brook, NJ 07663 USA

### CBRE, Inc.

Larry Schifffenhaus  
larry.schifffenhaus@cbre.com  
ph +1 201 712 5809  
cell +1 201 532 5092  
Park 80 West  
Plaza Two  
Saddle Brook, NJ 07663 USA

### Prologis

Paul Rosen  
prosen@prologis.com  
ph +1 201 635 6013  
cell +1 201 306 1332  
One Meadowlands Plaza  
Suite 100  
East Rutherford, NJ 07073 USA