

195,000 SF

Industrial Space For Lease



Prologis Port Baltimore



6300 Beckley Street
Baltimore, MD 21224 USA

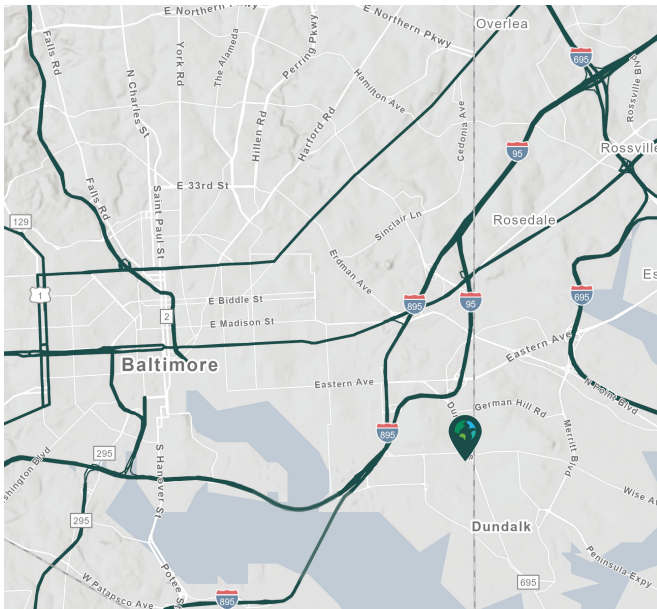

LOCATION

- Immediate access to I-95
- Immediate access to the Port of Baltimore
- Multi-market accessibility to Baltimore, Philadelphia, and Washington, D.C.

FACILITY

- 195,000 SF available
- 3,457 SF office space
- Available November 2024
- 26' clear height
- 42-6' x 38-4' column spacing
- 23 dock doors; 18 with levelers; 5 with edge-of-docks
- 2 drive-in doors
- 23 trailer drops
- 74 parking spaces
- 1,200 amps; 277-480v electric service
- LED lighting
- Foreign Trade Zone #74

ADVANTAGES AND AMENITIES

- Prologis Clear Lease® – Know your lease expenses and capital costs with greater certainty before you sign.
- Fast, cost-effective forklift and racking sourcing through Prologis Essentials

Prologis Essentials: your single-source service for efficient move-in and operations at prologisessentials.com

www.prologis.com

195,000 SF

Industrial Space For Lease



Prologis Port Baltimore

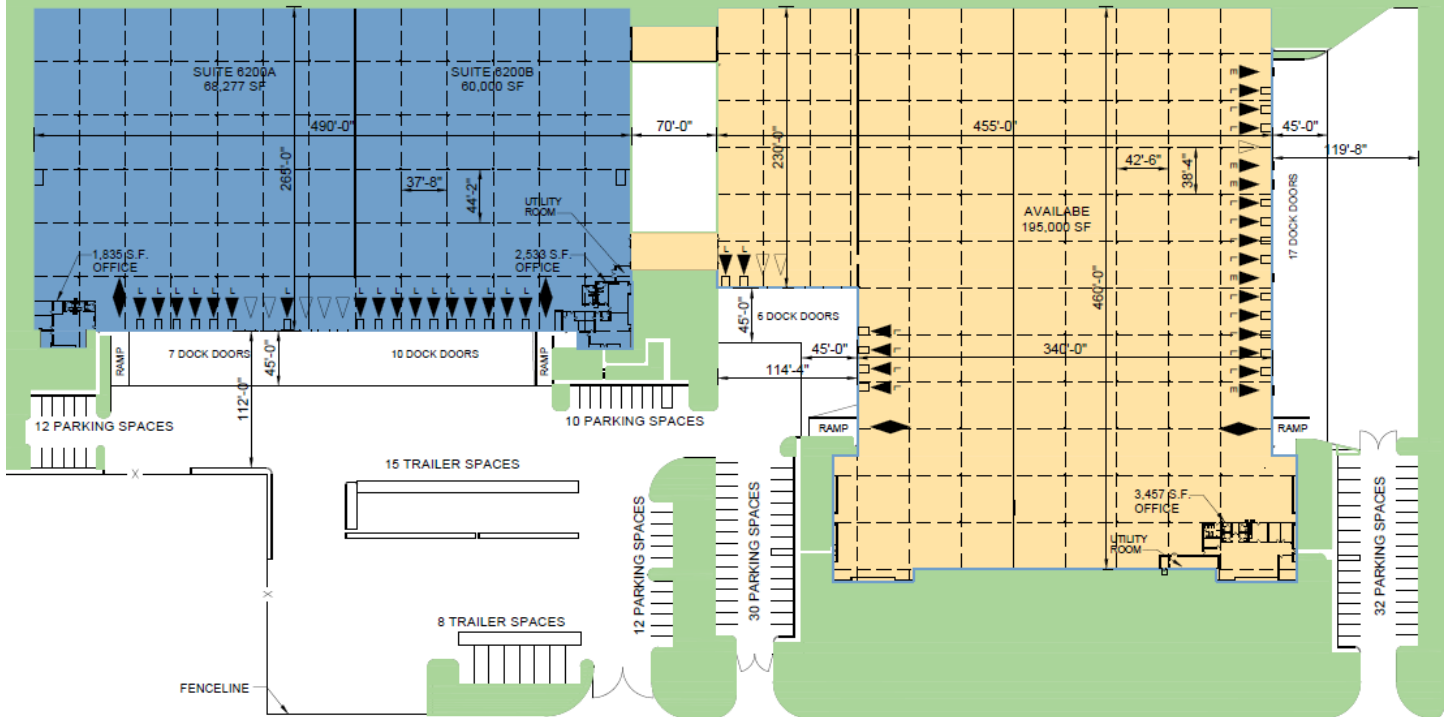

LEGEND:

- ▲ DOCK POSITION
- ▲ DOCK POSITION W/LEVELER
- ▲ DOCK POSITION W/WEDGE OF DOCK LEVELER
- R TRAILER RESTRAINT
- △ FUTURE DOCK POSITION
- ◆ DRIVE-IN DOOR
- LAND
- LEASED AREA
- AVAILABLE AREA

CBRE

CBRE, Inc.

Jon Casella
jonathan.casella@cbre.com
ph +1 410 244 3127
100 E. Pratt Street
Suite 1700
Baltimore, MD 21202 USA

CBRE, Inc.

Toby Mink
toby.mink@cbre.com
ph +1 410 244 3171
100 E. Pratt Street
Suite 1700
Baltimore, MD 21202 USA

CBRE, Inc.

Bill Pellington
bill.pellington@cbre.com
ph +1 410 244 3137
100 E. Pratt Street
Suite 1700
Baltimore, MD 21202 USA

Prologis

Karen Cherry
kcherry@prologis.com
ph +1 410 872 4560
6721 Columbia Gateway Drive
Suite 150
Columbia, MD 21046 USA

Prologis Essentials: your single-source service for efficient move-in and operations at prologisessentials.com

No warranty or representation, expressed or implied, is made as to the accuracy of the information contained herein, and same is submitted subject to error and omissions.