

# ±7,572 SF

## Office/Warehouse Space For Lease



## Prologis North San Jose

2300 Zanker Rd, Unit D  
San Jose, CA 95131

### LOCATION

- Prominent Location in Heart of Silicon Valley
- Convenient Access to Highway 101 and Interstate 880
- Close Proximity to San Jose Airport

### FACILITY

- ±1,941 SF Office
- ±5,631 SF Warehouse
- 1 Grade Door
- 17' Clear Height
- Available Q4 2021

### ADVANTAGES AND AMENITIES

- Retail and Food Amenities Located Nearby on E. Brokaw Road and N. 1st Street

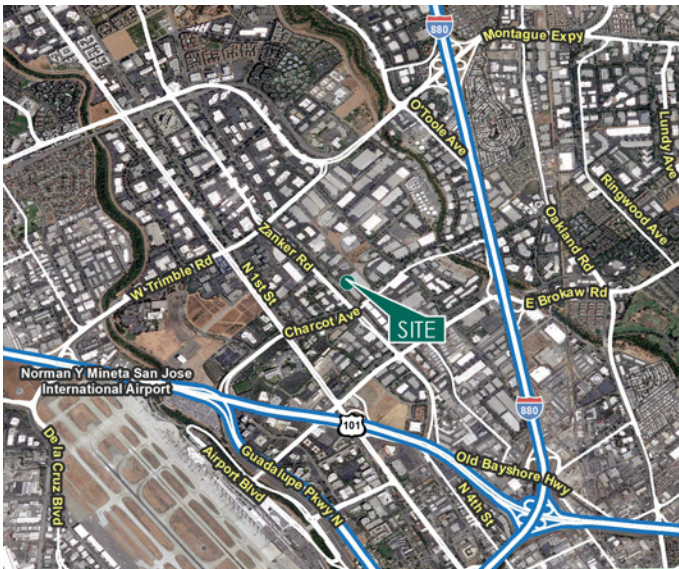

# ±7,572 SF

## Office/Warehouse Space For Lease

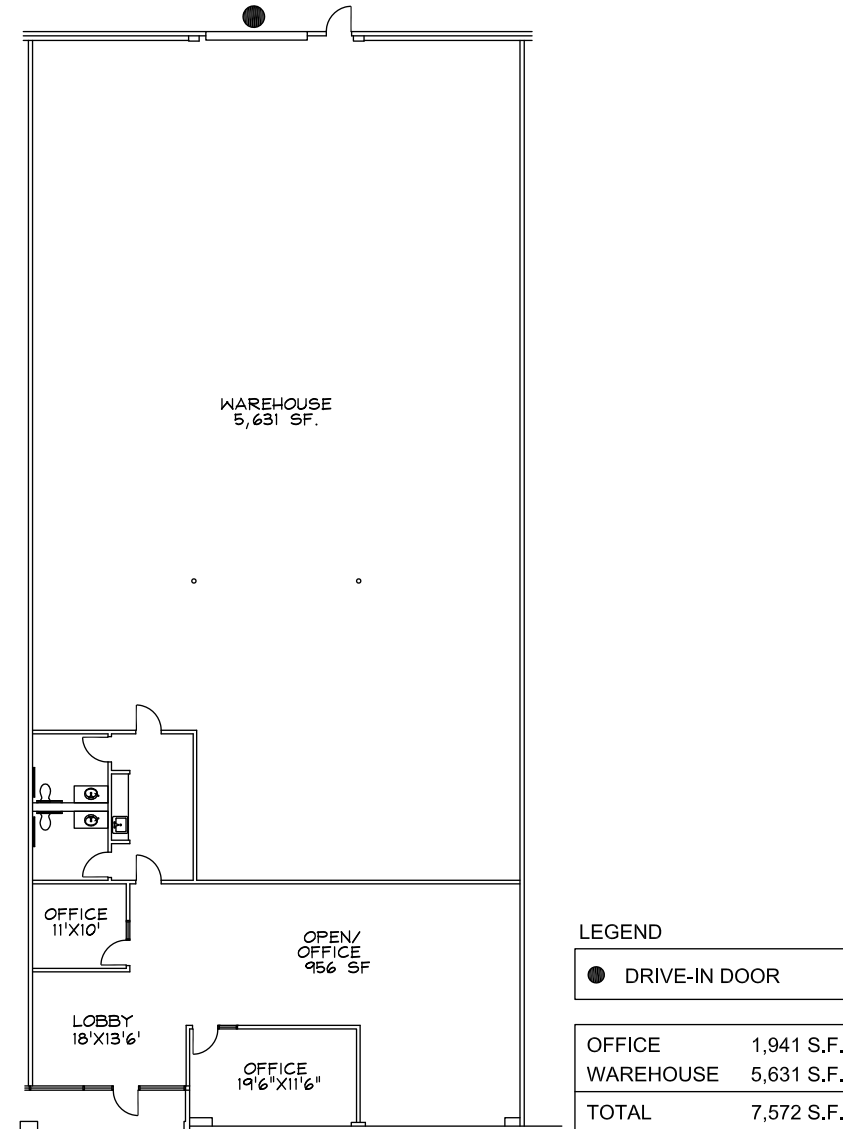

FOR MORE INFORMATION PLEASE CONTACT:

**CBRE**  
**Brian Matteoni**  
brian.matteoni@cbre.com  
ph +1 408 453 7407  
225 W. Santa Clars St. 12th Floor  
San Jose, CA 95113 USA  
Lic. 00917296

**Prologis**  
**Reyn Kimura**  
rkimura@prologis.com  
ph +1 510 661 4003  
3353 Gateway Boulevard  
Fremont, CA 94538 USA  
Lic. 02037886



www.prologis.com www.cbre.us  
CalDRE Lic #01944561

© 2021 CBRE, Inc. All rights reserved. This information has been obtained from sources believed reliable, but has not been verified for accuracy or completeness. You should conduct a careful, independent investigation of the property and verify all information. Any reliance on this information is solely at your own risk.