

# 62,200 SF

**245 West Commercial Avenue  
Moonachie, NJ 07074**

Prologis Meadowlands

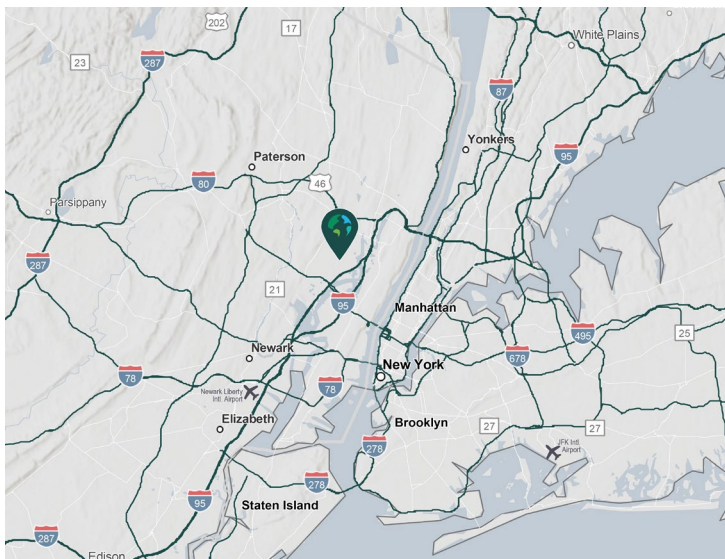

- Immediate access to NJ Turnpike Exit 16W, Interstate 80, Route 3, Route 17, and Route 46
- ± 5 miles to Lincoln Tunnel
- ± 15 miles from Newark Liberty International Airport and Port Newark-Elizabeth

## Property Features

<b>Available Space</b>	62,200 SF
<b>Office SF</b>	5,227 SF
<b>Clear Height</b>	20'
<b>Column Spacing</b>	31'8" x 35'6"
<b>Dock Doors</b>	8
<b>Car Parking Spaces</b>	43
<b>Electrical Service</b>	2,500 amps, 120/280v
<b>Lighting</b>	LED Motion Sensor



Unlock the full potential of your warehouse with one strategic, single-source partner.

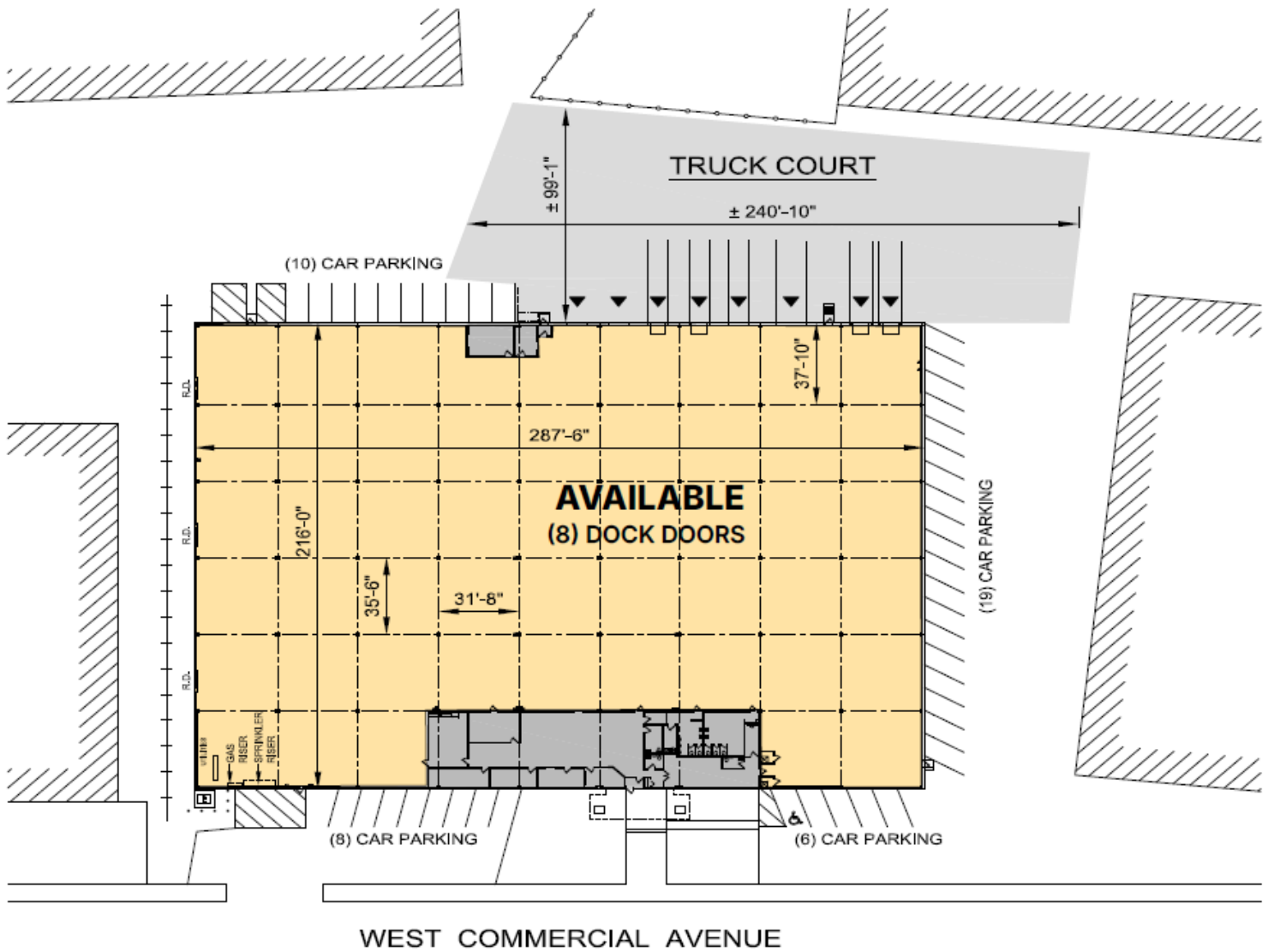

- ▲ DOCK POSITION
- ◆ DRIVE-IN DOOR



**JLL**  
**Chris Hile**  
 chris.hile@jll.com  
 ph +1 201 528 4416

**JLL**  
**Michael Palmeri**  
 michael.palmeri@jll.com  
 ph +1 201 528 4420

**JLL**  
**Harold Imperatore**  
 harold.imperatore@jll.com  
 ph +1 201 528 4430

**Prologis**  
**Sarah Rutherford**  
 srutherford@prologis.com  
 ph +1 201 528 9576  
 prologis.com