

# 5,948 SF

## Industrial Space For Lease

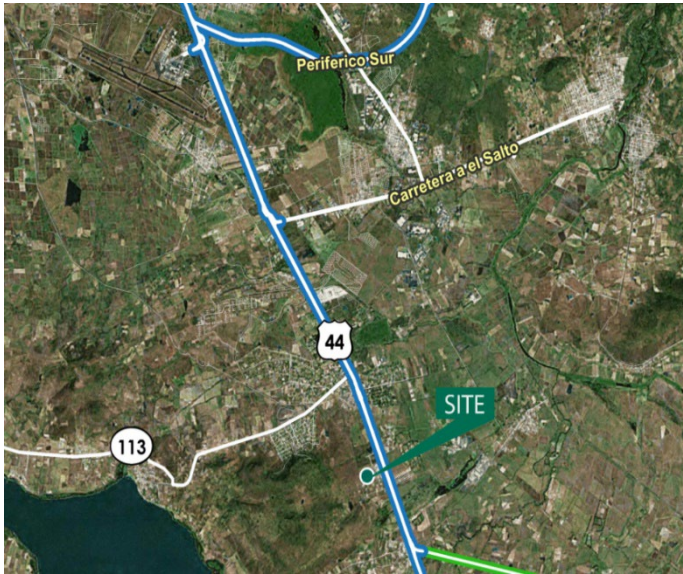

## Prologis Park Arrayanes.

Carretera Guadalajara – Chapala Km. 24.5  
Tlajomulco de Zuñiga, Jalisco. 45670 Mexico.

### LOCATION

- Prologis Park Arrayanes Building 1.
- Located in Chapala-Airport Industrial Corridor.
- 11 km from Guadalajara International Airport.
- 3 km from access to Macrolibramiento.

### FACILITY

- Available area: 5,948 SF / 552 SM  
Back Office Space

### ADVANTAGES AND AMENITIES

- 24/7 Security.
- Strategic location for business.
- Accessibility and parking.

# 5,948 SF

## Industrial Space For Lease

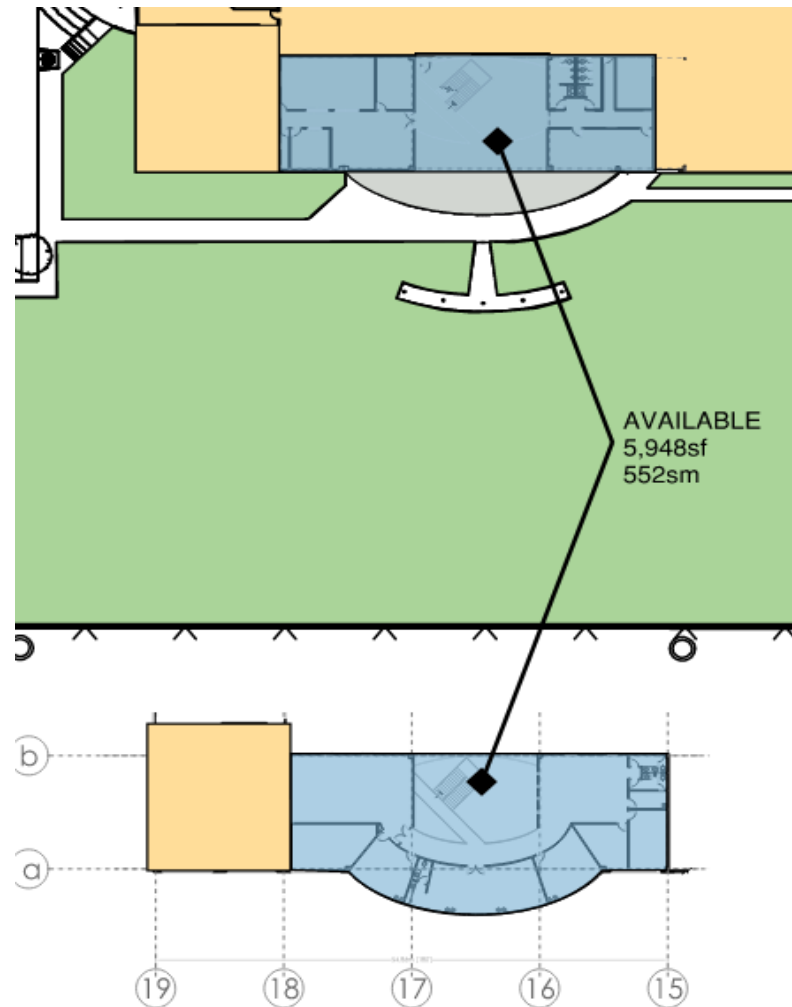

Prologis

Beatriz Baez

bbaez@prologis.com

ph +52 (33) 3134.5453

Av. Camino al Iteso 8900

Tlaquepaque, Jalisco

45080 Mexico