

24,045 SF

Industrial Space For Lease



Prologis Meadowlands | 80 Hancock Street



80 Hancock Street
Lodi, NJ 07644 USA

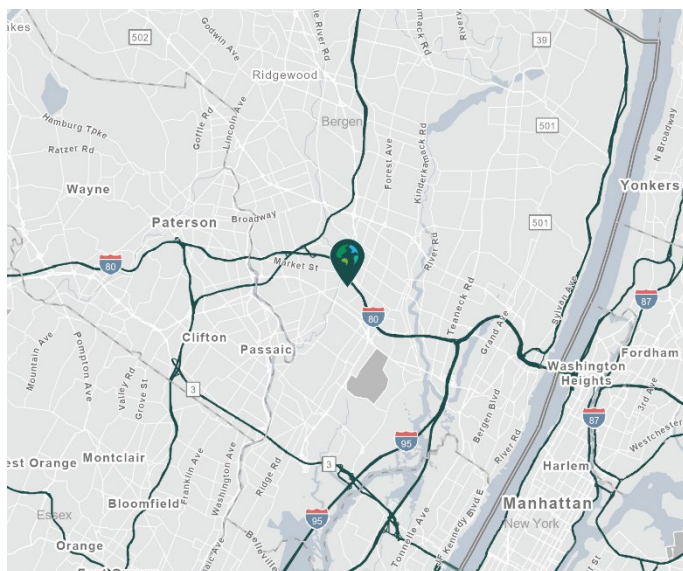

LOCATION

- Immediate access to I-80, Route 17, and Route 46
- ± 20 miles from Newark Liberty International Airport
- ± 21 miles from Port Newark-Elizabeth

FACILITY

- 24,045 SF total building size
- 24,045 SF available space
- 4,285 SF office
- 14'-6" clear height
- 25' x 39'-3" column spacing
- 6 dock doors
- 1 drive-in door
- ± 1 additional acre of paved area onsite

ADVANTAGES AND AMENITIES

- Fast, cost-effective forklift and racking sourcing through Prologis Essentials
- Prologis Clear Lease® – Know your lease expenses and capital costs with greater certainty before you sign

Your single-source service for efficient move-in and operations: [prologisessentials.com](https://www.prologisessentials.com)

24,045 SF

Industrial Space For Lease



Prologis Meadowlands | 80 Hancock Street

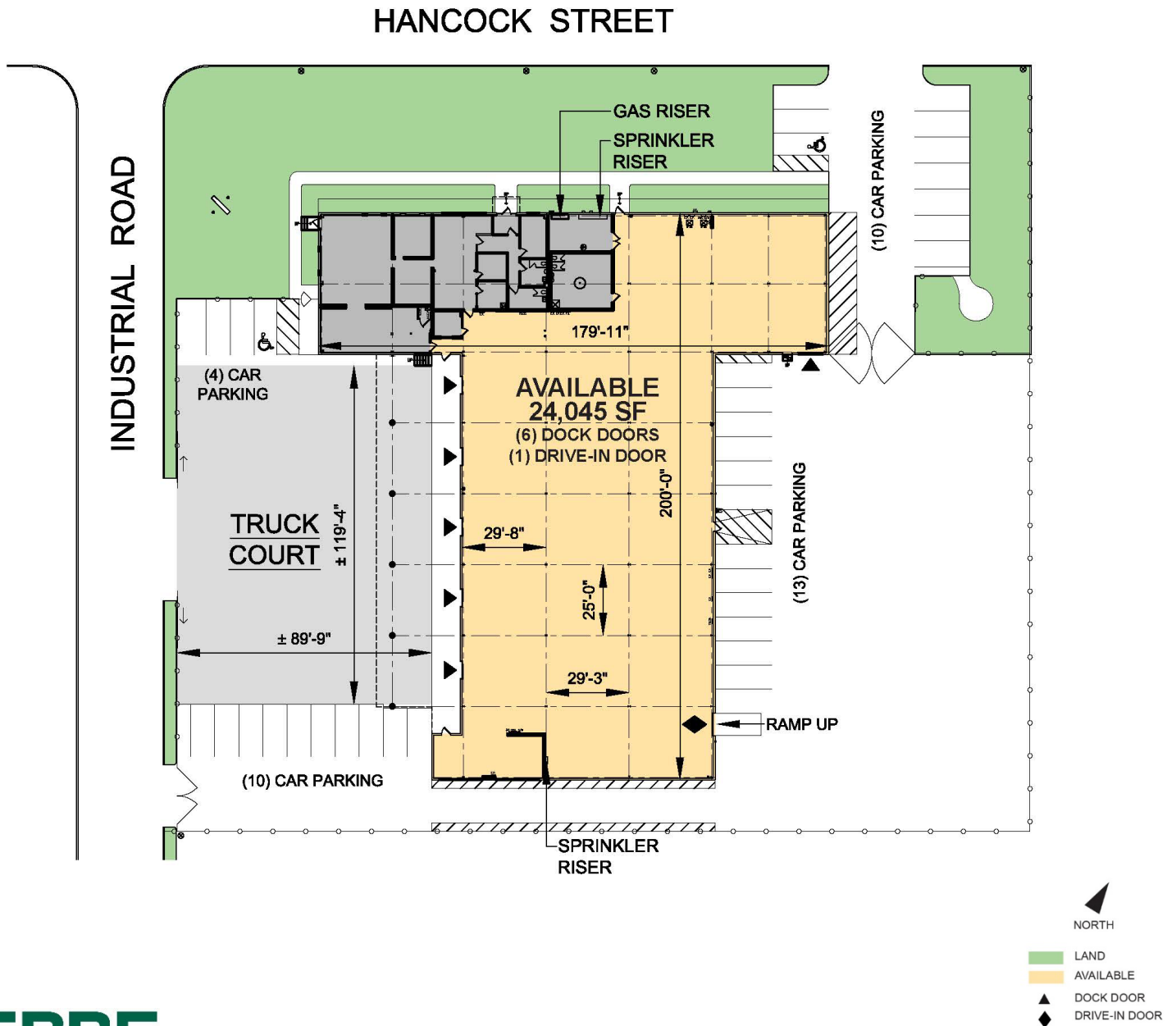

CBRE, Inc.

Kevin Dudley
kevin.dudley@cbre.com
ph +1 201 712 5837
cell +1 914 714 0128
250 Pehle Avenue
Suite 600
Saddle Brook, NJ 07663 USA

CBRE, Inc.

Nicholas Klacik
nicholas.klacik@cbre.com
ph +1 201 712 5615
cell +1 330 507 2145
250 Pehle Avenue
Suite 600
Saddle Brook, NJ 07663 USA

CBRE, Inc.

Chad Hillyer
chad.hillyer@cbre.com
ph +1 201 712 5655
cell +1 908 337 7201
250 Pehle Avenue
Suite 600
Saddle Brook, NJ 07663 USA

Prologis

Sarah Rutherford
srutherford@prologis.com
ph +1 201 528 9576
cell +1 551 206 6985
One Meadowlands Plaza
Suite 100
East Rutherford, NJ 07073 USA