

**PROLOGIS
MEADOWLANDS**

300-330 MURRAY HILL PARKWAY
EAST RUTHERFORD, NJ 07073

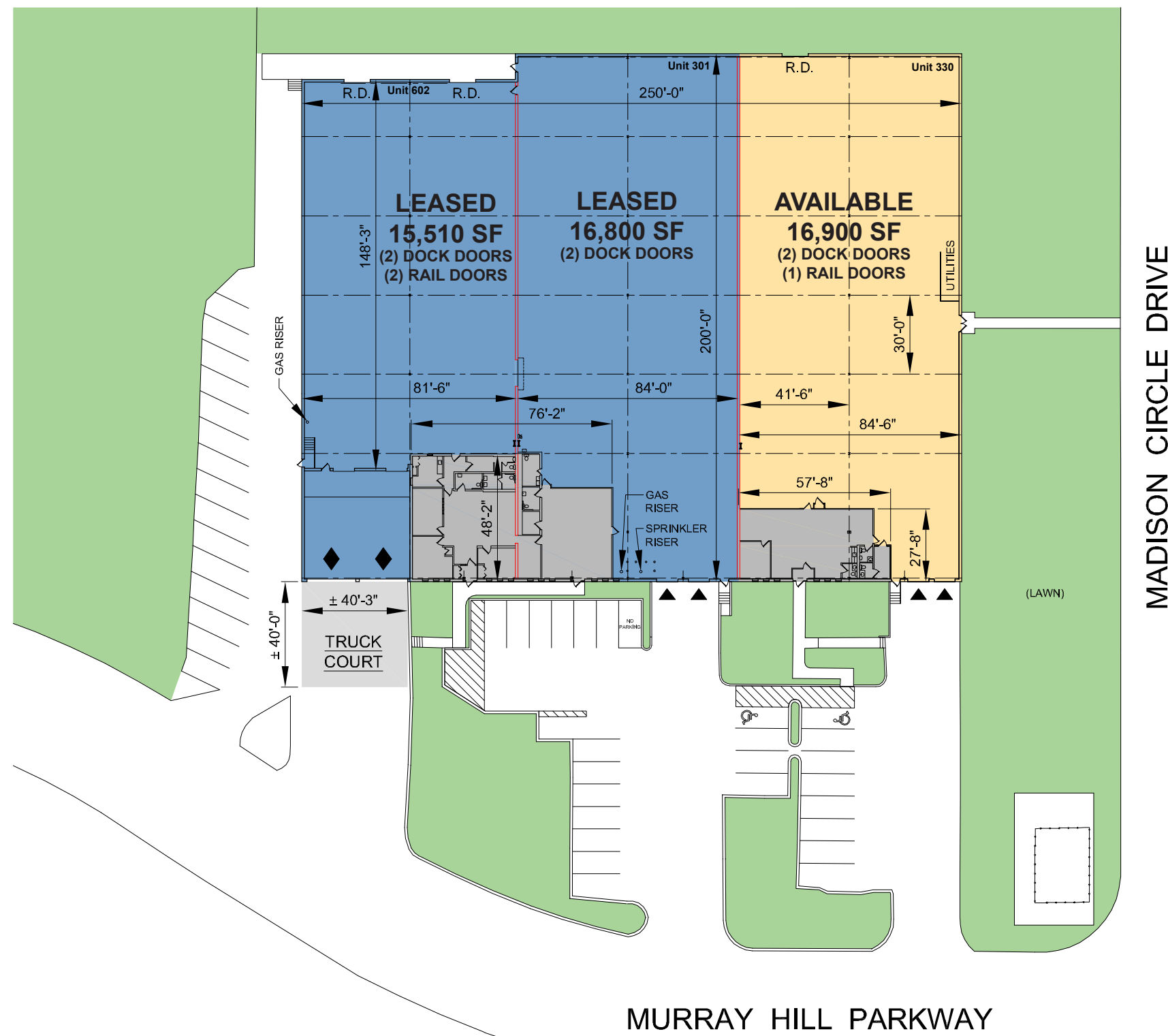

MADISON CIRCLE DRIVE

MURRAY HILL PARKWAY

TOTAL FOOTPRINT:	49,210 S.F.
OFFICE:	4,855 S.F.
WAREHOUSE:	44,355 S.F.
PERCENTAGE OFFICE:	10%
CLEAR HEIGHT:	20'-0"
PARKING:	41 STALLS
DOCK-HIGH DOORS:	4
DRIVE-IN DOORS:	2
RAIL DOORS:	3
TYPICAL BAY:	30'-0" x 41'-6"

- NORTH
- LAND
- AVAILABLE
- LEASED
- DOCK DOOR
- DRIVE-IN DOOR

SUITE 602:	15,510 S.F.
OFFICE:	1,925 S.F.
WAREHOUSE:	13,585 S.F.
PERCENTAGE OFFICE:	12%
CLEAR HEIGHT:	20'-0"
PARKING:	14 STALLS
DOCK-HIGH DOORS:	0
DRIVE-IN DOORS (RAMPED):	2
RAIL DOORS:	2
TYPICAL BAY:	30'-0" x 41'-6"

SUITE 301:	16,800 S.F.
OFFICE:	1,425 S.F.
WAREHOUSE:	15,375 S.F.
PERCENTAGE OFFICE:	8%
CLEAR HEIGHT:	20'-0"
PARKING:	14 STALLS
DOCK-HIGH DOORS:	2
DRIVE-IN DOORS (RAMPED):	0
RAIL DOORS:	0
TYPICAL BAY:	30'-0" x 41'-6"

SUITE 330:	16,900 S.F.
OFFICE:	1,505 S.F.
WAREHOUSE:	15,395 S.F.
PERCENTAGE OFFICE:	9%
CLEAR HEIGHT:	20'-0"
PARKING:	13 STALLS
DOCK-HIGH DOORS:	2
DRIVE-IN DOORS (RAMPED):	0
RAIL DOORS:	1
TYPICAL BAY:	30'-0" x 41'-6"

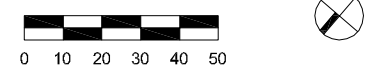

The above information/drawing is for reference only and is subject to verification, and/or revision. No liability for omissions shall be assumed. Area calculations are approximate and subject to change without notice.

© COPYRIGHT 2020 PARETTE SOMERIT ARCHITECTS LLC - DATABASE: PR 2020-11-09