

116,205 SF

Industrial Space For Lease



Prologis Sierra Business Park 4



10851 Sierra Avenue
Fontana, CA 92337 USA

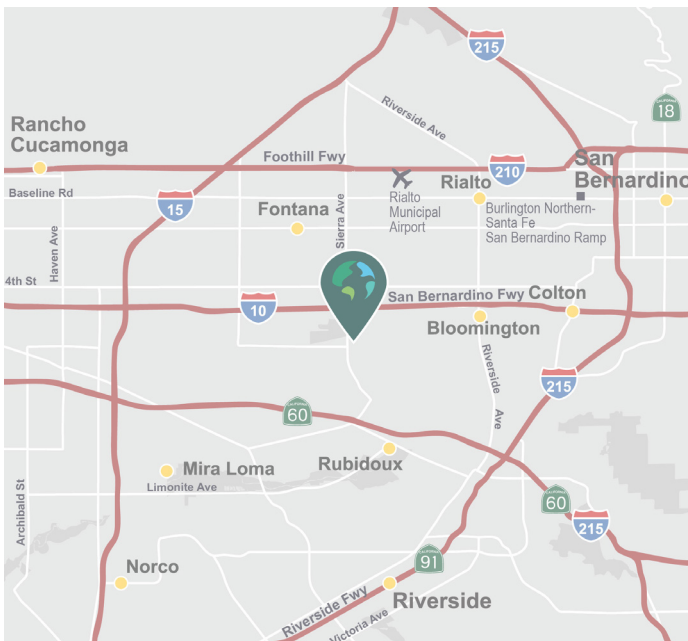

LOCATION

- Immediate access to I-10, I-15, and CA-60 freeways
- Minutes from the Ontario International Airport
- Excellent location that serves the entire Los Angeles basin

FACILITY

- 116,205 sf Available
- 2,893 sf office space
- 2,698 sf mezzanine space
- 32' Clear height
- 2.5% Skylights
- 52' x 50' Column spacing (typical)
- 16 (8' 6" x 10') Dock high doors
- 2 (12' x 14') Drive-in doors
- 130' Secured concrete truck court
- ESFR Overhead sprinkler system
- 121 Auto parking stalls
- LED office and warehouse lighting
- 2 HVLS warehouse fans
- 800 Amps, 277/480V
- Pre-positioned fiber optic lines

Prologis Essentials: your single-source service for efficient move-in and operations at [prologisessentials.com](https://www.prologisessentials.com)

www.prologis.com

CalDRE License #01944561

116,205 SF

Industrial Space For Lease



Prologis Sierra Business Park 4

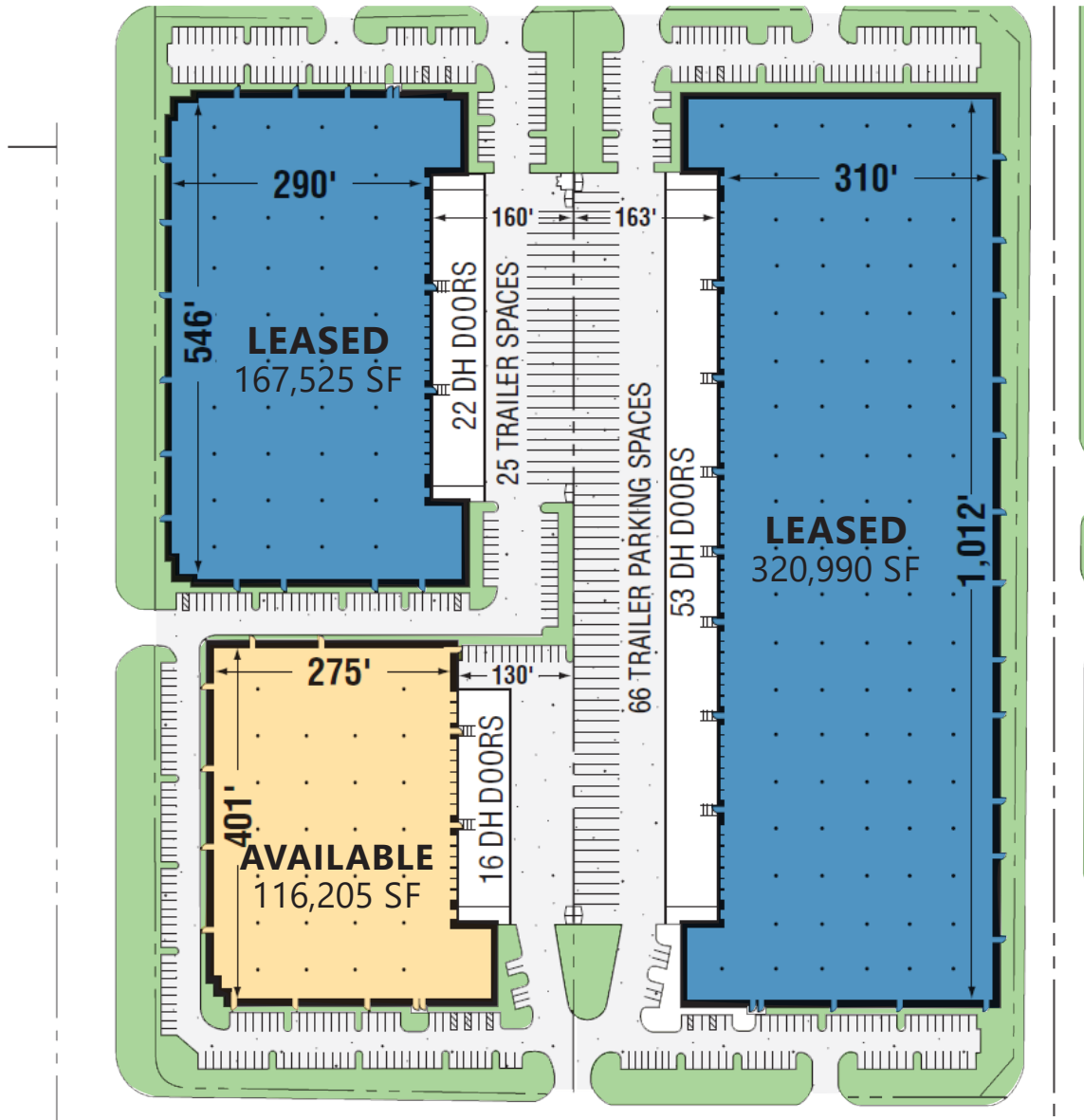

JLL
Hunter McDonald
hunter.mcdonald@am.jll.com
ph +1 909 467 6873
cell +1 818 427 1386
3281 E Guasti Rd.
Suite 850
Ontario, CA 91761 USA
CalDRE License #01879029

JLL
Mac Hewett
mac.hewett@am.jll.com
ph +1 909 467 6902
cell +1 908 432 8074
3281 E Guasti Rd.
Suite 850
Ontario, CA 91761 USA
CalDRE License #01920070

Prologis
Mark Zehner
mzehner@prologis.com
ph +1 909 673 8736
cell +1 714 624 5859
3546 Conours St.
Suite 100
Ontario, CA 91764 USA

Prologis Essentials: your single-source service for efficient move-in and operations at prologisessentials.com

No warranty or representation, expressed or implied, is made as to the accuracy of the information contained herein, and same is submitted subject to error and omissions.