

14,338 SF

Industrial Space For Lease



Prologis Romeoville



1107 Windham Parkway
Romeoville, IL 60446 USA

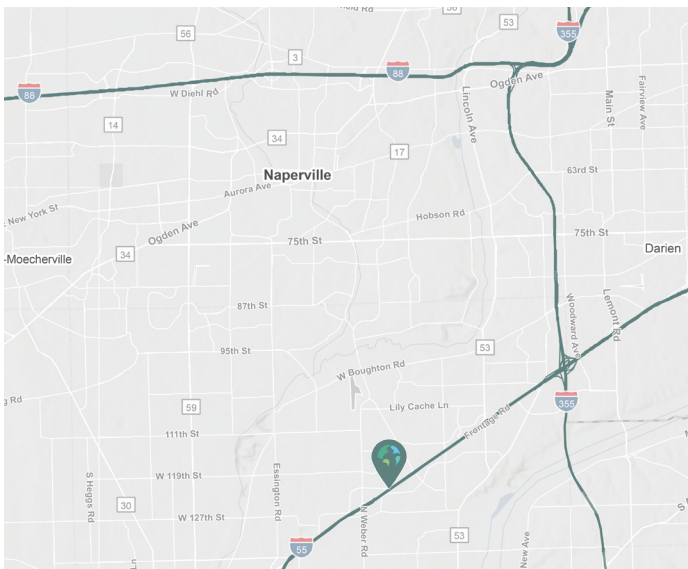

LOCATION

- Immediate access to the full interchange at Weber & I-55
- Interstate frontage

FACILITY

- 50,862 SF industrial building
- 14,338 SF available for lease
- 2,619 SF office area
- 25' clear height
- 2 exterior docks with levelers
- 44' x 43' column spacing with typical 44' speed bay
- 55 car parking stalls (entire building)
- Fully sprinklered

ADVANTAGES AND AMENITIES

- Move-in ready unit in institutionally-owned facility
- Established business park setting
- Low Will County taxes

Prologis Essentials: your single-source service for efficient move-in and operations at [prologisessentials.com](https://www.prologisessentials.com)

14,338 SF

Industrial Space For Lease



Prologis Romeoville

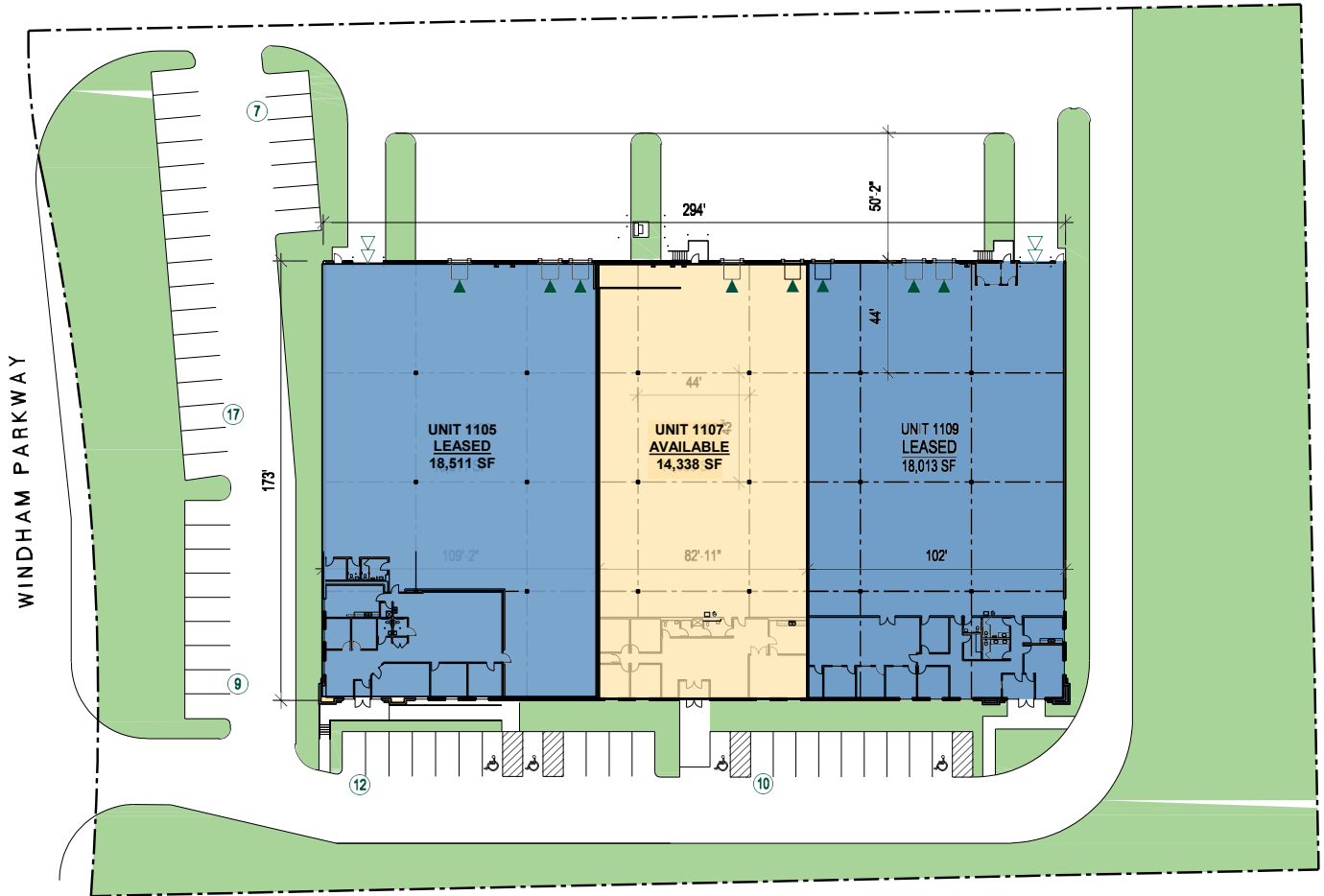

NAI Hiffman
Steve Connolly, SIOR
sconnolly@hiffman.com
ph +1 630 693 0642
cell +1 312 593 0959
1 Oakbrook Terrace
Suite 400
Oakbrook Terrace, IL 60181 USA

NAI Hiffman
Mark Moran
mmoran@hiffman.com
ph +1 630 693 0656
cell +1 773 520 2132
1 Oakbrook Terrace
Suite 400
Oakbrook Terrace, IL 60181 USA

NAI Hiffman
Jack Pappas
jpappas@hiffman.com
ph +1 630 317 0775
cell +1 773 677 0330
1 Oakbrook Terrace
Suite 400
Oakbrook Terrace, IL 60181 USA

Prologis
Trevor Jeske
tjeske@prologis.com
ph +1 847 292 3866
cell +1 248 212 9014
6250 North River Road
Suite 1100
Rosemont, IL 60018 USA

Prologis Essentials: your single-source service for efficient move-in and operations at prologisessentials.com

No warranty or representation, expressed or implied, is made as to the accuracy of the information contained herein, and same is submitted subject to error and omissions.