

16,900 SF

Industrial Space For Lease



Prologis Meadowlands | 300-330 Murray Hill Parkway



300-330 Murray Hill Parkway
East Rutherford, NJ 07073 USA

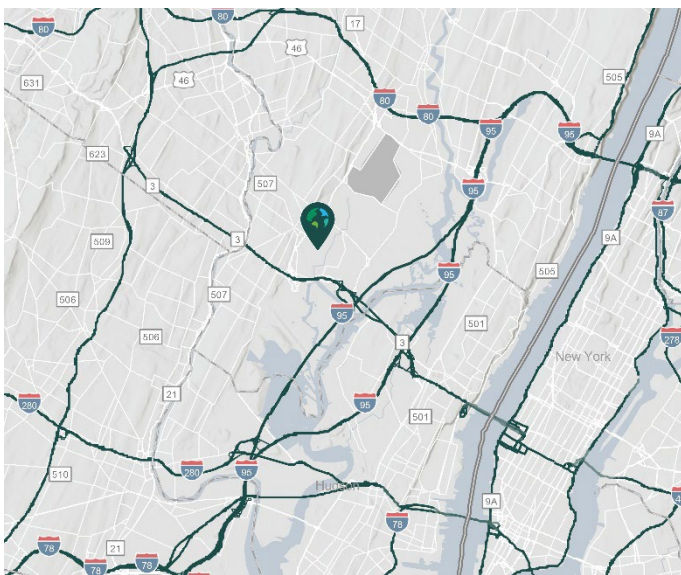

LOCATION

- Immediate access to NJ Turnpike Exit 16W, Interstate 80, Route 3, and Route 46
- ± 10 miles to New York City via Lincoln and Holland Tunnel
- ± 15 miles from Newark Liberty International Airport and Port Newark-Elizabeth
- 1 mile from Rutherford Train Station and 1 block from NJ Transit bus stop

FACILITY

- 49,210 SF total building size
- 16,900 SF available space
- 1,505 SF office
- 20' clear height
- 30' x 41'-6" column spacing
- 2 dock doors
- 200 amps, 3 phase, 480/277 volt electrical service
- LED motion sensor lighting

ADVANTAGES AND AMENITIES

- Fast, cost-effective forklift and racking sourcing through Prologis Essentials
- Prologis Clear Lease® – Know your lease expenses and capital costs with greater certainty before you sign

Prologis Essentials: your single-source service for efficient move-in and operations at
prologisessentials.com
www.prologis.com

16,900 SF

Industrial Space For Lease



Prologis Meadowlands | 300-330 Murray Hill Parkway

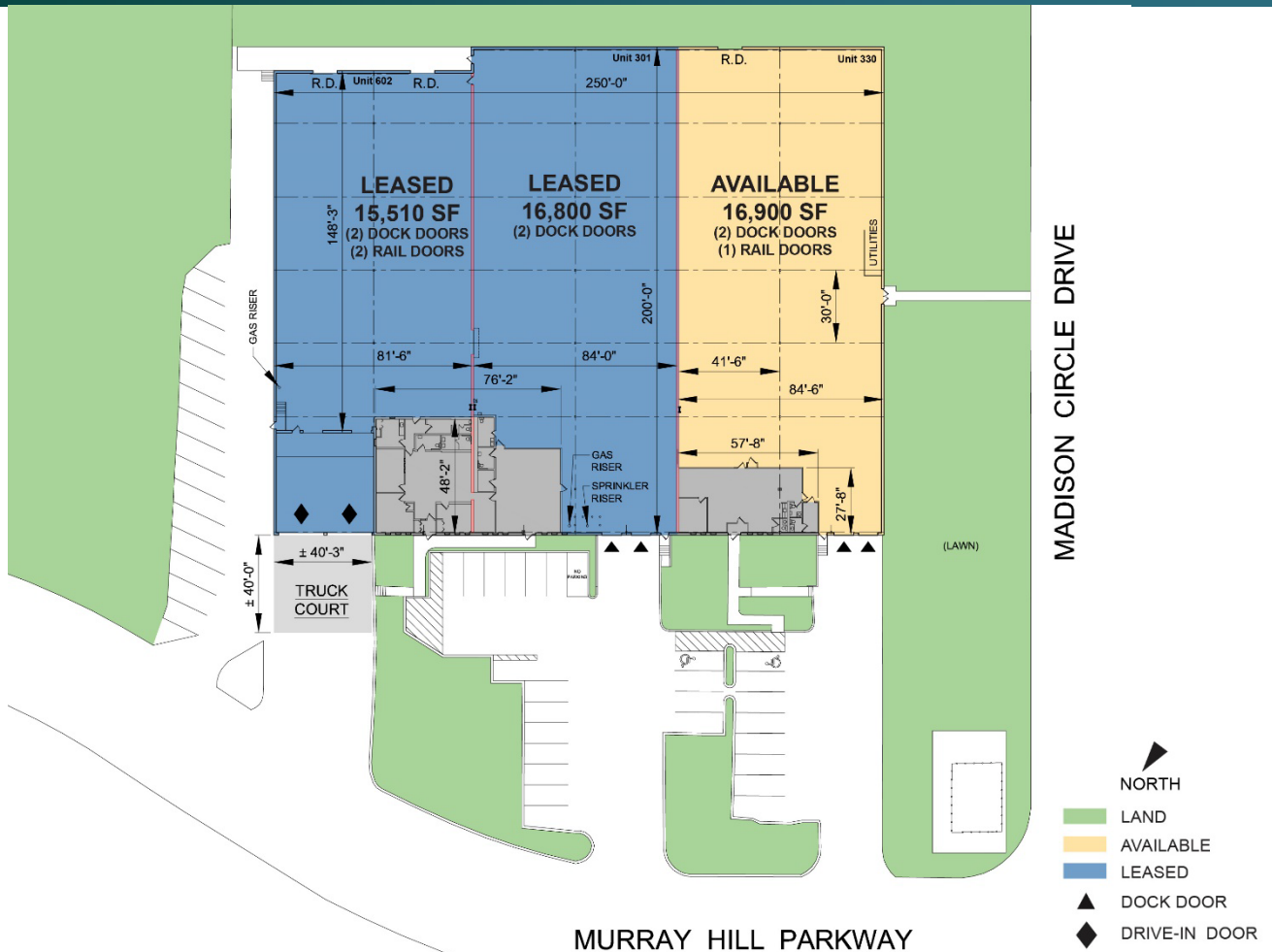

www.prologismeadowlands.com



CBRE, Inc.

Thomas F. Monahan
thomas.monahan@cbre.com
ph +1 201 712 5610
cell +1 973 568 6614
Park 80 West
Plaza Two
Saddle Brook, NJ 07663 USA

CBRE, Inc.

Stephen D'Amato
stephen.damato@cbre.com
ph +1 201 712 5616
cell +1 201 306 3788
Park 80 West
Plaza Two
Saddle Brook, NJ 07663 USA

CBRE, Inc.

Larry Schiftenhaus
larry.schiftenhaus@cbre.com
ph +1 201 712 5809
cell +1 201 532 5092
Park 80 West
Plaza Two
Saddle Brook, NJ 07663 USA

Prologis

Sarah Rutherford
srutherford@prologis.com
ph +1 201 528 9576
cell +1 551 206 6985
One Meadowlands Plaza
Suite 100
East Rutherford, NJ 07073 USA

Prologis Essentials: your single-source service for efficient move-in and operations at prologisessentials.com

No warranty or representation, expressed or implied, is made as to the accuracy of the information contained herein, and same is submitted subject to error and omissions.