

# 11,275 SF

## Industrial Space For Lease



## Prologis Great Southwest

1475 Avenue S, Suite 300  
Grand Prairie, Texas 75050 USA



### LOCATION

- Situated in the highly desirable North Great Southwest industrial submarket
- Excellent access to major highways TX-360, 183 and 161

### FACILITY

- 11,275 sf available
- 3,335 sf office
- 18' clear height
- 2 overhead dock doors
- 2 overhead dock doors with ramp

### ADVANTAGES AND AMENITIES

- Rear load configuration

# 11,275 SF

## Industrial Space For Lease

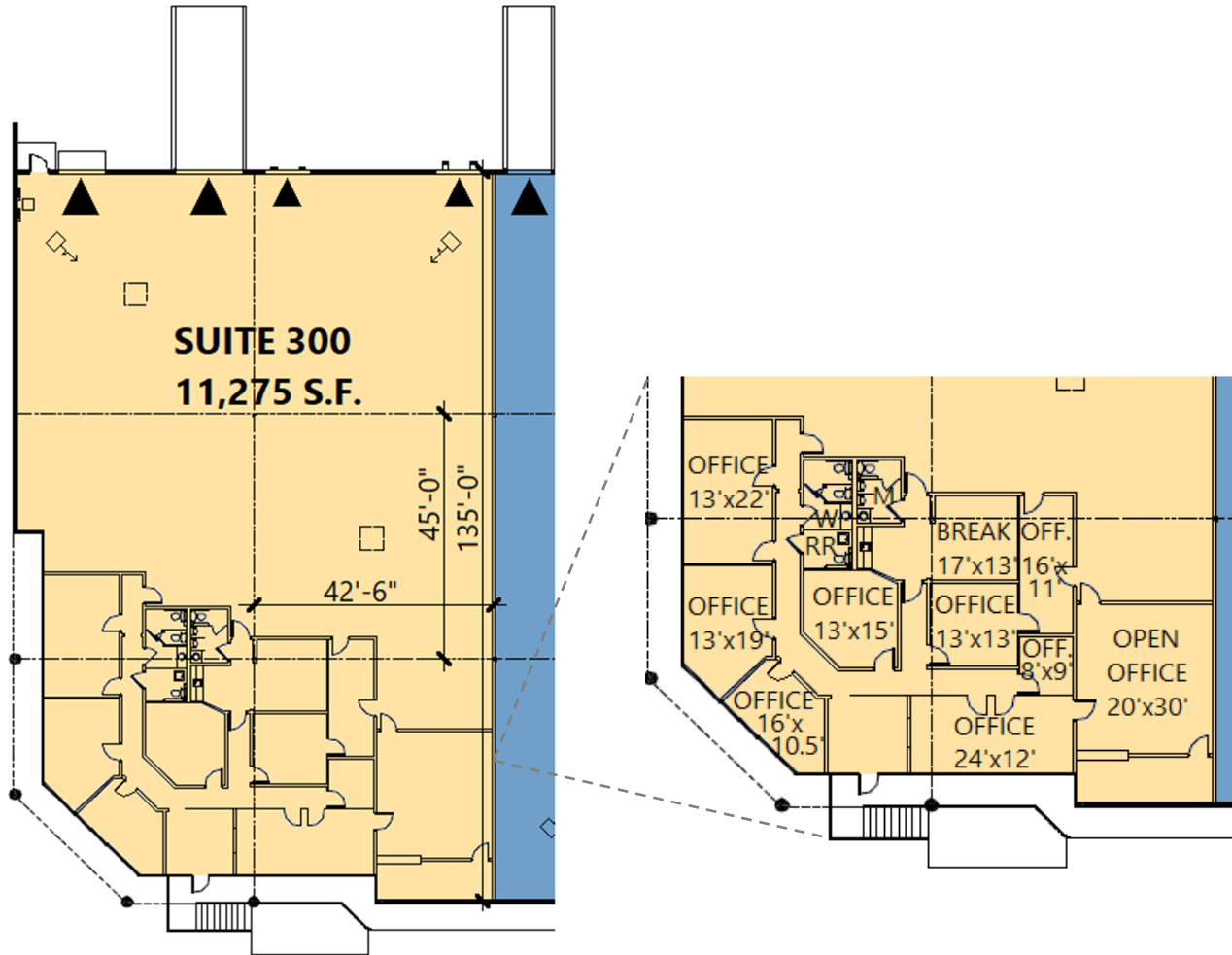

### Mercer Company

**Corby Hodgkiss**

chodgkiss@mercero-company.com

ph +1 214 630 7010 x28

cell +1 469 360 3918

2461 N. Stemmons Freeway

Dallas, TX 75207 USA

### Mercer Company

**Harrison Putt**

hputt@mercero-company.com

ph +1 214 630 7010

cell +1 214 945 7306

2461 N. Stemmons Freeway

Dallas, TX 75207 USA

### Prologis

**Ryan McNaughton**

rmcnaughton@prologis.com

ph +1 972 884 9218

cell +1 214 673 9489

2021 McKinney Avenue

Suite 1050

Dallas, TX 75201 USA