

105,588 SF

Industrial Space For Lease



Prologis San Bernardino Distribution Center



311 South Doolittle Avenue
San Bernardino, CA 92408 USA

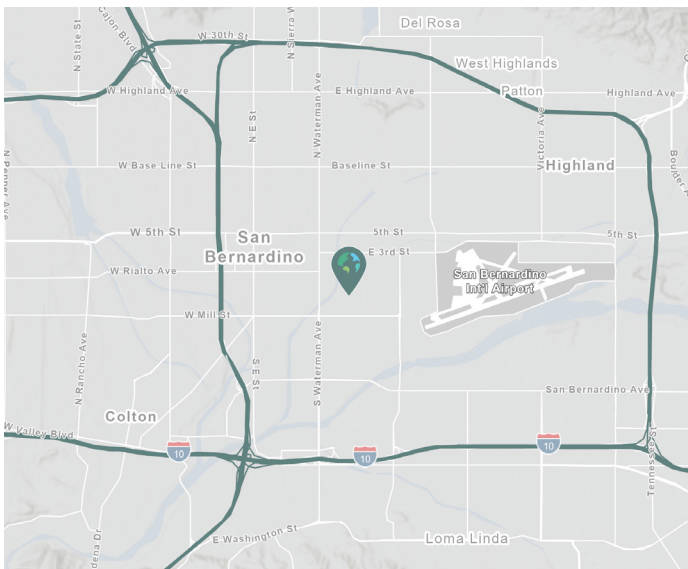

LOCATION

- Inland Empire location that serves the entire Los Angeles basin
- Access to 10, 215, and 210 freeways

FACILITY

- 105,588 SF free standing building
- ±1,834 SF of office space (southwest corner)
- 30' minimum clear height
- 21 (9' x 10') dock high doors
 - 7 with pit levelers
- 2 ground level doors (via ramp)
- 52' x 60' column spacing (typical)
- 130' secured truck court
- ESFR sprinklers (K-25)
- T5 energy efficient lighting
- 4 battery charging stations
- MM80 joints

ADVANTAGES AND AMENITIES

- Access to the Prologis Essentials platform, which includes:
 - [Operations Essentials](#)
 - [Energy Essentials](#)
 - [Workforce Essentials](#)
 - [Mobility Essentials](#)
 - [Digital Essentials](#)

Your single-source service for efficient move-in and operations: [prologisessentials.com](https://www.prologisessentials.com)

105,588 SF

Industrial Space For Lease



Prologis San Bernardino Distribution Center

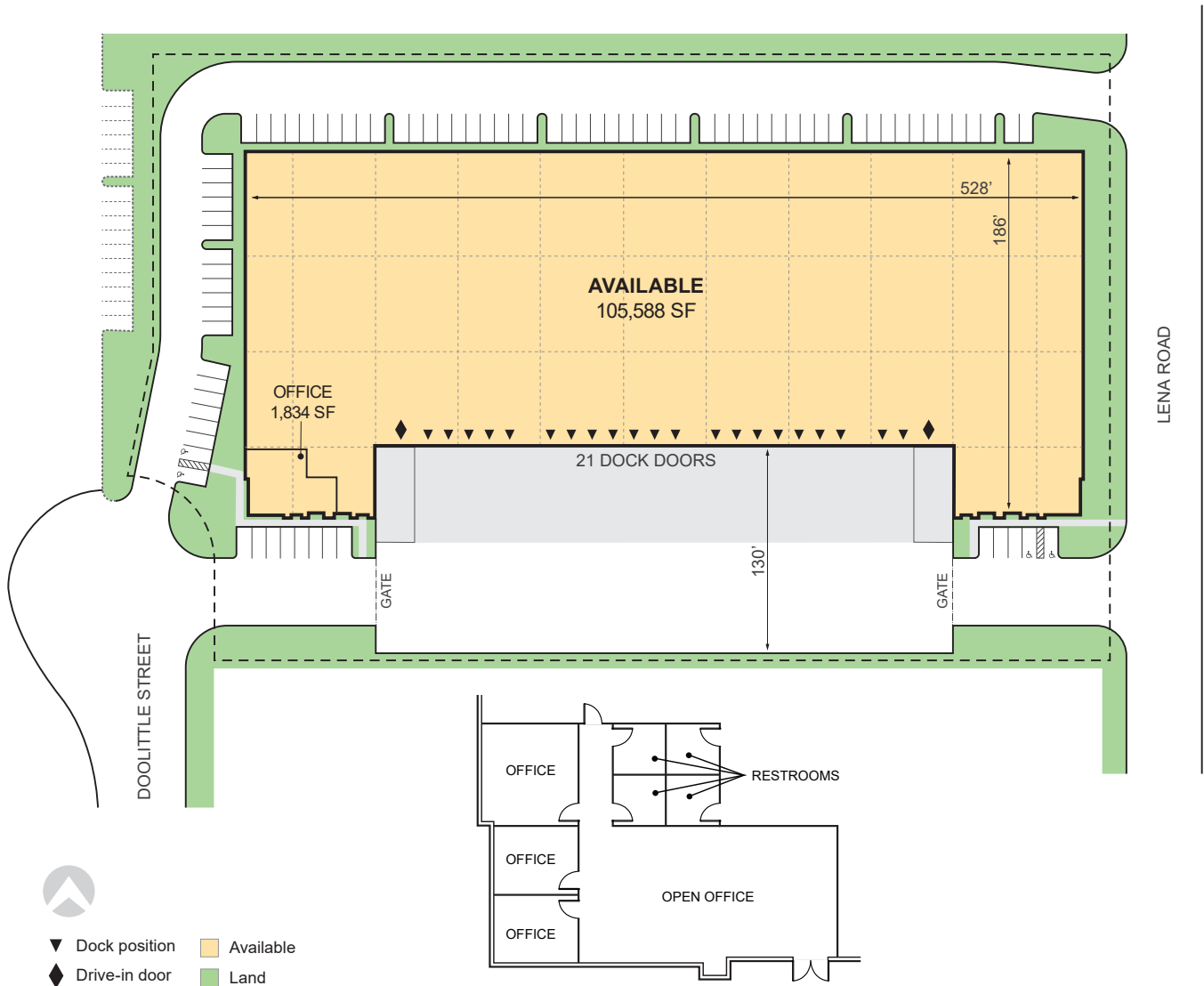

JLL
Hunter McDonald
hunter.mcdonald@jll.com
ph +1 909 467 6873
cell +1 818 427 1386
3281 E Guasti Rd.
Suite 850
Ontario, CA 91761 USA
CalDRE License #01879029

JLL
Mac Hewett
mac.hewett@jll.com
ph +1 909 467 6902
cell +1 908 432 8074
3281 E Guasti Rd.
Suite 850
Ontario, CA 91761 USA
CalDRE License #01920070

Prologis
Mark Zehner
mzehner@prologis.com
ph +1 909 673 8736
cell +1 714 624 8589
3546 Concourse Street
Suite 100
Ontario, CA 91764 USA
CA DRE License # 00974420