

VIA PUBLICA D

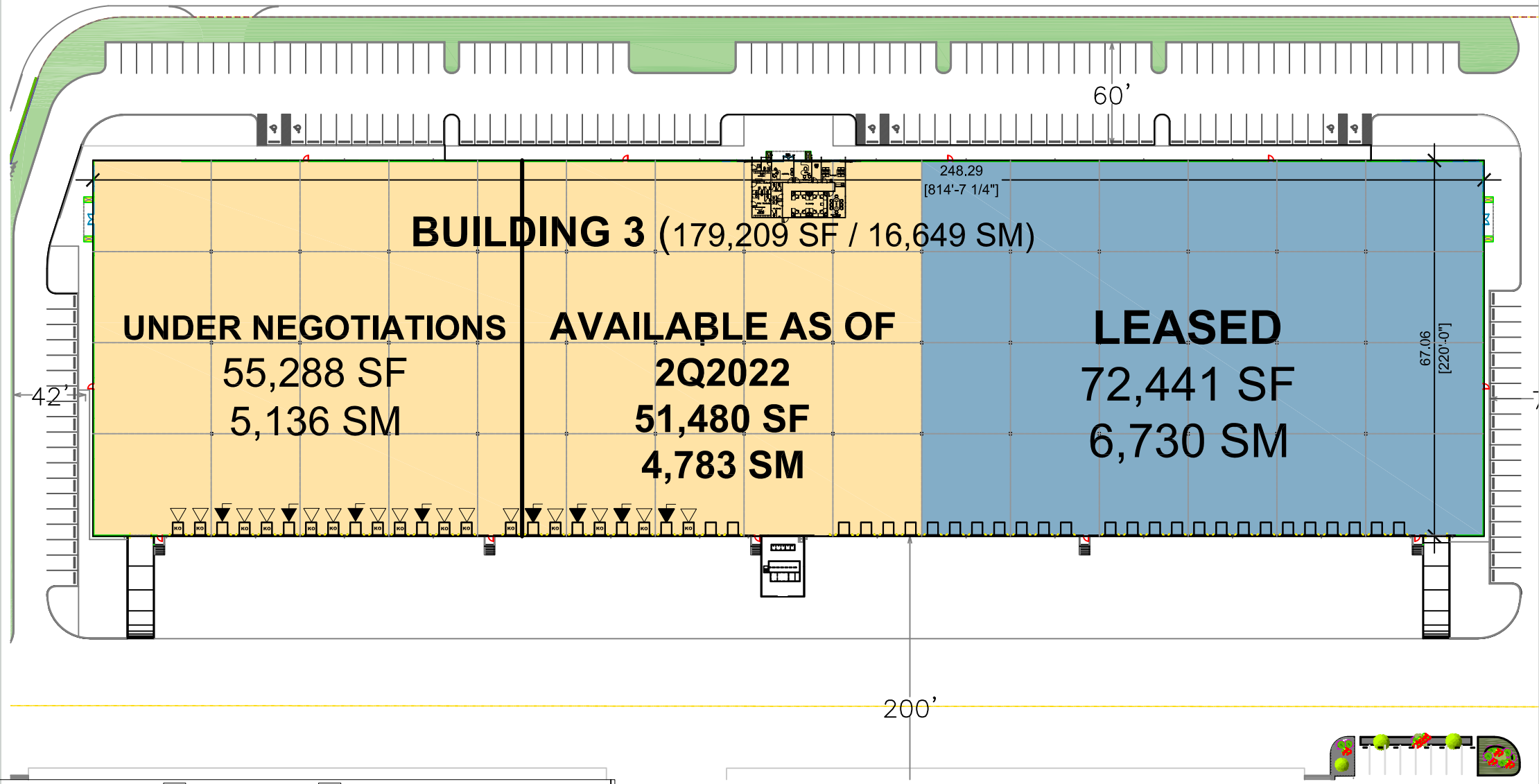

PROLOGIS PARK TOLUCA

Jerma Edo. de México

México

	BUILDING 3	
	M2	SF
Warehouse	16,649.62 sm	179,215 sf
Liverpool	5,668 sm	61,008 SF
Office	3%	3%
NRA	16,649.62 sm	179,215 sf
Automobile Parking Spaces		54
Drop Lot Spaces		7
Equipped Loading Dock Doors		5
KO for future Loading Dock Doors		12
Drive In Door		1
BUILDING SPECIFICATIONS		
Construction Type	Steel structure and Concrete Tilt-up walls	
Floor Slab	6" reinforced concrete floor slab / f'c= 280 Kg/cm2 Ashford formula hardener	
Roof Type	KR-18 standing seam roof with 2" insulation pad R=7 5% acrylic skylights	
Clear Height	32' at 1st Bay	
Grid	50' x 52'	
Lighting	T5 300 luxes without racks	
Ventilation System	2 Changes per hour	
Equipped Dock Doors	9' x 10' sectional overhead door Seal /Bumpers 8'x6' mechanical dock leveler 30,000 lbs	
Fire Protection System	Hose and cabinets All ready for sprinklers	
Closed Environment	Architectural & chain link fence surrounding the limits of the Park	

LEGEND:

- LAND
- LEASED AREA
- AVAILABLE
- LEASED
- ▲ DOCK POSITION
- ▲ DOCK POSITION W/LEVELER
- △ FUTURE DOCK POSITION
- ◆ DRIVE IN DOOR

NOTE:

THIS CONCEPTUAL PLAN IS FOR MARKETING PURPOSES ONLY, AND HAS BEEN PREPARED BASED ON PRELIMINARY AVAILABLE SITE INFORMATION DEEMED RELIABLE. ALL DIMENSIONS AND AREA CALCULATIONS ARE SUBJECT TO VERIFICATION BY A PROFESSIONAL ENGINEER FOR COMPLIANCE WITH ALL FEDERAL, STATE AND LOCAL REGULATIONS.



Paseo de los Tamarindos 90 Torre 2 Piso 22
Bosques de las Lomas | CDMX 05120 | Mexico.
www.prologis.com

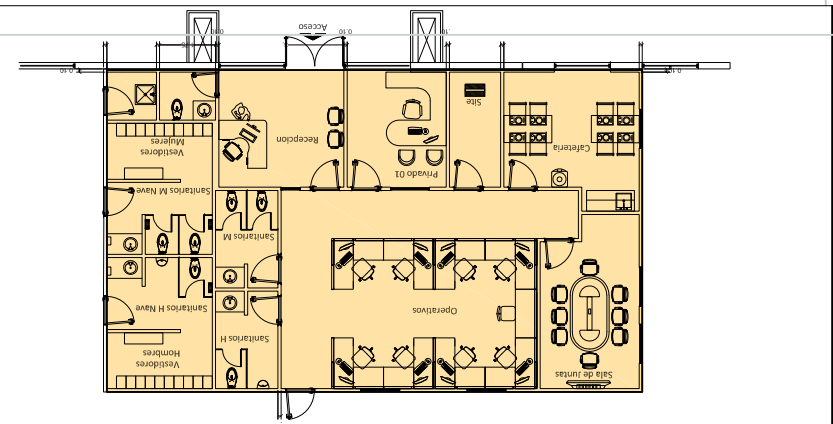

OFFICE AREA
1,884 SF / 175 SM

SITE PLAN