

# 169,496 SF

Industrial Space For Lease



## Prologis Interchange 20 - Building 2



1700 E. Mayfield Road  
Arlington, TX 76014 USA

### LOCATION

- In the highly desirable Great Southwest industrial submarket with easy access to SH 360 and I-20
- Corner location accessible from Mayfield Road and Allen Ave.

### FACILITY

- 169,496 sf available, divisible to 85,000 sf
- Front load configuration
- Two (2) 4,493 sf spec offices
- 36' clear height
- 32 (9' x 10') overhead dock doors, 8 with levelers
- 2 (12' x 14') overhead dock doors with ramp
- 3 phase, 277/480V, 2000A power
- LEED certified
- ESFR sprinkler system
- 141 car parking spaces
- 36 trailer parking spaces
- 185' truck court

### ADVANTAGES AND AMENITIES

- Triple Freeport tax exempt area
- Easy access to Arlington Highlands
- Access to the [Prologis Essentials](#) platform, which includes:
  - [Operations Essentials](#)
  - [Energy + Sustainability Essentials](#)
  - [Mobility Essentials](#)

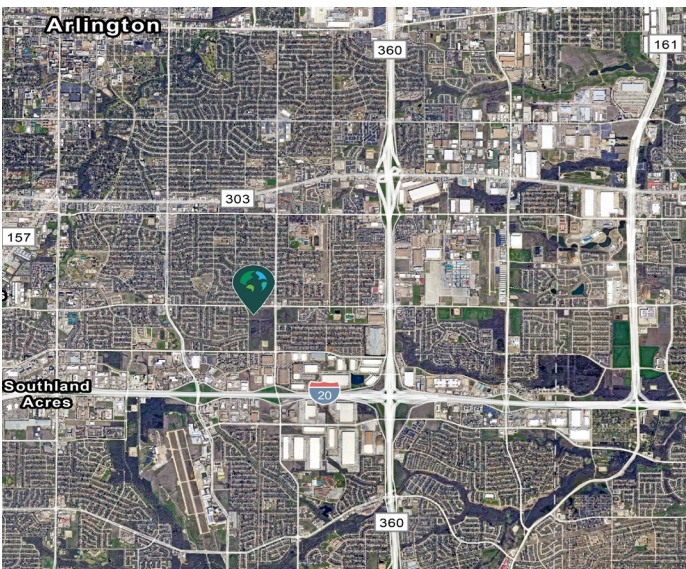

**Prologis Essentials: your single-source service for efficient move-in and operations at [prologisessentials.com](https://prologisessentials.com)**

# 169,496 SF

Industrial Space For Lease



## Prologis Interchange 20 - Building 2

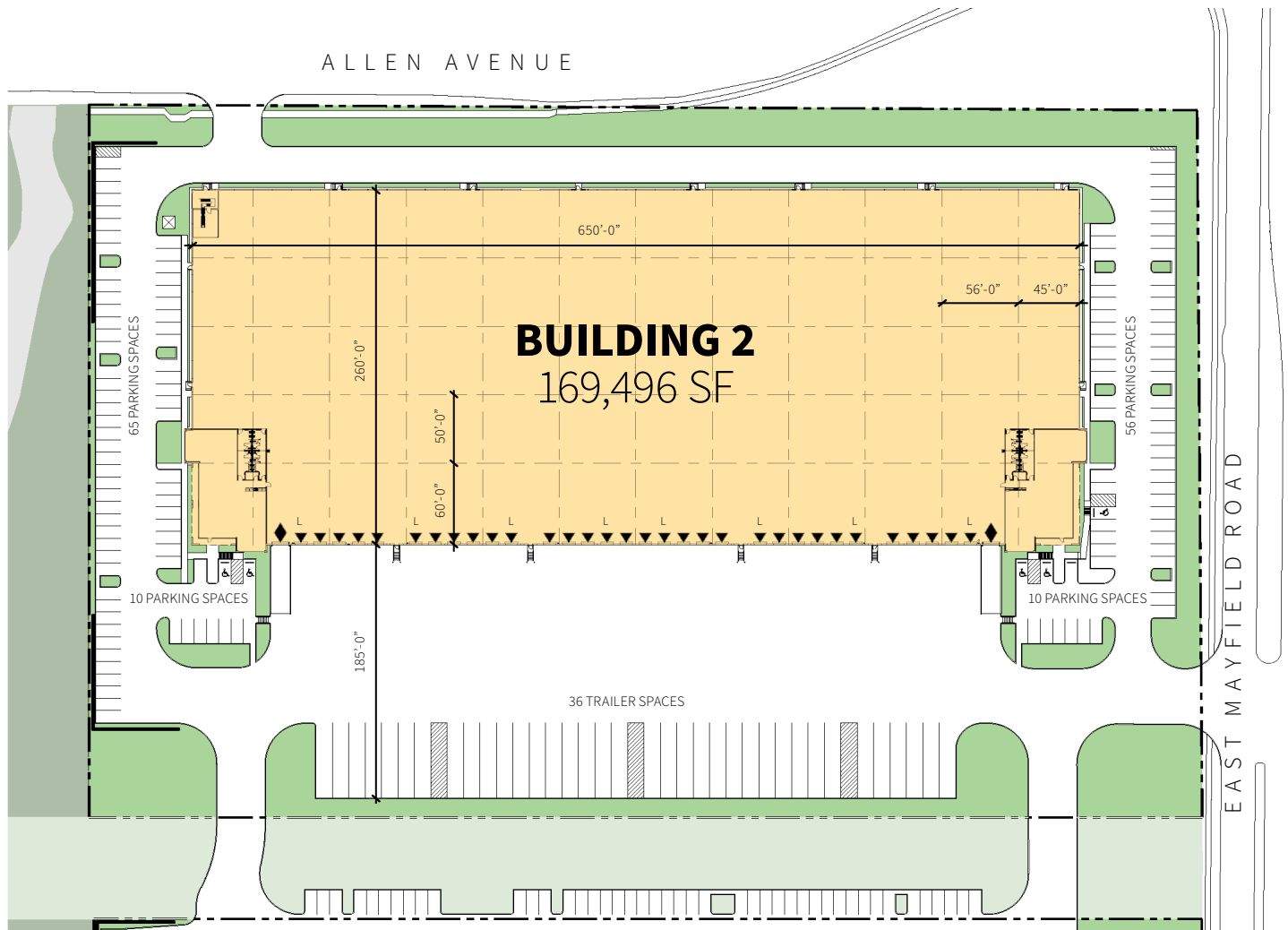

### Transwestern

Joe Rudd  
joe.rudd@transwestern.com  
ph +1 817 259 3515  
cell +1 214 783 3109  
777 Main Street  
Suite 1500  
Fort Worth, TX 76102 USA

### Transwestern

John Brewer  
john.brewer@transwestern.com  
ph +1 972 774 2593  
cell +1 214 680 9415  
2300 North Field Street  
Suite 2000  
Dallas, TX 75201 USA

### Transwestern

Riley Maxwell  
riley.maxwell@transwestern.com  
ph +1 972 774 2508  
cell +1 214 676 3235  
2300 North Field Street  
Suite 2000  
Dallas, TX 75201 USA

### Prologis

Ryan McNaughton  
rmcnaughton@prologis.com  
ph +1 972 884 9218  
cell +1 214 673 9489  
2021 McKinney Avenue  
Suite 1050  
Dallas, TX 75201 USA