

# 23,200 SF

## Industrial Space For Lease



### Upland Distribution Center Building 9

14800 East 35<sup>th</sup> Place  
Aurora, Colorado 80011 USA

#### LOCATION

- Easy access to I-70 & I-225
- Close proximity to I-270 & I-76
- 10 miles to Denver International Airport
- 14 miles to Downtown Denver

#### FACILITY

- 23,200 SF with 1,889 SF of office
- Front load
- 24' Minimum clear height
- ESFR sprinkler system
- 5 Dock-hi doors
- 1 Drive-in door

#### ADVANTAGES AND AMENITIES

- Excellent access to I-70 and I-225
- Master plan Business Park
- Close proximity to restaurants and hotels



# 23,200 SF

## Industrial Space For Lease

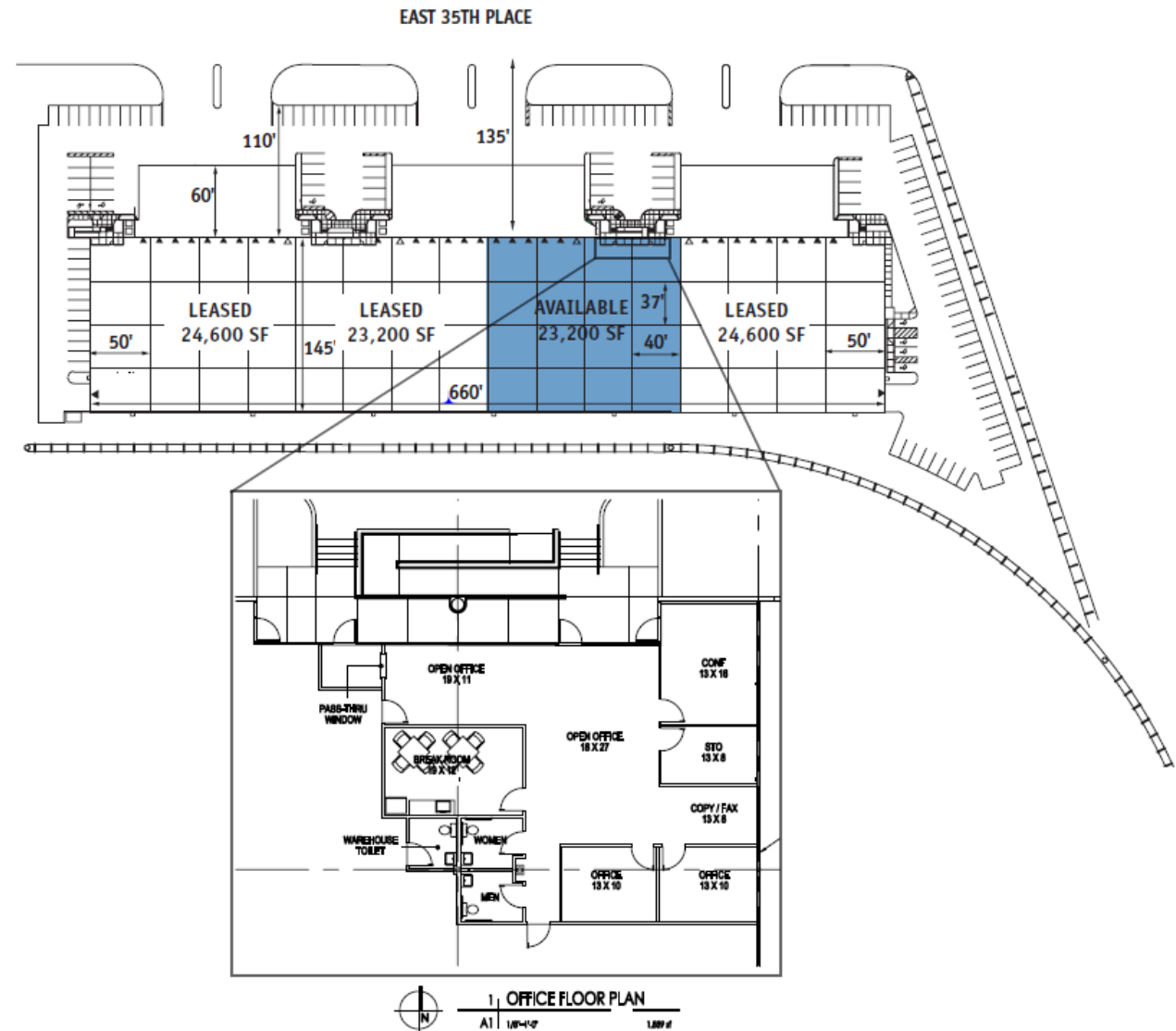

### Prologis

Wayne E. Barrett  
wbarrett@prologis.com  
ph +1 303 567 5688  
cell +1 720 320 1760  
1800 Wazee Street  
Suite 500  
Denver, CO 80202 USA