

**PROLOGIS**  
**4733 NEWCASTLE ROAD**  
 STOCKTON, CA

TOTAL BUILDING FOOTPRINT:	186,944 SF
AUTO PARKING SPACES:	140
AUTO PARKING PROVIDED PER 1,000 SF:	0.31
TRAILER PARKING SPACES:	52
DOCK DOORS W/O LEVELERS:	28
DOCK DOORS W/ LEVELERS:	2
DRIVE-INS:	2
CLEAR HEIGHT:	36'
TYPICAL BAY:	52'x50'

**LEGEND:**

- ▲ DOCK POSITION
- ▲ DOCK POSITION W/ LEVELER
- ◆ DRIVE-IN DOOR
- LAND
- AVAILABLE

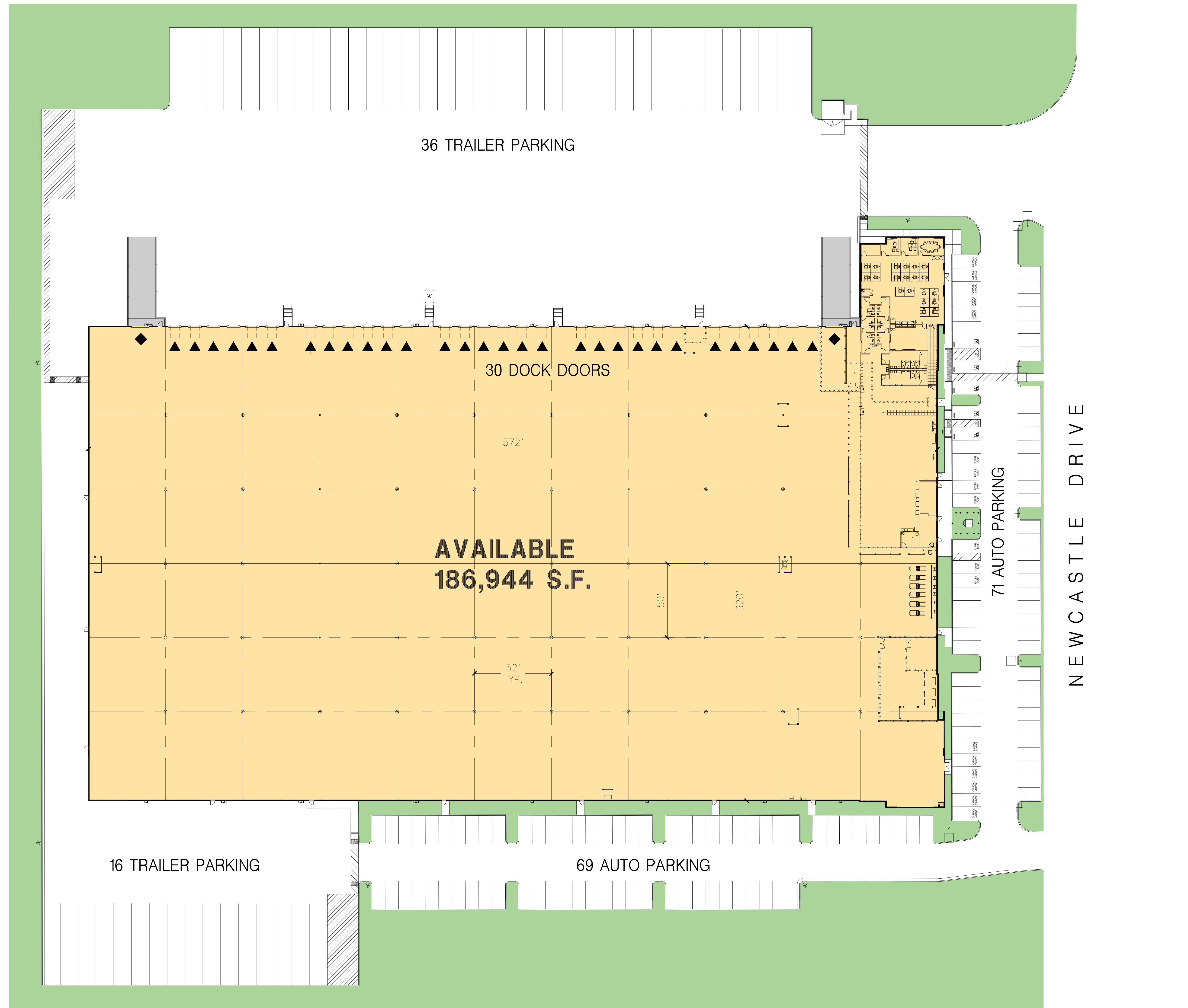

SITE PLAN

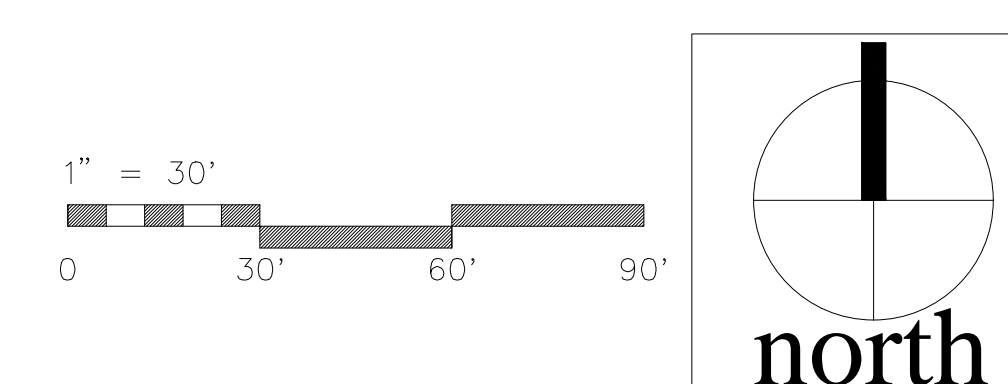

NOTE: THIS CONCEPTUAL PLAN IS FOR MARKETING PURPOSES ONLY AND HAS BEEN PREPARED BASED ON PRELIMINARY AVAILABLE SITE INFORMATION DEEMED RELIABLE. ALL DIMENSION AREA CALCULATIONS ARE SUBJECT TO VERIFICATION BY A PROFESSIONAL ENGINEER FOR COMPLIANCE WITH ALL FEDERAL, STATE, AND LOCAL REGULATIONS



600 GRAND AVE., STE. #302  
 OAKLAND, CA 94610  
 (949) 862-2113  
 WWW.HPARCHS.COM