

17,791 SF

Industrial Space For Lease



Prologis Beacon Centre 14



2250 NW 84th Avenue
Doral, FL 33126 USA

LOCATION

- Easy access to Miami International Airport and PortMiami
- Direct access to SR 836 (Dolphin Expressway), with easy access to SR 826 (Palmetto Expressway), and Florida's Turnpike

FACILITY

- ±17,791 SF available; inclusive of ±8,370 SF of office
- 24' Clear height
- 2 Dock high doors
- 5 Street level doors
- 1 Edge of dock leveler
- Column spacing 40' X 40'
- Parking ratio 3.18 :1,000
- Rear loading / Non-shared truck court
- Truck court depth 44' & 79'
- Available January 2025

ADVANTAGES AND AMENITIES

- Beacon Centre is a 205 acre secured master-planned business park located in the heart of the Airport West /Doral submarket.
- Nearby amenities include numerous restaurants, hotels, banks and shopping centers.
- [Prologis Clear Lease®](#) – Know your lease expenses and capital cost with greater certainty before your sign.

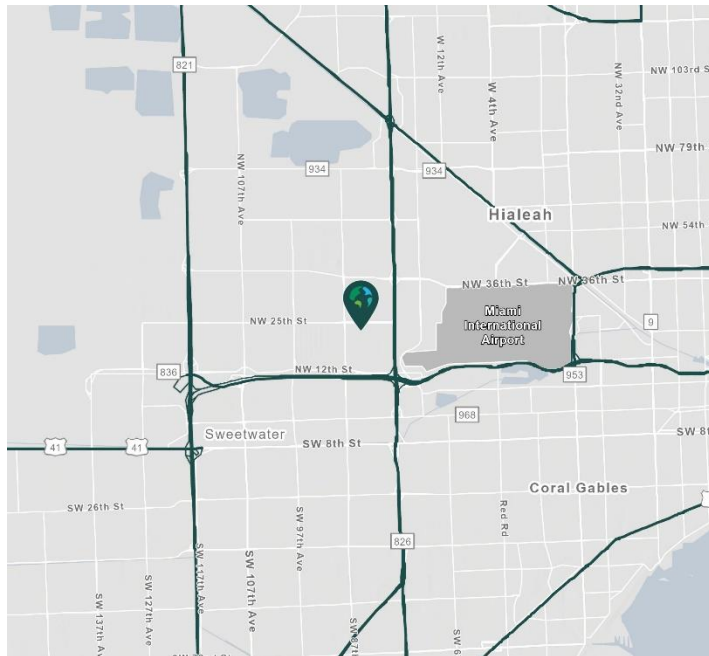

Scan the QR code for more info!

Your single-source service for efficient move-in and operations: [prologisessentials.com](https://www.prologisessentials.com)

17,791 SF

Industrial Space For Lease



Prologis Beacon Centre 14

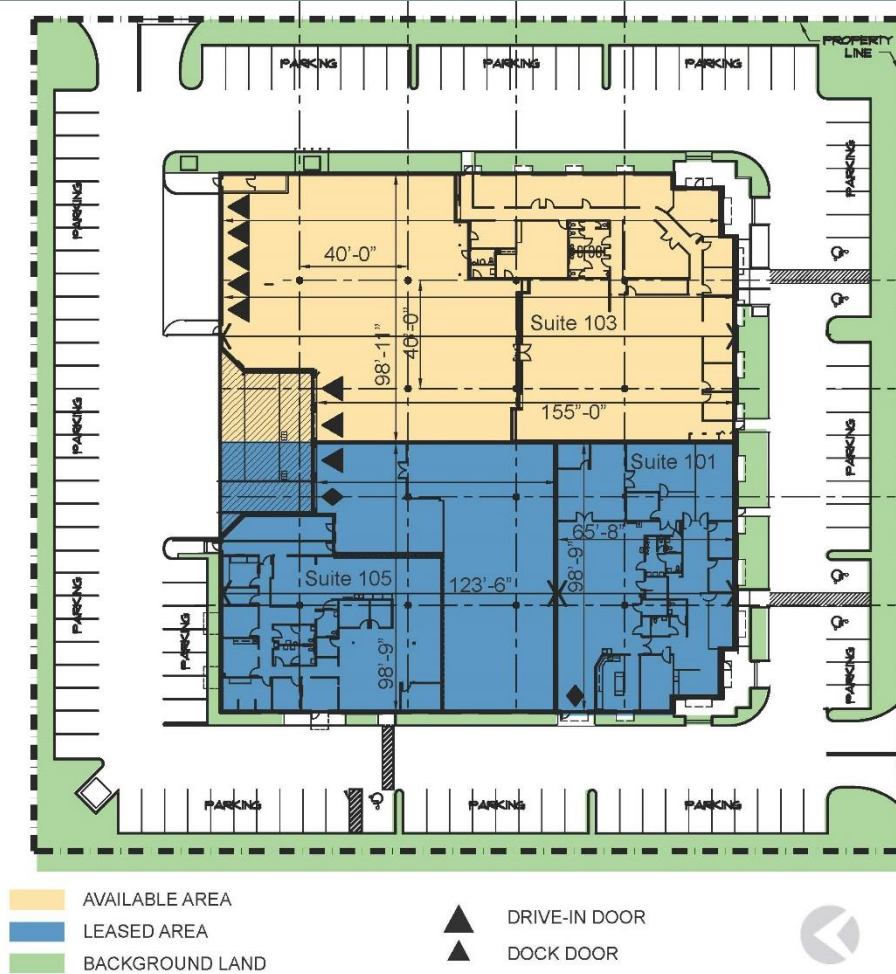

State Street Realty

George Pino, SIOR
gpino@statestreetre.com
ph +1 305 447 3390
cell +1 786 402 7387
8319 NW 12 Street
Doral, FL 33126 USA

State Street Realty

Brian Cabiellles, SIOR
bcabiellles@statestreetre.com
ph +1 305 447 3390
cell +1 305 606 7109
8319 NW 12 Street
Doral, FL 33126 USA

Prologis

Diana T. Escobar
descobar@prologis.com
ph +1 305 599 6221
8355 NW 12 Street
Doral, FL 33126 USA