

1,835 SF

Office Space For Lease



Prologis Beacon Centre

8323 NW 12th Street, Suite 208
Doral, FL 33126 USA

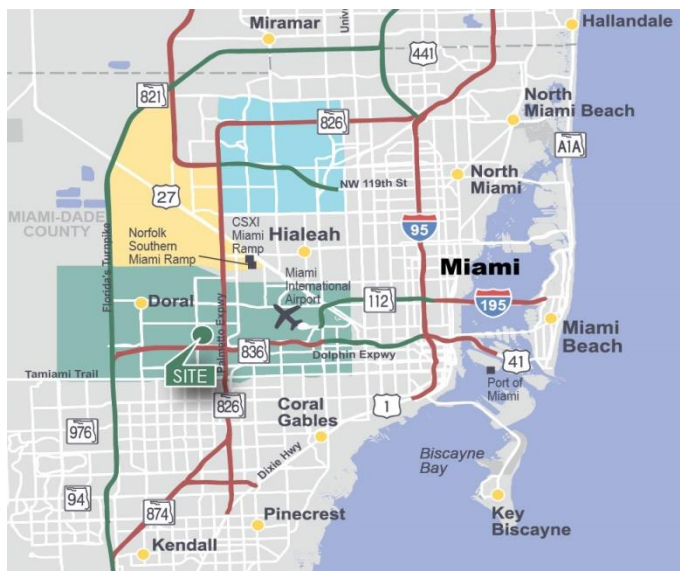

LOCATION

- Easy access to Miami International Airport and Port Miami
- Direct access to 836 (Dolphin Expressway), with easy access to 826 (Palmetto Expressway), and Florida's Turnpike

FACILITY

- ±1,835 SF of office
- 4 parking spaces per 1,000 rentable square feet
- 24 hour security
- Available Immediately

ADVANTAGES AND AMENITIES

- Beacon Centre is a 205-acre secured master-planned business park located in the heart of the Airport West /Doral submarket.
- Nearby amenities include numerous restaurants, hotels, banks and shopping centers.

1,835 SF

Office Space For Lease

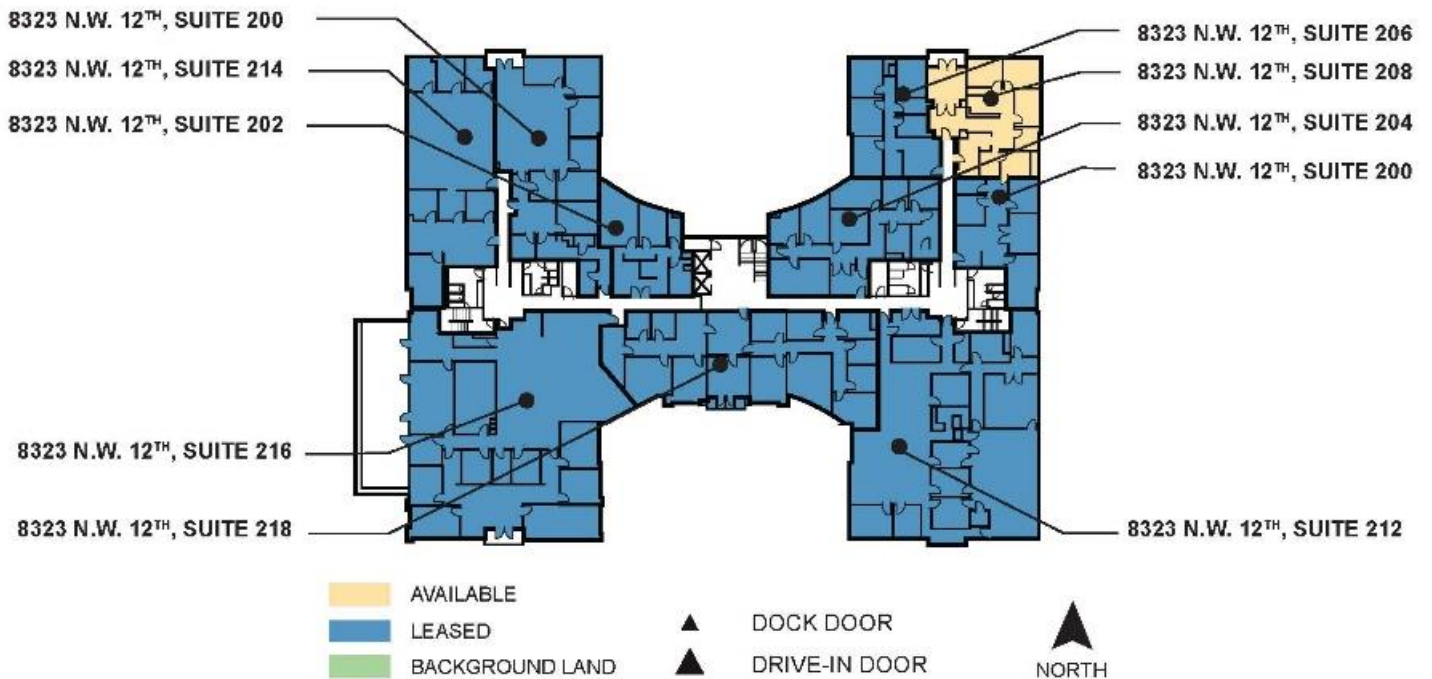

State Street Realty

George Pino, SIOR, RPA
gpino@statestreetre.com
ph +1 305 447 3390
cell +1 786 402 7387
8369 NW 12 Street
Doral, FL 33126 USA

State Street Realty

Brian Cabielles
bcabielles@statestreetre.com
ph +1 305 447 3390
cell +1 305 606 7109
8369 NW 12 Street
Doral, FL 33126 USA

Prologis

Barbara Mantecon
bmantecon@prologis.com
ph +1 305 477 8700
8355 NW 12 Street
Doral, FL 33126 USA