

# 130,300 SF

Industrial Space For Lease



## Prologis Mesquite Distribution Center 2



5351 Samuel Boulevard, Suite 400  
Mesquite, TX 75149 USA

### LOCATION

- Easy access to major thoroughfares including I-30 and I-635

### FACILITY

- 130,300 sf available
- 5,285 sf office
- 28' clear height
- 50' x 50' typical bay spacing
- 17 (9' x 10') overhead dock doors with levelers
- 2 (20' x 14') overhead dock doors with ramp
- ESFR sprinkler system
- Security fence with gates
- 89 auto parking spaces
- 29 trailer parking spaces

### ADVANTAGES AND AMENITIES

- Access to the [Prologis Essentials](#) platform, which includes:
  - [Operations Essentials](#)
  - [Energy + Sustainability Essentials](#)
  - [Mobility Essentials](#)
  - [Workforce Essentials](#)

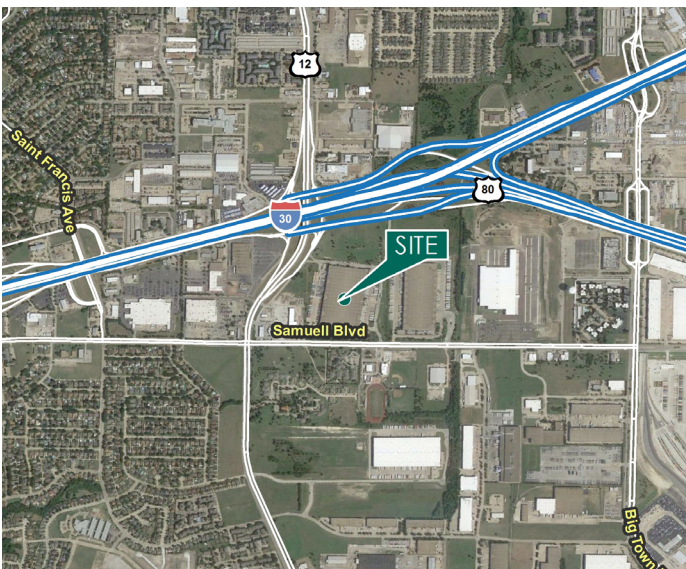

**Prologis Essentials: your single-source service for efficient move-in and operations at [prologisessentials.com](https://www.prologisessentials.com)**

# 130,300 SF

Industrial Space For Lease



## Prologis Mesquite Distribution Center 2

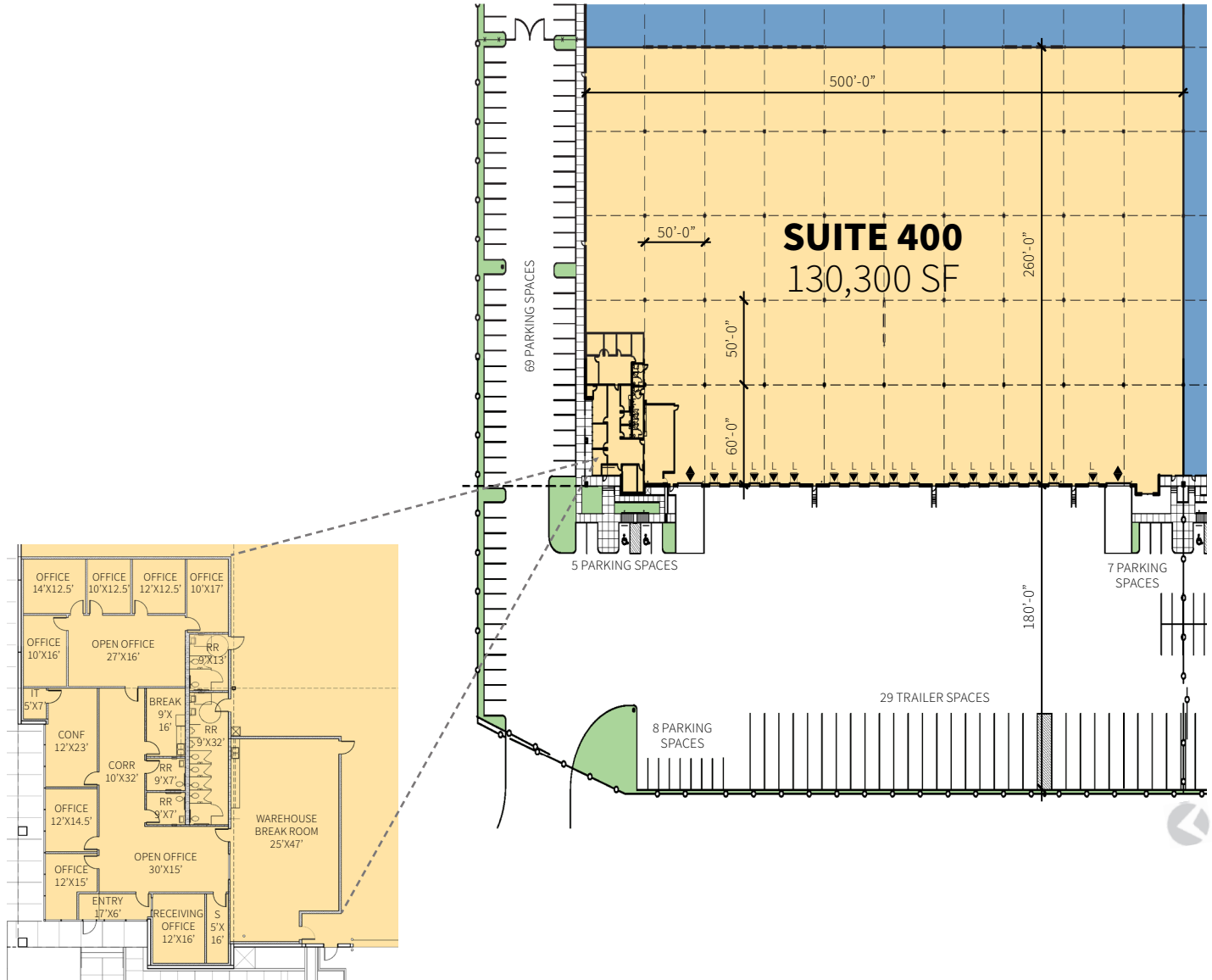

**JLL**  
Kurt Griffin  
kurt.griffin@jll.com  
ph +1 214 438 6372  
2401 Cedar Springs Road  
Suite 100  
Dallas, TX 75201 USA

**JLL**  
Nathan Orbin  
nathan.orbin@jll.com  
ph +1 214 438 1649  
2401 Cedar Springs Road  
Suite 100  
Dallas, TX 75201 USA

**JLL**  
Dalton Knipe  
dalton.knipe@jll.com  
ph +1 214 438 6195  
2401 Cedar Springs Road  
Suite 100  
Dallas, TX 75201 USA

**JLL**  
Weston King  
weston.king@jll.com  
ph +1 214 438 6193  
2401 Cedar Springs Road  
Suite 100  
Dallas, TX 75201 USA

**Prologis**  
Kathleen Isola  
kisola@prologis.com  
ph +1 972 884 9202  
cell +1 214 709 1405  
2021 McKinney Avenue  
Suite 1050  
Dallas, TX 75201 USA