

# 18,000 SF

## Industrial Space For Lease



### Prologis NW Corporate Park 6

3221 NW Guam Street  
Portland, OR 97210 USA



#### LOCATION

- Guilds Lake / NW Industrial Area
- Eleven (11) Buildings; 887,935 SF Park

#### FACILITY

- Approximately 18,000 SF Available
- TBD SF of Office
- Two (2) Docks
- Two (2) Drive-In Doors
- Fully Sprinklered
- 22' Clear Height

#### ADVANTAGES AND AMENITIES

- Close-In NW Location
- Minutes to Downtown Portland
- Immediate Access to I-405 and I-5
- Park Amenities Include Food Services and Major Bank
- Call for Rates

# 18,000 SF

## Industrial Space For Lease

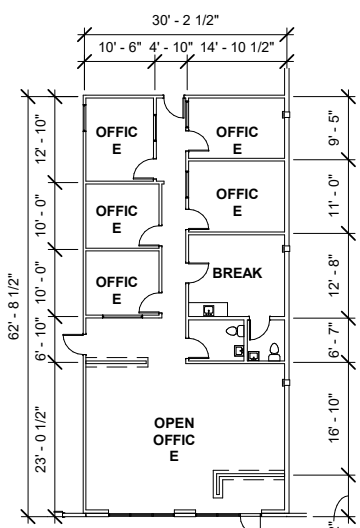
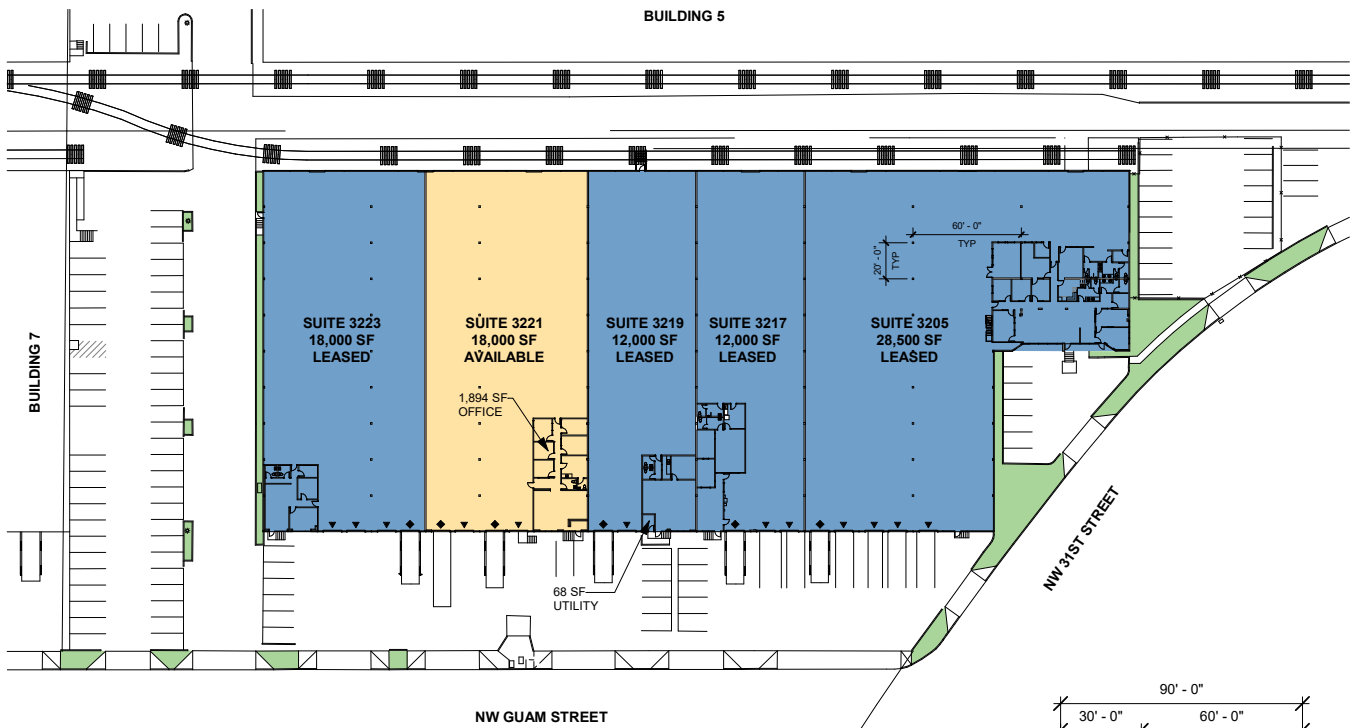

**OFFICE PLAN**  
NTS

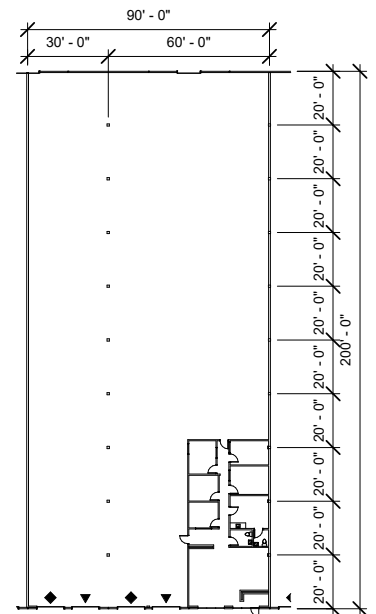

**OVERALL TENANT AREA**  
NTS



**Capacity Commercial Group**  
 Scott Kappes, SIOR  
 scottk@capacitycommercial.com  
 ph +1 503.517.9877  
 cell +1 503.816.4201  
 805 SW Broadway Street, Suite 700  
 Portland, OR 97205

**Capacity Commercial Group**  
 Kenny Houser  
 kenny@capacitycommercial.com  
 ph +1 503.517.9875  
 cell +1 503.385.6080  
 805 SW Broadway Street, Suite 700  
 Portland, OR 97205

**Prologis**  
 Sean Colletta  
 scolletta@prologis.com  
 ph +1 503.276.7375  
 4380 SW Macadam Avenue, Suite 285  
 Portland, OR 97239