

14,092 SF

Industrial Space For Lease



Prologis Park Addison

901 S. Rohlwing Road, Unit H
Addison, IL 60101 USA

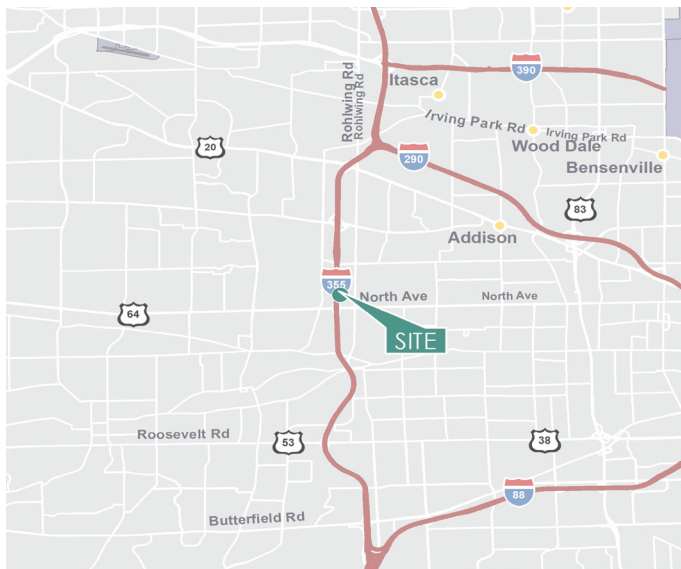

LOCATION

- Immediate access to I-355 via North Avenue (Route 64)
- Close proximity to other major highways

FACILITY

- 133,892 SF building
- 14,092 SF available
- 6,632 SF office area (can be reduced)
- 18' clear height
- 3 shared interior docks
- 1 drive-in door
- +/- 28 car spaces

ADVANTAGES AND AMENITIES

- Low DuPage County taxes
- Institutionally owned and managed facility

14,092 SF

Industrial Space For Lease

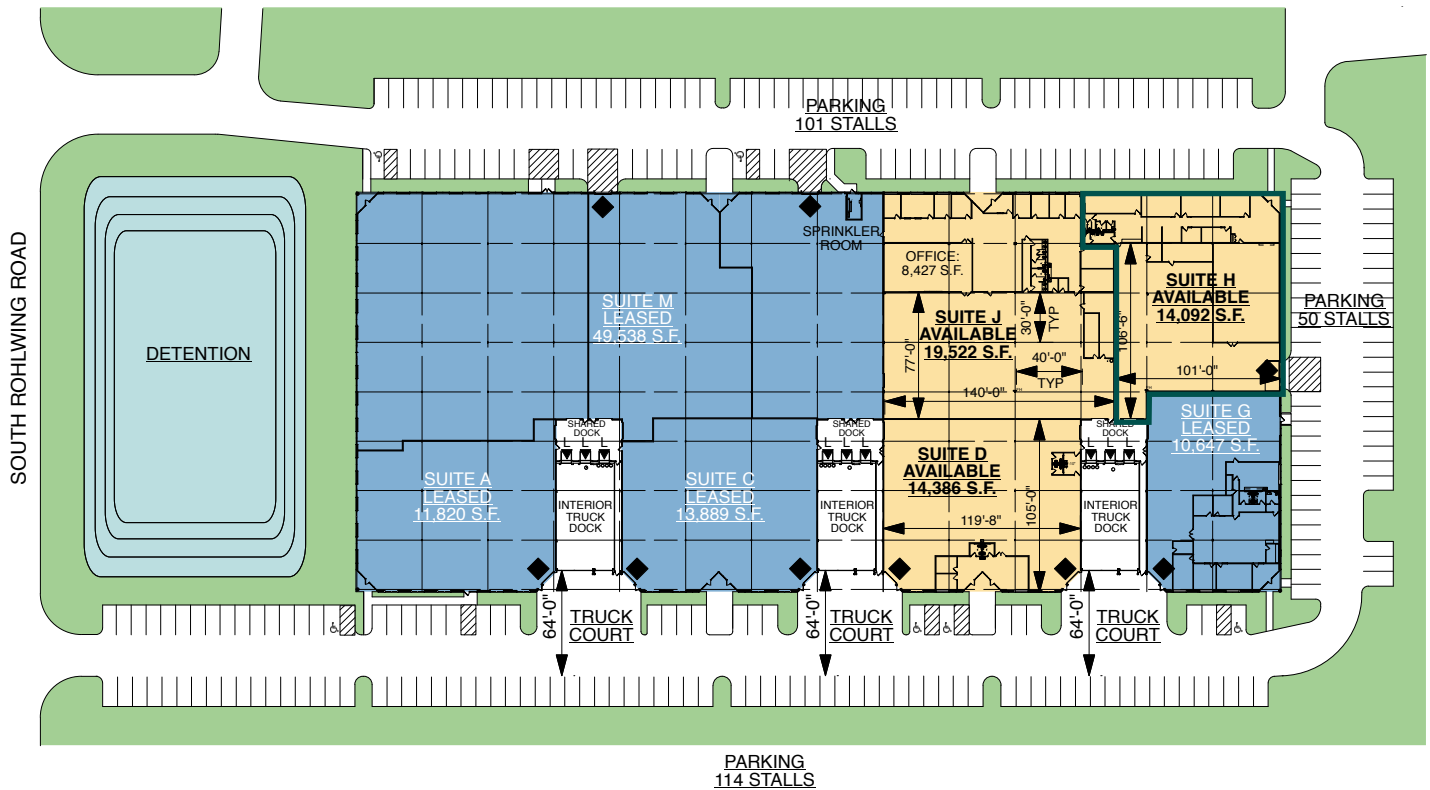

Transwestern

Justin Lerner, SIOR
justin.lerner@transwestern.com
ph +1 847 588 5665
cell +1 847 858 5303
9550 W. Higgins Road
Suite 250
Rosemont, IL 60018 USA

Transwestern

Joe Karmin
joe.karmin@transwestern.com
ph +1 847 588 5670
cell +1 847 287 4567
9550 W. Higgins Road
Suite 250
Rosemont, IL 60018 USA

Transwestern

Ross Lehrman
ross.lehrman@transwestern.com
ph +1 847 588 5671
cell +1 847 946 4602
9550 W. Higgins Road
Suite 250
Rosemont, IL 60018 USA

Prologis

Matthew Mannina
mmannina@prologis.com
ph +1 847 292 3939
cell +1 847 791 3827
6250 N. River Road
Suite 1100
Rosemont, IL 60018 USA