

29,228 SF

Industrial Space For Lease



Prologis Beacon Centre 21

1935 NW 87th Avenue
Doral, FL 33126 USA



LOCATION

- Easy access to Miami International Airport and Port Miami
- Direct access to 836 (Dolphin Expressway), with easy access to 826 (Palmetto Expressway), and Florida's Turnpike
- Direct exposure to NW 87th Avenue

FACILITY

- ±29,228 SF available; inclusive of ±2,886 SF of office
- 24' Clear height
- 8 Truck Positions inclusive of 1 double-wide door with a concrete ramp
- Column spacing 40' X 30' / Building depth 157'-8"
- Rear loading
- Parking ratio 2:1,000
- Shared truck court
- Available July 2021
- [Click here to learn more](#)

ADVANTAGES AND AMENITIES

- Beacon Centre is a 205 acre secured master-planned business park located in the heart of the Airport West /Doral submarket.
- Nearby amenities include numerous restaurants, hotels, banks and shopping centers.
- Fast, cost-effective forklift and racking sourcing through Prologis Essentials.

29,228 SF

Industrial Space For Lease

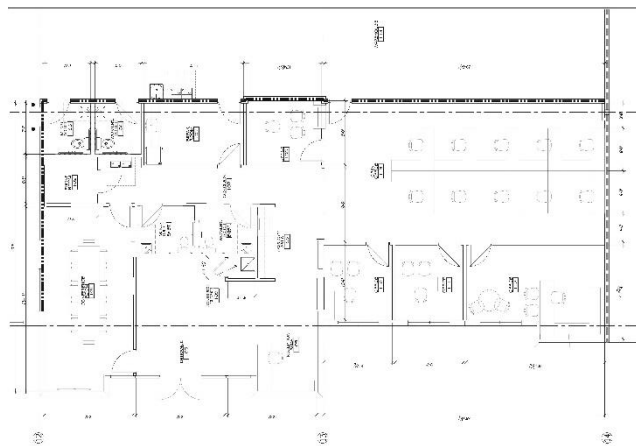
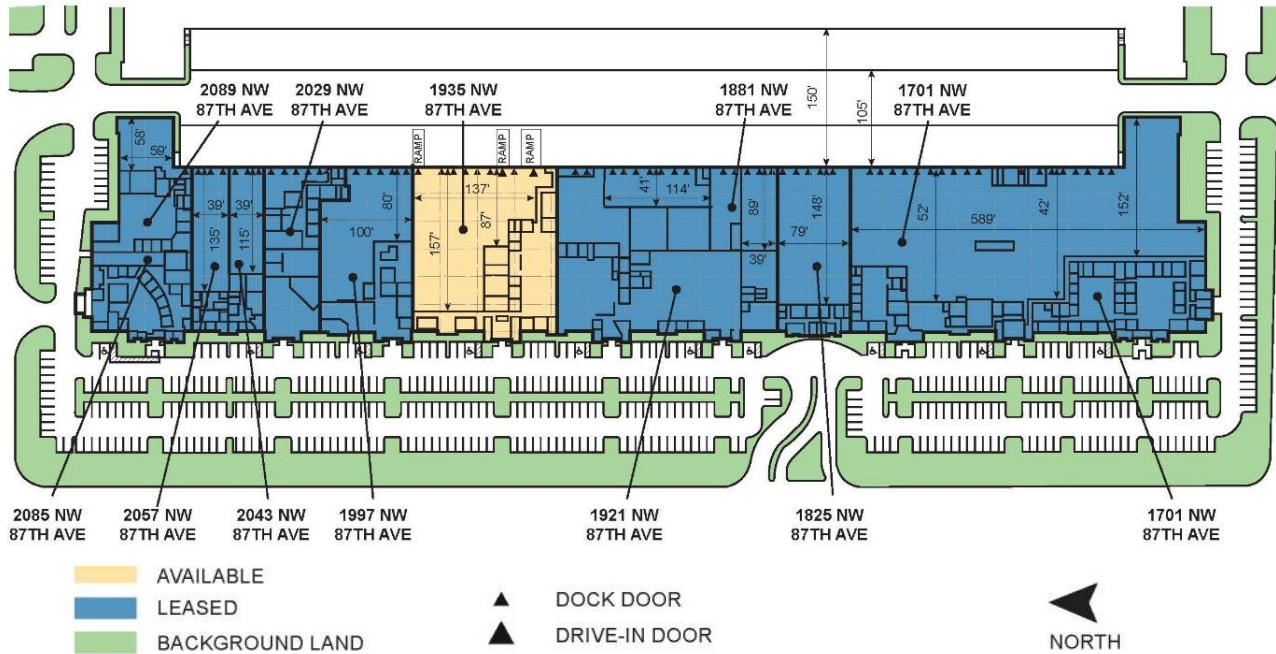

State Street Realty

George Pino, SIOR, RPA
gpino@statestreetre.com
ph +1 305 447 3390
cell +1 786 402 7387
8319 NW 12 Street
Doral, FL 33126 USA

State Street Realty

Brian Cabielles
bcabielles@statestreetre.com
ph +1 305 447 3390
cell +1 305 606 7109
8319 NW 12 Street
Doral, FL 33126 USA

Prologis

Adriana Duque
aduque@prologis.com
ph +1 305 392 4272
8355 NW 12 Street
Doral, FL 33126 USA