

# 62,004 SF (Divisible)

Industrial Space For Lease



## Prologis Chicago

2059 – 2061 W Hastings Street  
Chicago, IL 60608 USA

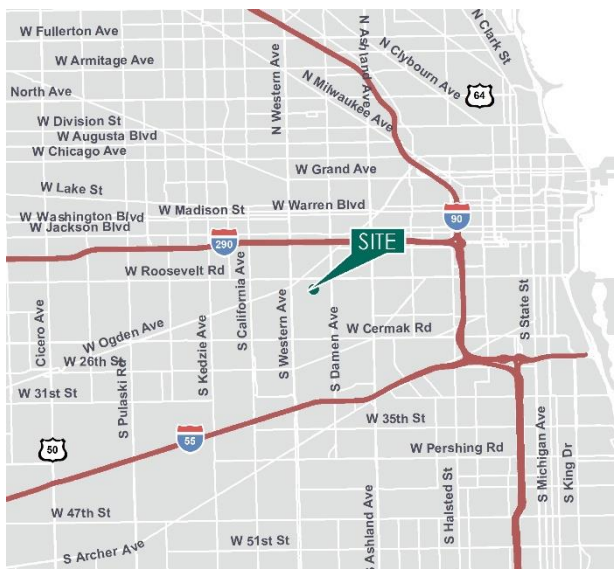

### LOCATION

- Excellent location in the Illinois Medical District
- 3.0 miles to the Central Business District and 3.9 miles to The Loop
- Easy access to I-90, I-290 and I-55

### FACILITY

- 62,004 SF available (divisible)
- 1,284 SF office space (expandable)
- 22' clear height
- 4 exterior docks
- 2 drive-in doors
- 35' x 31' column spacing
- Power: 800 amps @ 120/208 and 277/480 volts
- 45 car parking stalls
- Partially air conditioned

### ADVANTAGES AND AMENITIES

- Convenient access via public transportation
- Deep labor pool
- Zoned PD 30
- Located in the 28<sup>th</sup> Ward (Alderman Jason Ervin)

# 62,004 SF (Divisible)

Industrial Space For Lease

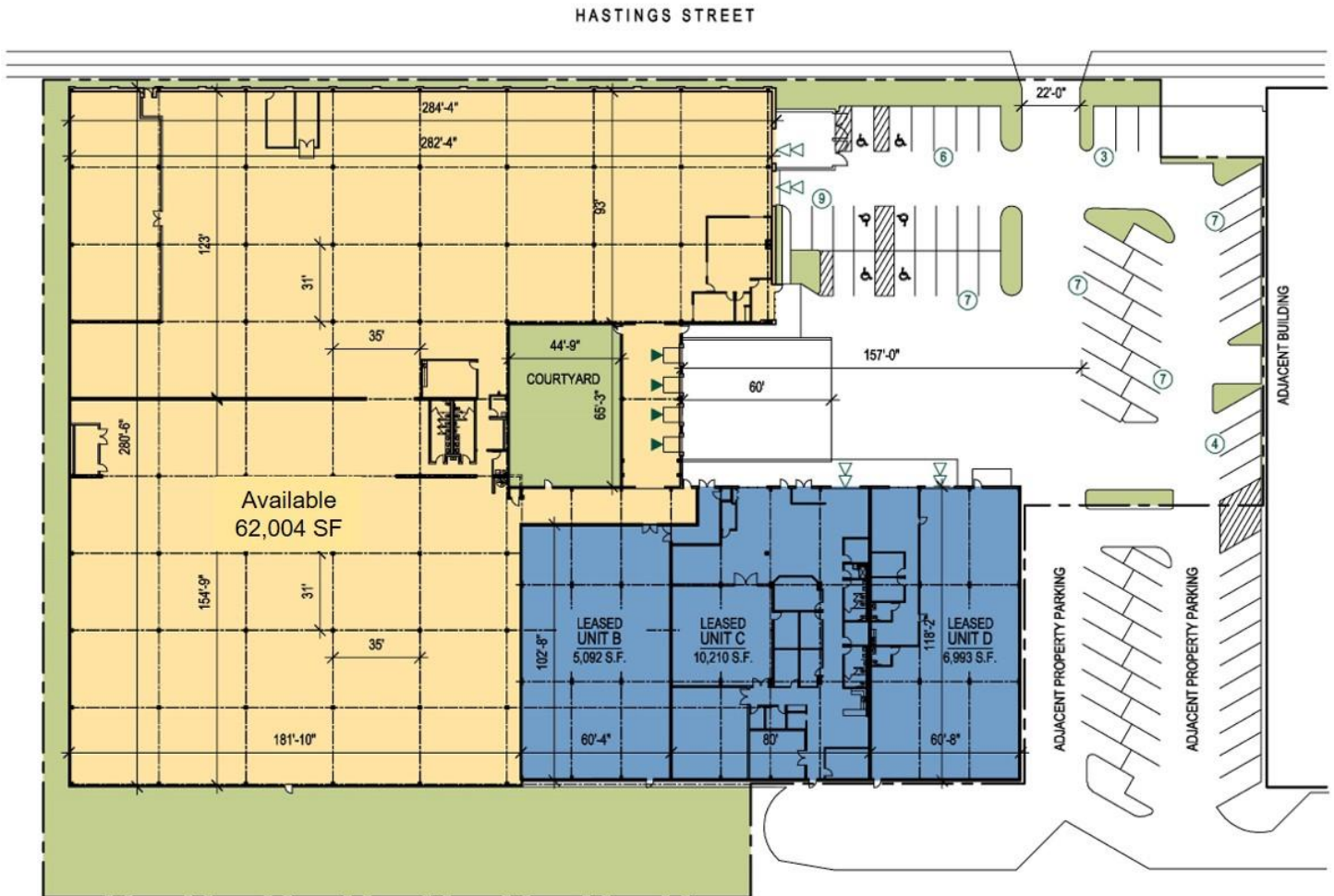

**Cushman & Wakefield**  
Larry Goldwasser, SIOR  
[Larry.goldwasser@cushwake.com](mailto:Larry.goldwasser@cushwake.com)  
ph +1 312 470 2323  
cell +1 312 953 5744  
225 W Wacker Drive  
Suite 3000  
Chicago, IL 60606 USA

**Cushman & Wakefield**  
Colin Green  
[Colin.green@cushwake.com](mailto:Colin.green@cushwake.com)  
ph +1 312 470 2322  
cell +1 630 272 9968  
225 W Wacker Drive  
Suite 3000  
Chicago, IL 60606 USA

**Cushman & Wakefield**  
Matt Cowie  
[Matt.cowie@cushwake.com](mailto:Matt.cowie@cushwake.com)  
ph +1 312 470 1872  
cell +1 312 735 6510  
225 W Wacker Drive  
Suite 3000  
Chicago, IL 60606 USA

**Prologis**  
Sean Olvany  
[solvany@prologis.com](mailto:solvany@prologis.com)  
ph +1 847 292 3936  
cell +1 847 224 6254  
6250 N River Road  
Suite 1100  
Rosemont, IL 60018 USA

# 62,004 SF (Divisible)

Industrial Space For Lease

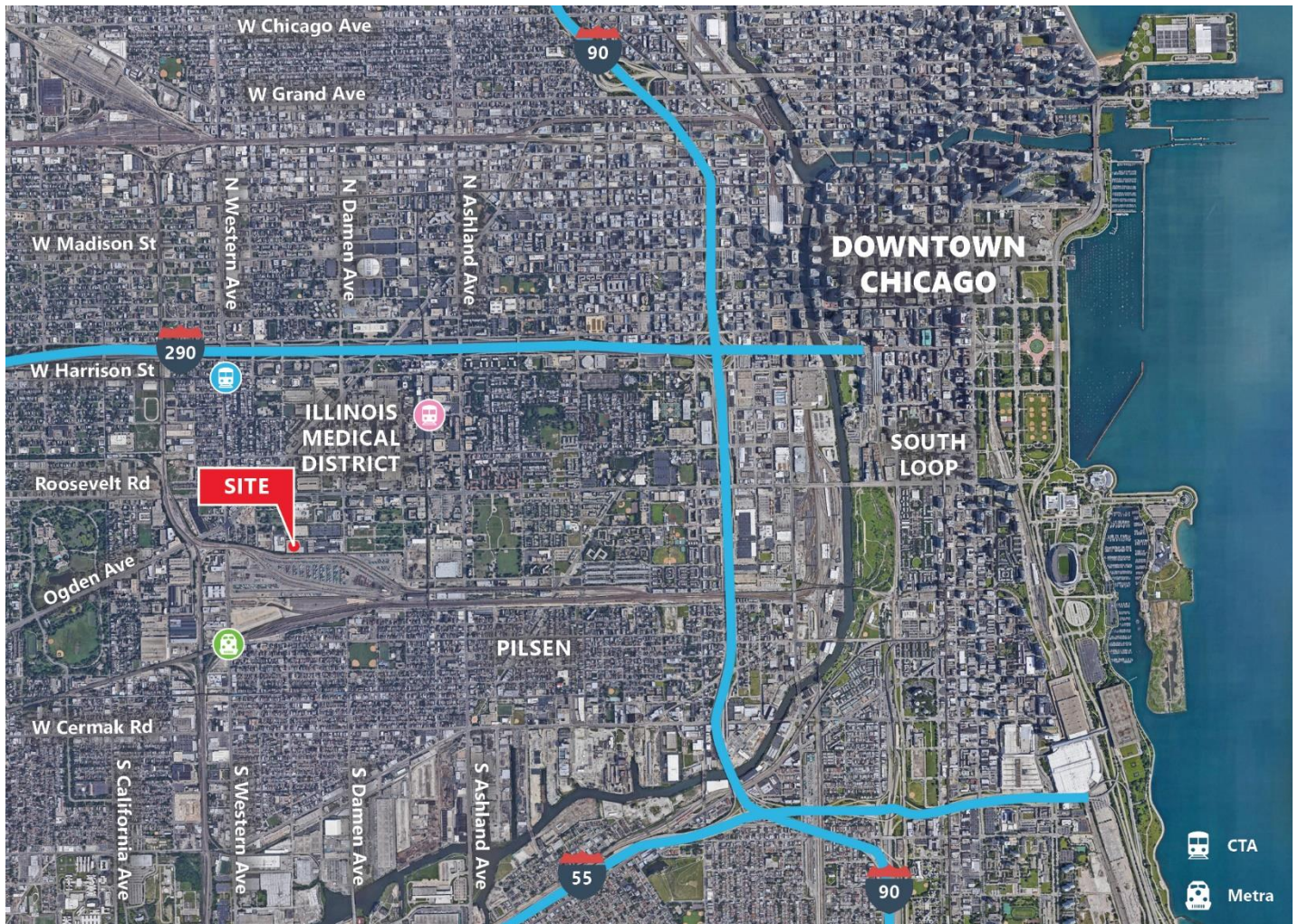

## DRIVE TIMES

12 minutes to Chicago Loop

3 minutes to I-290

10 minutes to I-90

13 minutes to I-55



### Cushman & Wakefield

Larry Goldwasser, SIOR

[Larry.goldwasser@cushwake.com](mailto:Larry.goldwasser@cushwake.com)

ph +1 312 470 2323

cell +1 312 953 5744

225 W Wacker Drive

Suite 3000

Chicago, IL 60606 USA

### Cushman & Wakefield

Colin Green

[Colin.green@cushwake.com](mailto:Colin.green@cushwake.com)

ph +1 312 470 2322

cell +1 630 272 9968

225 W Wacker Drive

Suite 3000

Chicago, IL 60606 USA

### Cushman & Wakefield

Matt Cowie

[Matt.cowie@cushwake.com](mailto:Matt.cowie@cushwake.com)

ph +1 312 470 1872

cell +1 312 735 6510

225 W Wacker Drive

Suite 3000

Chicago, IL 60606 USA

### Prologis

Sean Olvany

[solvany@prologis.com](mailto:solvany@prologis.com)

ph +1 847 292 3936

cell +1 847 224 6254

6250 N River Road

Suite 1100

Rosemont, IL 60018 USA