

863,860 SF

Industrial Space For Lease



Prologis Chambersburg



1475 Nitterhouse Drive
Chambersburg, PA 17201 USA

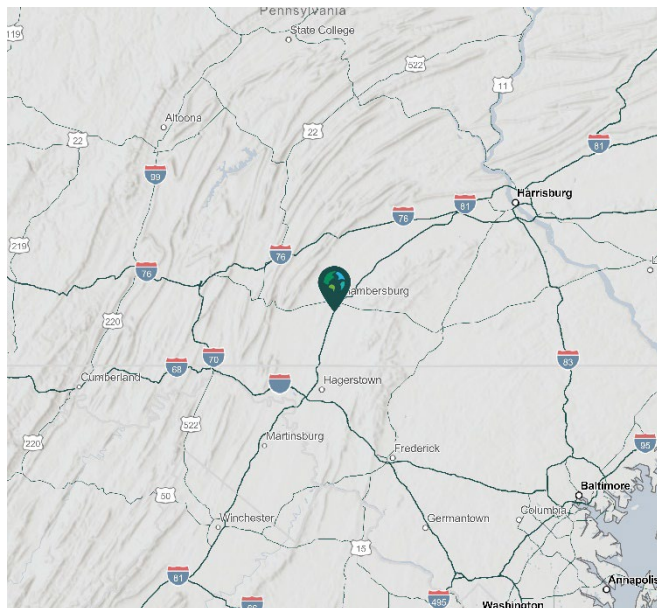

LOCATION

- 1 mile from Interchange 14 of Interstate 81
- Proximity to FedEx (24 miles), UPS (32 miles) and CSX (1 mile)

FACILITY

- 863,860 sf building
- 50.21 acres
- 480' x 1803' building dimensions
- Built in 2001
- 17,338 sf of office space
- 30' clear height
- 89 loading doors
- 2 drive-in doors
- 13 rail doors
- ESFR fire protection system
- 346 car parks
- 324 trailer parks
- 164' 5" truck court with 55' concrete apron

ADVANTAGES AND AMENITIES

- Access to 40% of the US population within a one-day drive
- 225,333 people within 30 minutes
- Rail capable (CSX)

Prologis Essentials: your single-source service for efficient move-in and operations at prologisessentials.com

www.prologis.com

863,860 SF

Industrial Space For Lease



Prologis Chambersburg

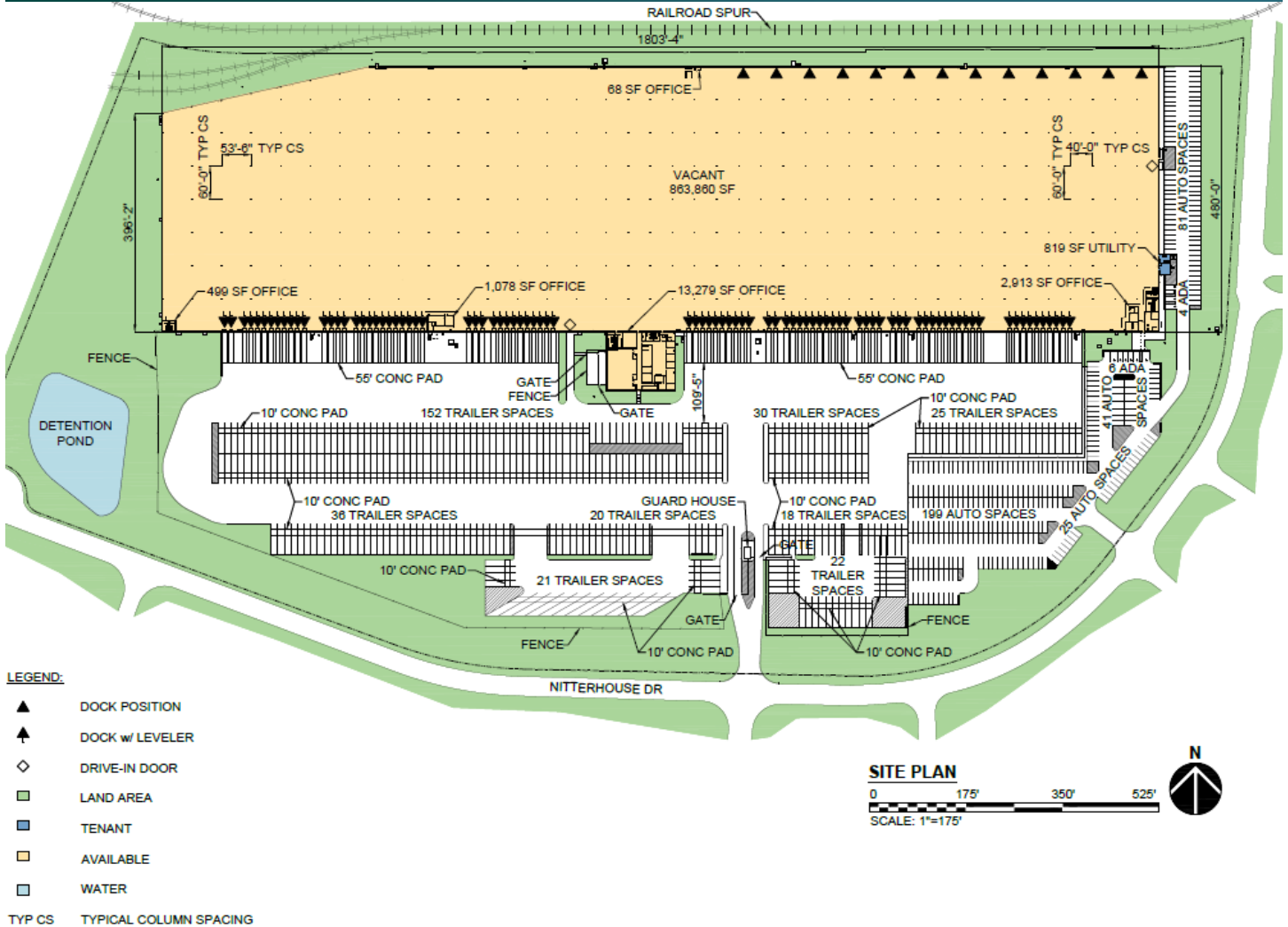

Jones Lang LaSalle

W. Jason Webb
Jason.webb@am.jll.com
ph +1 717 791 2207
cell +1 717 329 0881
4999 Louise Drive
Suite 202
Mechanicsburg, PA 17055 USA

Jones Land LaSalle

Maria Ratzlaff
maria.Ratzlaff@am.jll.com
ph +1 717 791 2210
cell +1 717 421 0006
4999 Louise Drive
Suite 202
Mechanicsburg, PA 17055 USA

Prologis

Jessica Goffredo Pantaleo
jgoffredopantaleo@prologis.com
ph +1 610 997 6654
cell +1 610 509 5592
400 Boulder Drive
Suite 200
Breinigsville, PA 18031 USA

Prologis Essentials: your single-source service for efficient move-in and operations at prologisessentials.com

No warranty or representation, expressed or implied, is made as to the accuracy of the information contained herein, and same is submitted subject to error and omissions.