

# 175,660 SF

Industrial Space For Lease



## Prologis Van Nuys Distribution Center



7855 Hayvenhurst Avenue  
Van Nuys, CA 91406 USA

### LOCATION

- Adjacent to the West of the Van Nuys Airport
- Easy Accessibility to 405, 118 & 101 Freeways
- Near Regional Post Office and UPS & FEDEX Terminal

### FACILITY

- 175,660 SF Available
- 10,740 SF Ground Floor Office
- 6,600 SF Mezzanine Office
- 28' Clear Height
- 16 Dock High Doors
- 2 Ground Level Doors
- ESRF Sprinkler System
- 2,500 Amps, 277/480 Volts Electrical Power
- 330 Parking Spaces

### ADVANTAGES AND AMENITIES

- Access to the Prologis Essentials platform, which includes:
  - [Operations Essentials](#)
  - [Energy Essentials](#)
  - [Workforce Essentials](#)
  - [Mobility Essentials](#)
  - [Digital Essentials](#)

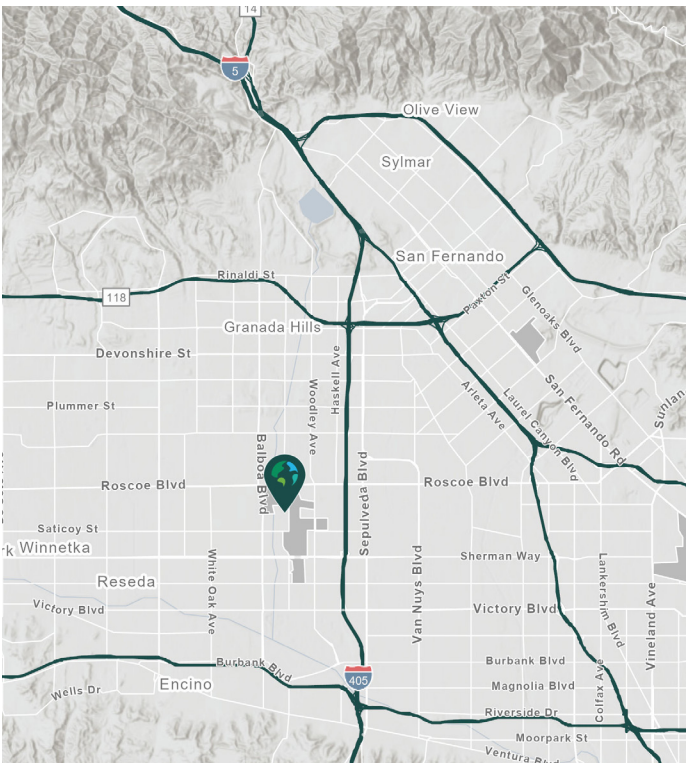

**Your single-source service for efficient move-in and operations: [prologisessentials.com](https://www.prologisessentials.com)**

# 175,660 SF

Industrial Space For Lease



## Prologis Van Nuys Distribution Center

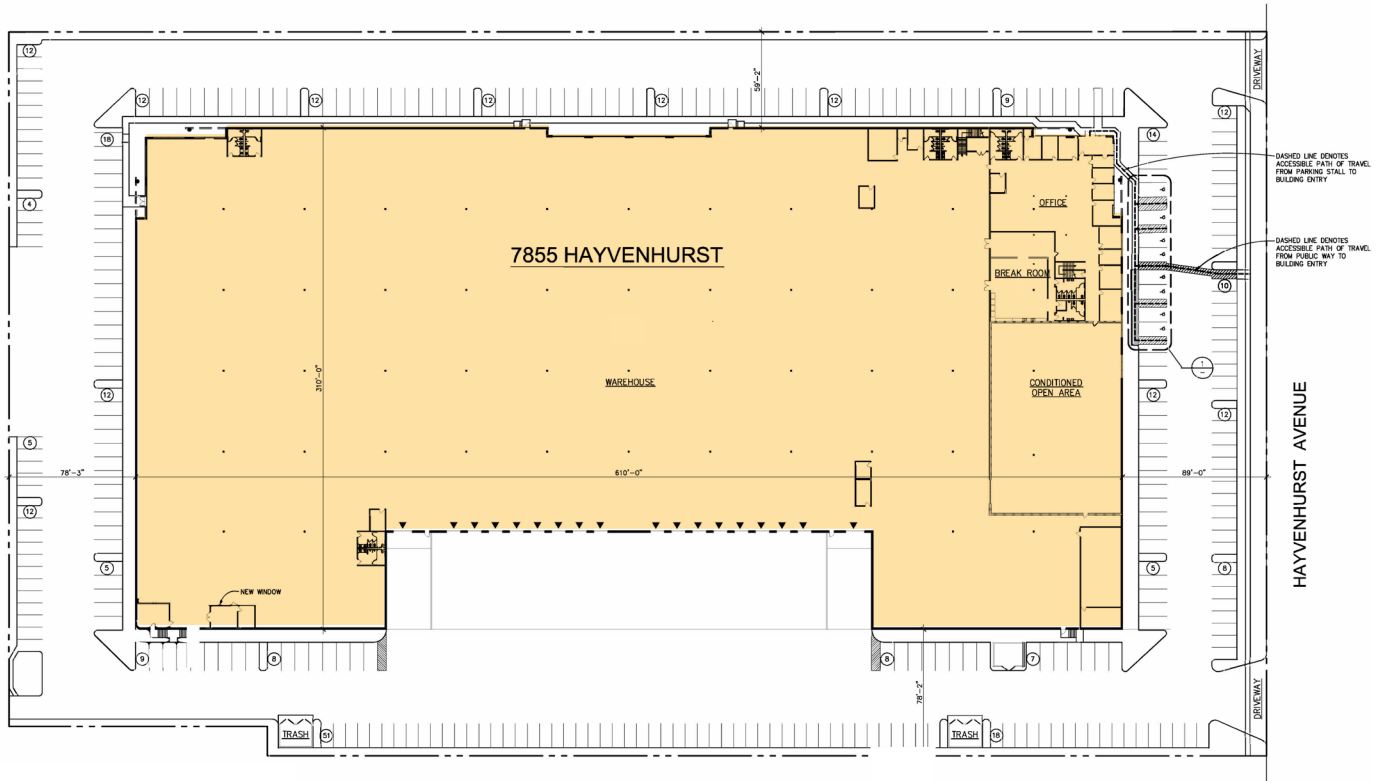

<b>OFFICE</b>	<b>10,740 S.F.</b>
<b>WAREHOUSE</b>	<b>158,320 S.F.</b>
<b>OFFICE MEZZANINE</b>	<b>6,660 S.F.</b>
<b>TOTAL BUILDING</b>	<b>175,660 S.F.</b>



### Bennett Robinson

Vice Chairman  
CalDRE License #00984312  
bennett.robinson@cbre.com  
ph +1 818 907 4608  
cell +1 818 458 7853  
5921 Owensmouth Avenue  
Woodland Hills, CA 91367 USA



### Erin Mergenthaler

Leasing Manager  
CalDRE License #01930776  
emergenthaler@prologis.com  
ph +1 310 338 3264  
2141 Rosecrans Avenue  
Suite 1151  
El Segundo, CA 90245 USA