

# 448,512 SF

## Industrial Space For Lease



## Prologis Park Bolingbrook

581 Territorial Drive  
Bolingbrook, IL 60440 USA

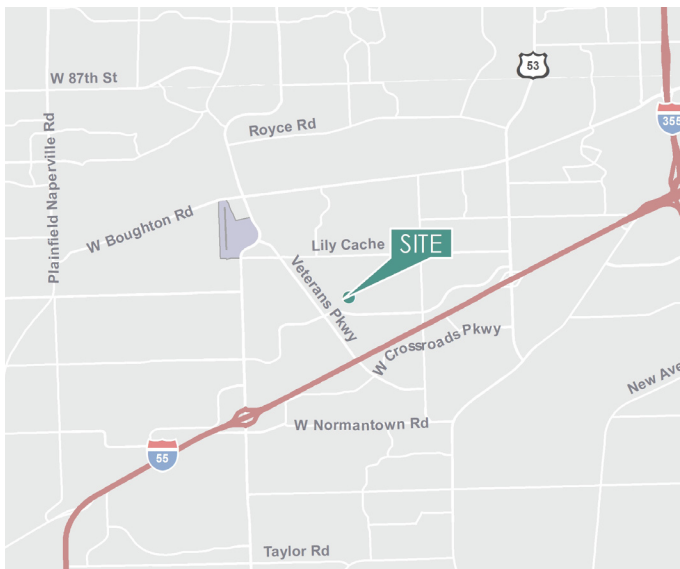

### LOCATION

- Easy access to I-55 via Weber Road and Veterans Parkway
- Close proximity to I-355

### FACILITY

- 448,512 sf facility available (divisible)
- 12,704 sf office 1 | 3,266 sf office 2
- 30' clear height
- 40' x 48' bay size
- 72 exterior docks
- 4 drive-in doors
- 426 auto parking
- 2,000 amps @ 277/480 volt
- Up to 103 trailer parking stalls

### ADVANTAGES AND AMENITIES

- Will County taxes
- Efficient access to metropolitan Chicago, Wisconsin and Indiana
- On-site trailer parking
- Secured truck court

# 448,512 SF

## Industrial Space For Lease

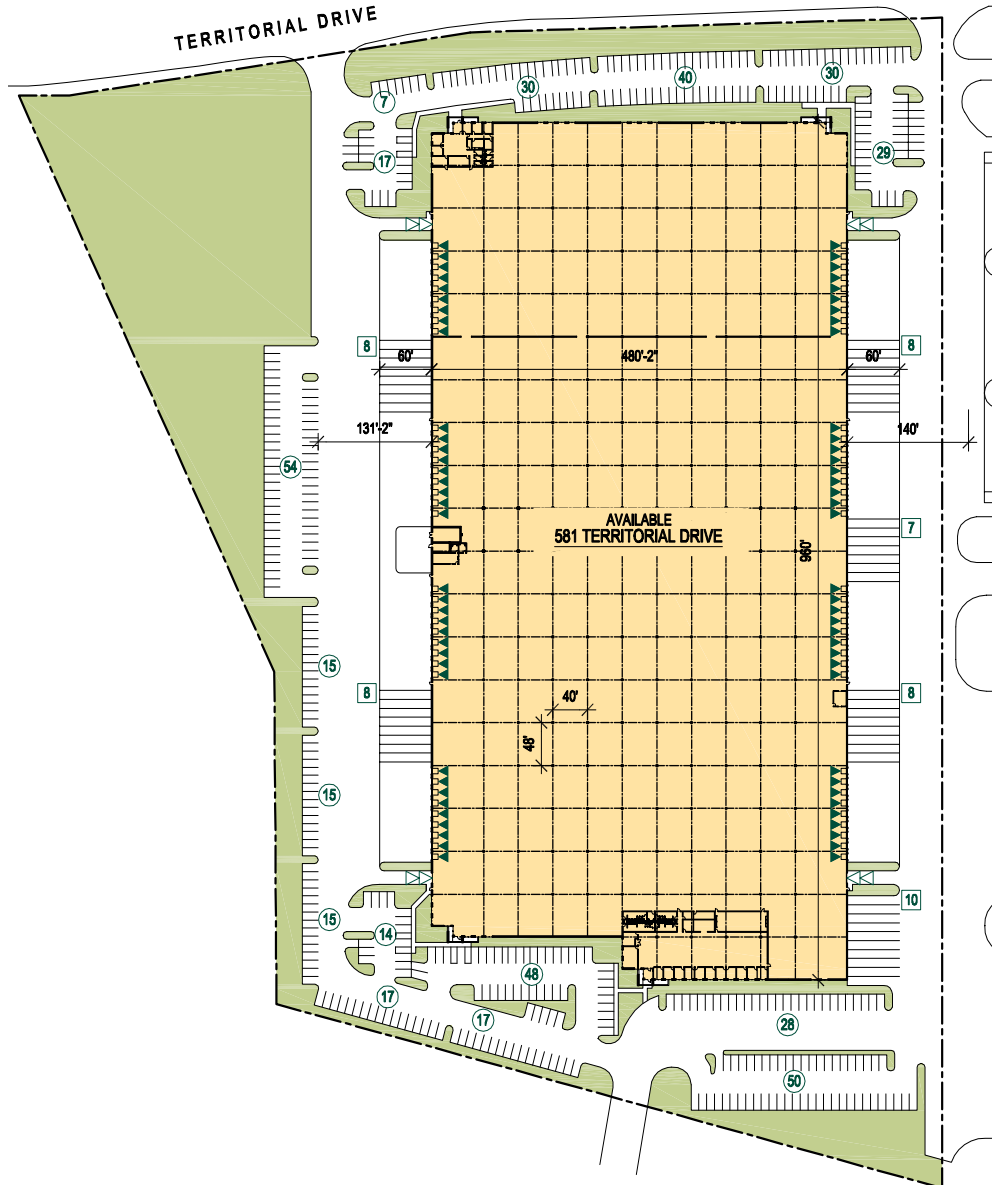

### Cushman & Wakefield

**Britt Casey**

britt.casey@cushwake.com

ph +1 847 518 3280

cell +1 847 456 7545

9500 W. Bryn Mawr Avenue  
Suite 600

Rosemont, IL 60018 USA

### Cushman & Wakefield

**Jason West**

jason.west@cushwake.com

ph +1 847 518 3210

cell +1 630 363 4395

9500 W. Bryn Mawr Avenue  
Suite 600

Rosemont, IL 60018 USA

### Cushman & Wakefield

**Jeff Matella**

jeff.matella@cushwake.com

ph +1 847 720 1349

cell +1 847 997 2878

9500 W. Bryn Mawr Avenue  
Suite 600

Rosemont, IL 60018 USA

### Prologis

**Jim Neswold**

jneswold@prologis.com

ph +1 847 292 3924

cell +1 847 571 0592

6250 N. River Road  
Suite 1100

Rosemont, IL 60018 USA

# 448,512 SF

## Industrial Space For Lease



### Additional Trailer Parking Site Plan

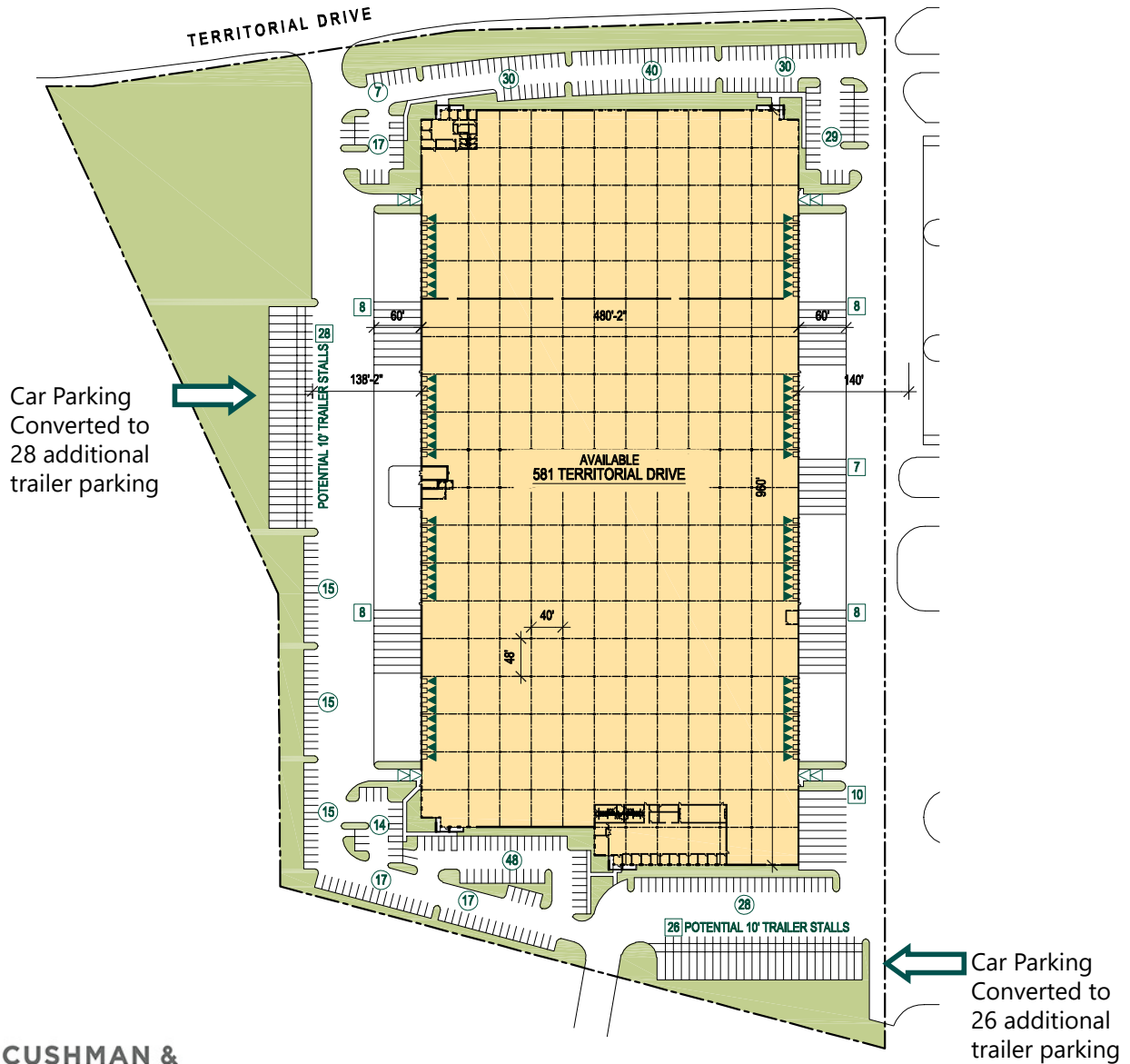

**Cushman & Wakefield**  
**Britt Casey**  
britt.casey@cushwake.com  
ph +1 847 518 3280  
cell +1 847 456 7545  
9500 W. Bryn Mawr Avenue  
Suite 600  
Rosemont, IL 60018 USA

**Cushman & Wakefield**  
**Jason West**  
jason.west@cushwake.com  
ph +1 847 518 3210  
cell +1 630 363 4395  
9500 W. Bryn Mawr Avenue  
Suite 600  
Rosemont, IL 60018 USA

**Cushman & Wakefield**  
**Jeff Matella**  
jeff.matella@cushwake.com  
ph +1 847 720 1349  
cell +1 847 997 2878  
9500 W. Bryn Mawr Avenue  
Suite 600  
Rosemont, IL 60018 USA

**Prologis**  
**Jim Neswold**  
jneswold@prologis.com  
ph +1 847 292 3924  
cell +1 847 571 0592  
6250 N. River Road  
Suite 1100  
Rosemont, IL 60018 USA