

8,700 SF

Industrial Space For Lease



Prologis Dorsey Distribution Center



7111 Dorsey Run Road
Elkridge, MD 21075 USA

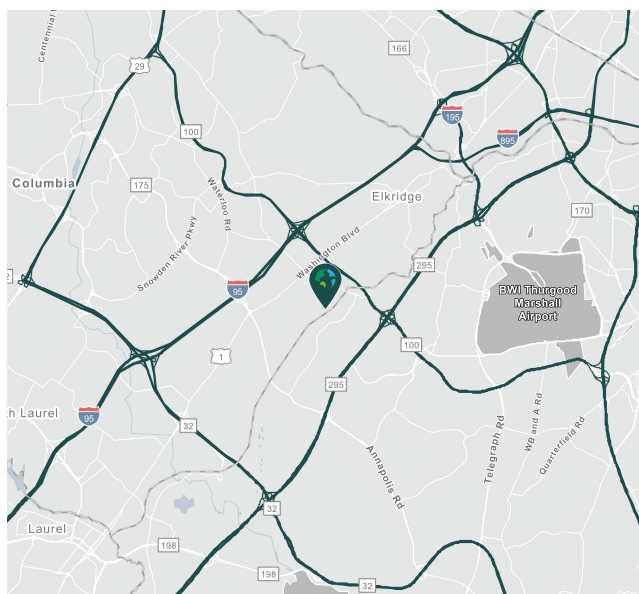

LOCATION

- Immediate access to I-95, Route 1, and Route 100
- Ease of multimarket accessibility, 7111 Dorsey Run Road is equidistant between Washington D.C. and Baltimore
- Heart of the Baltimore/Washington Corridor with efficient travel times to BWI Thurgood Marshall Airport

FACILITY

- 8,700 SF available
- 973 SF office space
- 24' clear height
- 3 dock doors; 1 drive-in
- 50' x 48' column spacing
- 200 amps, 277/480 electric service
- M-2 zoning
- LED lighting

ADVANTAGES AND AMENITIES

- Prologis Clear Lease® – Know your lease expenses and capital costs with greater certainty before you sign
- Fast, cost-effective forklift and racking sourcing through Prologis Essentials

Prologis Essentials: your single-source service for efficient move-in and operations at [prologisessentials.com](https://www.prologisessentials.com)

www.prologis.com

8,700 SF

Industrial Space For Lease



Prologis Dorsey Distribution Center

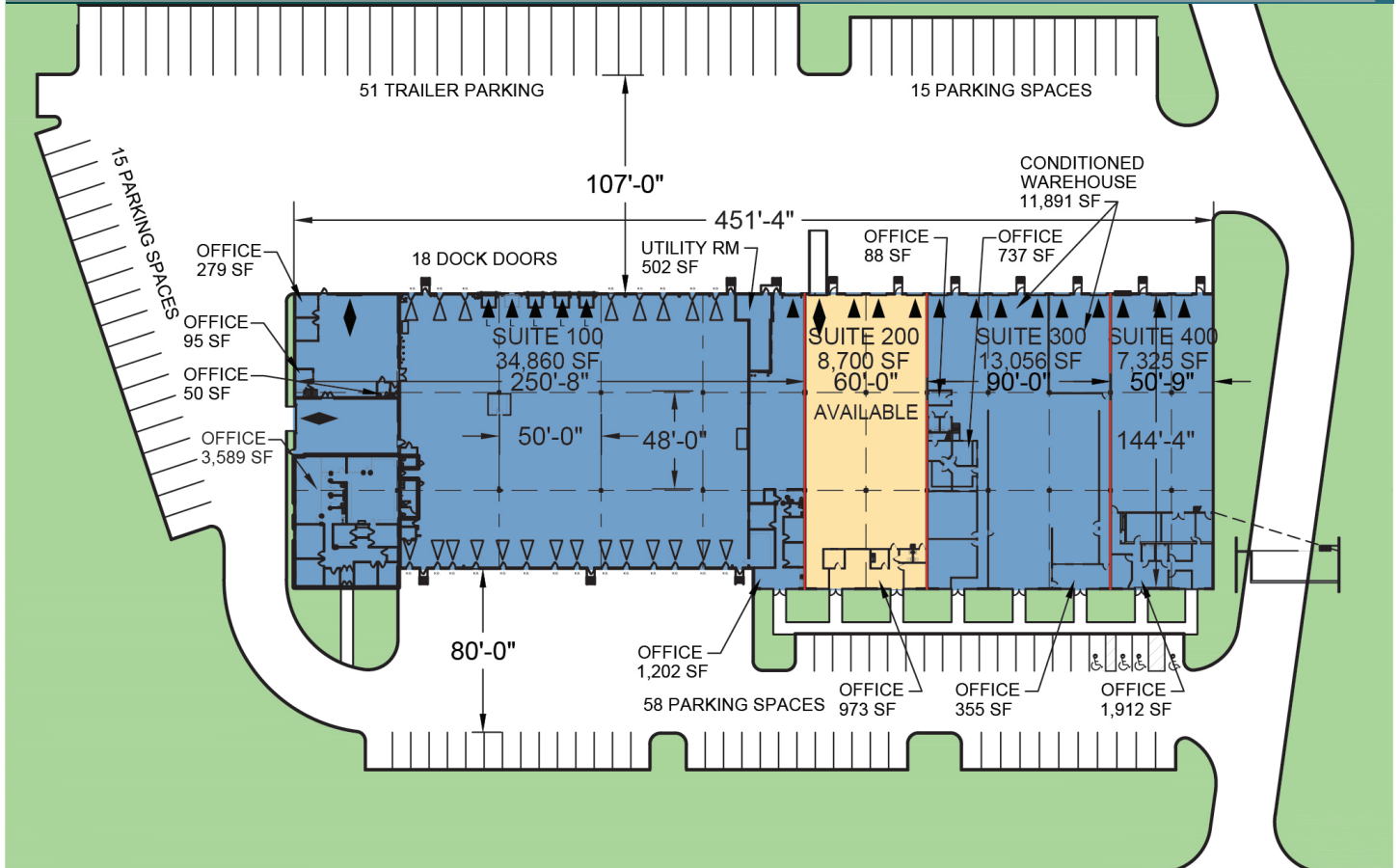

LEGEND:

- ▲ DOCK POSITION
- ▲ DOCK POSITION W/ LEVELER
- ◆ DRIVE-IN DOOR
- LAND
- LEASED AREA
- AVAILABLE AREA

NEWMARK

Newmark

Brian Kruger
brian.kruger@nmrk.com
ph +1 410 625 4211
1 E. Pratt Street
Suite 805
Baltimore, MD 21202 USA

Newmark

Thomas Hinder
thomas.hinder@nmrk.com
ph +1 410 844 4010
1 E. Pratt Street
Suite 805
Baltimore, MD 21202 USA

Newmark

Erik Evans
erik.evans@nmrk.com
ph +1 410 844 4003
1 E. Pratt Street
Suite 805
Baltimore, MD 21202 USA

Prologis

Karen Cherry
kcherry@prologis.com
ph +1 410 872 4560
6721 Columbia Gateway Drive
Suite 150
Columbia, MD 20146 USA

Prologis Essentials: your single-source service for efficient move-in and operations at prologisessentials.com

No warranty or representation, expressed or implied, is made as to the accuracy of the information contained herein, and same is submitted subject to error and omissions.