

166,826 SF

Industrial Space for Lease



Prologis Park Tracy 2

2795 Paradise Avenue, #140 | Tracy, CA 95304 USA



FACILITY

- ±532,500 Total SF building
- ±166,826 Available SF
- 300' x 550' space dimensions
- 32' clear height
- 50' x 50' column spacing
- ±4,386 SF office
- 50' speed bays
- ±7,810 SF cold storage area
- 32 dock high doors
- 1 grade level door
- 45 trailer parking stalls
- 91 auto parking stalls
- 1,200 amps of power
- ESFR fire sprinkler system
- New LED lighting
- Exclusive 42'-wide
- Drive Asile

DOCK SPECIFICATIONS

- Seven (7) 35k lbs. Kelley pit levelers
- Twenty-seven (27) Kelley dock seals
- Twenty-five (25) Kelley edge of dock levelers

LOCATION

- Easy access to I-205, I-5, I-580 and Highways 120 and 99
- Located only 65 miles east of San Francisco and 54 miles east of the Port of Oakland

ADVANTAGES AND AMENITIES

- Close proximity to BNSF & Union Pacific Intermodal facilities
- Corporate neighbors include Crate & Barrel, US Foods, and Amazon
- Access to the Prologis Essentials platform, which includes:
 - [Operations Essentials](#)
 - [Energy Essentials](#)
 - [Workforce Essentials](#)
 - [Mobility Essentials](#)
 - [Digital Essentials](#)

Your single-source service for efficient move-in and operations: prologisessentials.com

166,826 SF

Industrial Space for Lease



Prologis Park Tracy 2

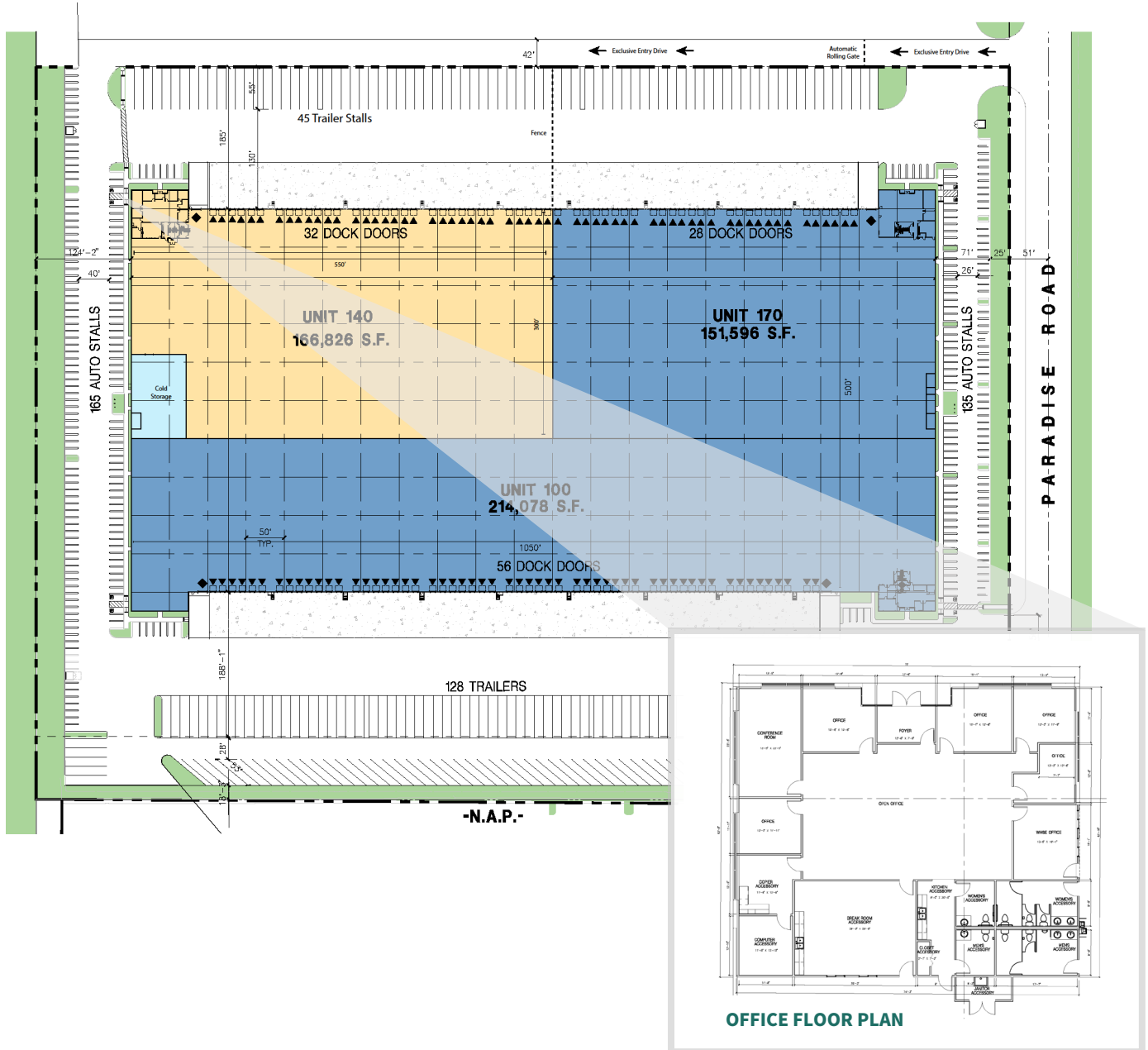

Cushman & Wakefield

Tyson Vallenari, SIOR
Executive Managing Director
Lic #01480887
tyson.vallenari@cushwake.com
ph +1 510 919 2328
3255 W March Lane, Ste. 230
Stockton, CA 95219 USA

Cushman & Wakefield

Kevin Dal Porto
Executive Managing Director
Lic #01212936
kevin.dalporto@cushwake.com
ph +1 209 601 2476
3255 W March Lane, Ste. 230
Stockton, CA 95219 USA

Cushman & Wakefield

Blake Rasmussen
Executive Managing Director
Lic #01010250
blake.rasmussen@cushwake.com
ph +1 209 481 7044
3255 W March Lane, Ste. 230
Stockton, CA 95219 USA

Prologis

Matt Drury
Vice President Market Officer
Lic #01901364
mdrury@prologis.com
ph +1 415 418 4485
615 International Pkwy
Tracy, CA 95377 USA

Prologis

Claire Wilson
Leasing Associate
Lic #01982067
cwilson2@prologis.com
ph +1 209 833 5395
615 International Pkwy
Tracy, CA 95377 USA