

4,038 SF

Industrial Space For Lease



Prologis Schiller Park



5118 Pearl Street
Schiller Park, IL 60176 USA

LOCATION

- Conveniently located next to O'Hare International Airport.
- Excellent access to I-294, I-90, I-290 and I-390.

FACILITY

- 25,159 sf building
- 4,038 sf available
- 1,043 sf office area
- 14' clear height
- 1 drive-in door (12' x 12')
- A/C in warehouse
- Power: 400 amp, 240/120 volts, 4 wire

ADVANTAGES AND AMENITIES

- Well maintained space
- Walking distance to Rosemont's Entertainment District

Your single-source service for efficient move-in and operations: prologisessentials.com



4,038 SF

Industrial Space For Lease



Prologis Schiller Park

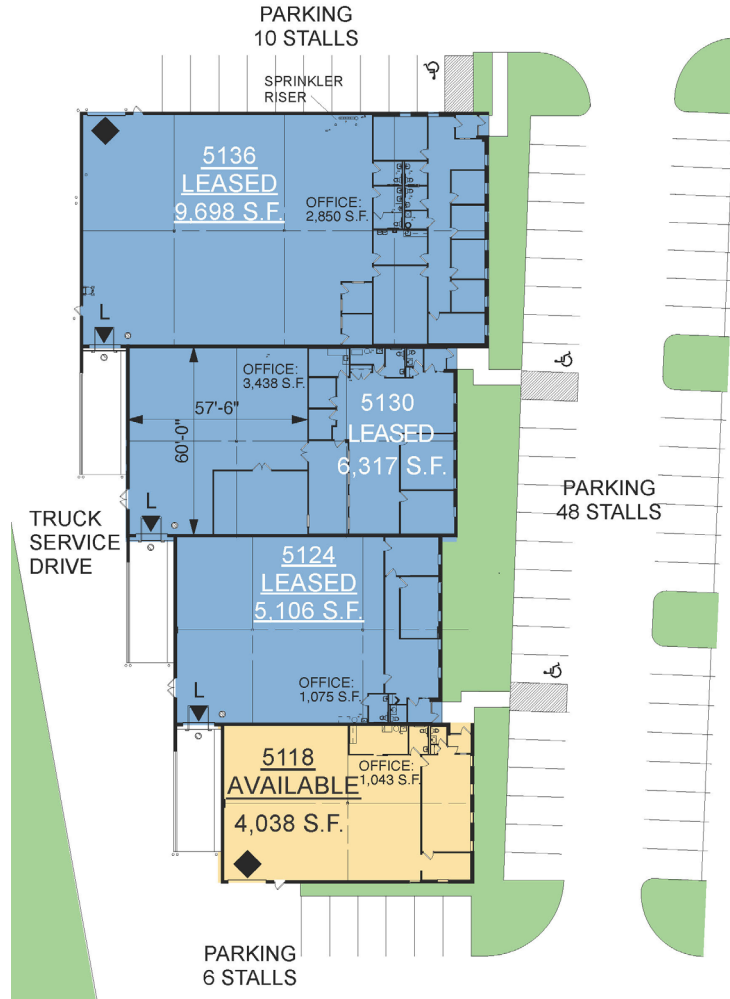

NEWMARK

Broker

Tom Gath
thomas.gath@nrmk.com
ph +1 773 957 1415
cell +1 847 942 9438
8750 W. Bryn Mawr
Suite 350
Chicago, IL 60631 USA

Prologis

Brian Czarnecki
bczarnecki@prologis.com
ph +1 847 292 3852
cell +1 203 979 1233
6250 North River Road
Suite 1100
Rosemont, IL 60018 USA